

CITY OF CHICAGO
APPLICATION FOR AN AMENDMENT TO
THE CHICAGO ZONING ORDINANCE

1. ADDRESS of the property Applicant is seeking to rezone:
2828 N. Clark St., Chicago, IL

2. Ward Number that property is located in: 44

3. APPLICANT: BAI Century, LLC

ADDRESS: 720 E. Palisade Ave., Ste. 201 CITY: Englewood Cliffs

STATE: New Jersey ZIP CODE: 07632 PHONE: 312-782-1983

EMAIL: nick@sambankslaw.com CONTACT PERSON: Nicholas J. Ftikas

4. Is the Applicant the owner of the property? YES NO

If the Applicant is not the owner of the property, please provide the following information regarding the owner and attach written authorization from the owner allowing the application to proceed.

OWNER: _____

ADDRESS: _____ CITY: _____

STATE: _____ ZIP CODE: _____ PHONE: _____

EMAIL: _____ CONTACT PERSON: _____

5. If the Applicant/Owner of the property has obtained a lawyer as their representative for the rezoning, please provide the following information:

ATTORNEY: Law Offices of Samuel V.P. Banks, Nicholas Ftikas

ADDRESS: 221 N. LaSalle St., 38th Floor

CITY: Chicago STATE: Illinois ZIP CODE: 60601

PHONE: (312) 782-1983 FAX: 312-782-2433 EMAIL: nick@sambankslaw.com

6. If the Applicant is a legal entity (Corporation, LLC, Partnership, etc.), please provide the names of all owners as disclosed on the Economic Disclosure Statements.
Amit Barnoon and Eyal Lev Ari, Managers
7. On what date did the owner acquire legal title to the subject property? 2010
8. Has the present owner previously rezoned this property? If Yes, when? The Planned Development was established in 1976, and amended 1976
9. Present Zoning District: PD 139 Proposed Zoning District: PD 139, as Amended
10. Lot size in square feet (or dimensions): 64,652.28 sq. ft. (net site area of existing PD)
11. Current Use of the Property: The subject property is improved with an eight-story multi-tenant retail and commercial office building.
12. Reason for rezoning the property: The Applicant is seeking to amend the Planned Development Statements to expand and otherwise clarify the allowed uses within the Planned Development (Use Statement No. 7, as Amended), including but not limited to the licensing restrictions for the sale of liquor for onsite consumption (Use Statement No. 8, as Amended).
13. Describe the proposed use of the property after the rezoning. Indicate the number of dwelling unit number of parking spaces; approximate square footage of any commercial space; and height of the proposed building. (BE SPECIFIC): The Applicant is seeking to amend the Planned Development Statements to expand and otherwise clarify the allowed uses within the Planned Development (Use Statement No. 7, as Amended), including but not limited to the licensing restrictions for the sale of liquor for onsite consumption (Use Statement No. 8, as Amended). There are no changes or expansions proposed to the existing multi-use retail and commercial office building. The building will remain 96 ft. in height. Onsite parking for 409 cars will continue to be provided. The building will continue to be supported by the four (4) existing loading berths.
14. The Affordable Requirements Ordinance (ARO) requires on-site affordable housing units and/or a financial contribution for residential housing projects with ten or more units that receive a zoning change which, among other triggers, increases the allowable floor area, or, for existing Planned Developments, increases the number of units (see attached fact sheet or visit www.cityofchicago.org/ARO for more information). Is this project subject to the ARO?

YES _____ NO X

ORDINANCE

BE IT ORDAINED BY THE CITY COUNCIL OF THE CITY OF CHICAGO:

SECTION 1. That the Chicago Zoning Ordinance be amended by changing all of the Business Planned Development No. 139 District symbols and indications as shown on Map 7-F in the area bound by:

A line 160 feet south of and parallel to N. Orchard Street; N. Clark Street; a line 438.3 feet south of and parallel to N. Orchard Street; a line 124.5 feet east of and parallel to N. Orchard Street; a line 389.3 feet south of and parallel to N. Orchard Street; a line 113 feet east of and parallel to N. Orchard Street; a line 349.3 feet south of and parallel to N. Orchard Street and N. Orchard Street,

To those of Business Planned Development No. 139, as Amended.

SECTION 2. This Ordinance shall be in force and effect from and after its passage and due publication.

Common Address: 2828 N. Clark Street, Chicago, IL

Business Planned Development No. 139, as Amended

UPDATED PLANNED DEVELOPMENT STATEMENTS

1. The area delineated herein as Planned Development Number 139, as Amended (“Planned Development”), is owned and controlled by the Applicant, BAI Century, LLC.
2. Off-street parking facilities shall be provided in compliance with this Plan of Development, and in compliance with use and bulk regulations, Article 8.11 of the Chicago Zoning Ordinance subject to the review of the Department of Streets and Sanitation and the approval of the Department of Development and Planning.
3. Off-street loading facilities shall be provided in compliance with this Plan of Development, and in compliance with the use and bulk regulations, Article 8.10-5 of the Chicago Zoning Ordinance subject to the review of the Department of Streets and Sanitation and the approval of the Department of Development and Planning.
4. All applicable official reviews, approvals or permits are required to be obtained by the Applicant, or its Successors, Assignees or Grantees.
5. Any dedication or vacation of Streets and alleys or easements, or adjustments of right-of-way or consolidation or resubdivision of parcels shall require a separate submittal on behalf of the Applicant or its Successors, Assignees or Grantees.
6. Any service drives or any other ingress or egress shall be adequately designed and paved in accord with the regulations of the Department of Streets and Sanitation and in compliance with the Municipal Code of Chicago, to provide ingress and egress for motor vehicles, including emergency vehicles; there shall be no parking within such paved areas. Fire lanes, if required, shall be adequately designed and paved in compliance with the Municipal Code of Chicago and shall have a minimum width of 20 feet to provide ingress and egress for emergency vehicles. There shall be no parking within such paved area.
7. The following uses are permitted in the area delineated herein as a Planned Development No. 139, as Amended: one (1) residential (penthouse) unit, and retail and commercial uses otherwise allowed in the B3-5 zoning district, including cultural exhibits and libraries, day care facilities, lodges or private clubs, community centers, recreation and similar assembly uses, movie and performance theaters, postal services, public safety services, minor utilities and service uses, animal services, artist work or sales space, building maintenance services, business equipment sales and service, business support services, communication service establishments, building material sales, eating and drinking establishments, including limited restaurants, general restaurants, taverns, outdoor patios (at grade or above grade), entertainment and spectator sports including indoor special events (with incidental liquor sales), small, medium, and large venues, banquet or meeting halls, financial services, including banks, savings bank, savings and loan associations, currency exchanges, and credit unions, automated teller machine facilities, food and beverage retail sales including packaged goods and/or liquor sales as a principal or accessory use, fortune telling services,

medical offices and related services, general office uses, accessory or non-accessory parking services, personal service uses, massage establishments, general retail sales, outdoor participant sports and recreation uses, indoor participate sports and recreation uses, public places of amusement, children's play centers, artisan manufacturing and/or production services, catering and shared kitchen uses, automobile rentals, and a recycling drop-off unit. All liquor licenses shall be subject to review and approval by the Department of Business Affairs and Consumer Protection and the local liquor commissioner.

8. Deleted.
9. Business and business identification signs may be permitted within the area delineated herein as Business Planned Development No. 139, as Amended, subject to the review and approval of the Department of Buildings and the Commissioner of the Department of Development and Planning.
10. The information in the table attached hereto sets forth data concerning the generalized land use plan of the area delineated herein as Business Planned Development No. 139, as Amended, and illustrates that the development of such area will be in accordance with the intent and purpose of the Chicago Zoning Ordinance.
11. The Plan of Development hereby attached shall be subject to the "Rules, Regulations and Procedures in Relation to Planned Developments," as promulgated by the Commissioner of Development and Planning.

Written Notice, Form of Affidavit: Section 17-13-0107

March 15, 2023

Honorable Thomas Tunney
Acting Chairman, Committee on Zoning
121 North LaSalle Street
Room 304 - City Hall
Chicago, Illinois 60602

To Whom It May Concern:

The undersigned, **Nicholas Ftikas**, being first duly sworn on oath, deposes and says the following:

That the undersigned certifies that he has complied with the requirements of Section 17-13-0107 of the Zoning Code of the City of Chicago, by sending amended written notice to such property owners who appear to be the owners of the property within the subject area not solely owned by the Applicant, and on the owners of all property within 250 feet in each direction of the lot line of the subject property, exclusive of the public roads, streets, alleys and other public ways, or a total distance limited to 400 feet. That said written notice was sent by USPS First Class Mail no more than 30 days before filing the application.

That the undersigned certifies that the amended notice contained the address of the property sought to be rezoned as **2828 N. Clark St., Chicago, Illinois**; a statement of intended use of said property; the name and address of the Applicants and Owners; and a statement that the Applicants intend to file an amended application for a change in zoning on approximately **March 15, 2023**.

That the Applicant has made a bonafide effort to determine the addresses of the parties to be notified under Section 17-13-0107 of the Zoning Code of the City of Chicago and that the Applicant certifies that the accompanying list of names and addresses of surrounding property owners within 250 feet is a complete list containing the names and last known addresses of the owners of the property required to be served.

Law Offices of Samuel V.P. Banks

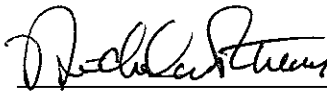
By: 
Nicholas J. Ftikas
Attorney for Applicant

Subscribed and Sworn to before me
this 16th day of February, 2023.

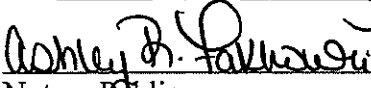
Notary Public

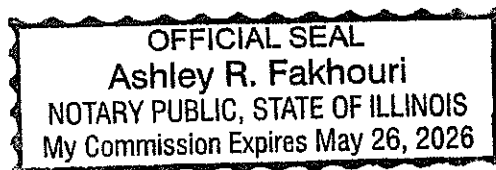

Via USPS First Class Mail
March 15, 2023

PUBLIC NOTICE

Dear Sir or Madam:

In accordance with the Amendment to the Chicago Zoning Code enacted by the City Council, Section 17-13-0107-A, please be informed that on or about March 15, 2023, I, the undersigned, intend to file an application for a change in zoning from Planned Development No. 139 to Planned Development No. 139, as Amended, on behalf of the Applicant and Property Owner, BAI Century, LLC, for the property located at **2828 N. Clark St., Chicago, IL.**

The Applicant is seeking to amend the Planned Development Statements to expand and otherwise clarify the allowed uses within the Planned Development (Use Statement No. 7, as Amended), including but not limited to the licensing restrictions for the sale of liquor for onsite consumption (Use Statement No. 8, as Amended). There are no changes or expansions proposed to the existing multi-use retail and commercial office building. The building will remain 96 ft. in height. Onsite parking for 409 cars will continue to be provided. The building will continue to be supported by the four (4) existing loading berths.

The Applicant and Property Owner, BAI Century, LLC, maintains principal offices at 720 E. Palisade Ave., Ste. 201, Englewood Cliffs, New Jersey, 07632.

I am the attorney for the Applicant and Property Owner. I will serve as the contact person for this zoning application. My address is 221 N. LaSalle St., 38th Floor, Chicago, IL 60601. My telephone number is (312) 782-1983.

Sincerely,

Law Offices of Samuel V.P. Banks



Nicholas J. Ftikas

Attorney for the Applicant

***Please note the Applicant is NOT seeking to purchase or rezone your property.**

***The Applicant is required by Ordinance to send this notice to you because you are shown to own property located within 250 feet of the property subject to the proposed Zoning Map Amendment.**

To whom it may concern:

I, Amit Barnoon, as Manager of BAI Century, LLC, a Delaware limited liability company authorized to transact business in the State of Illinois, the Applicant and Owner of the subject property located at 2828 N. Clark St., Chicago, IL, authorize the Law Offices of Samuel V.P. Banks to file a Planned Development Amendment Application with the City of Chicago for that property.



Amit Barnoon
BAI Century, LLC

FORM OF AFFIDAVIT

Chairman, Committee on Zoning
Room 304 - City Hall
Chicago, IL 60602

To Whom It May Concern:

I, Amit Barnoon, as Manager of BAI Century, LLC, a Delaware limited liability company authorized to transact business in the State of Illinois, understand that the Law Offices of Samuel V.P. Banks has filed a sworn affidavit identifying BAI Century, LLC, as the Applicant and Owner holding interest in land subject to the proposed zoning amendment for the property identified as 2828 N. Clark St., Chicago, IL.

I, Amit Barnoon, as Manager of BAI Century, LLC, a Delaware limited liability company authorized to transact business in the State of Illinois, being first duly sworn under oath, depose and say that BAI Century, LLC, holds that interest for itself and no other person, association, or shareholder.



Amit Barnoon Date
BAI Century, LLC

Subscribed and Sworn to before me

this 15 day of February, 2023.

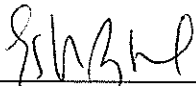

Notary Public

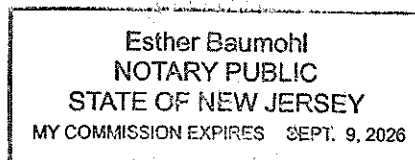

=====

COUNTY OF COOK
STATE OF ILLINOIS

I, Amit Barnoon, as Manager of BAI Century, LLC, a Delaware limited liability company authorized to transact business in the State of Illinois, being first duly sworn on oath, state that all of the above statements and the statements contained in the documents submitted herewith are, to the best of my knowledge, true and correct.

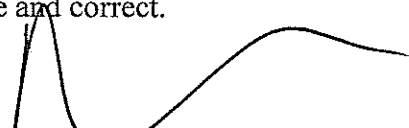

Signature of Applicant

Subscribed and Sworn to before me this

15 day of February, 2023.

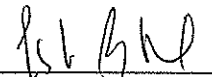

Notary Public

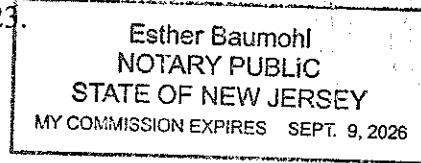

=====

For Office Use Only

Date of Introduction: _____

File Number: _____

Ward: _____

**CITY OF CHICAGO
ECONOMIC DISCLOSURE STATEMENT
AND AFFIDAVIT**

SECTION I -- GENERAL INFORMATION

A. Legal name of the Disclosing Party submitting this EDS. Include d/b/a/ if applicable:

BAI Century, LLC

Check ONE of the following three boxes:

Indicate whether the Disclosing Party submitting this EDS is:

1. the Applicant

OR

2. a legal entity currently holding, or anticipated to hold within six months after City action on the contract, transaction or other undertaking to which this EDS pertains (referred to below as the "Matter"), a direct or indirect interest in excess of 7.5% in the Applicant. State the Applicant's legal name: _____

OR

3. a legal entity with a direct or indirect right of control of the Applicant (see Section II(B)(1))
State the legal name of the entity in which the Disclosing Party holds a right of control:

B. Business address of the Disclosing Party: 720 E. Palisade Ave., Ste. 201
Englewood Cliffs, NJ 07632

C. Telephone: 312-782-1983 Fax: 312-782-2433 Email: nick@sambankslaw.com

D. Name of contact person: Nicholas Ftikas - Attorney

E. Federal Employer Identification No. (if you have one): _____

F. Brief description of the Matter to which this EDS pertains. (Include project number and location of property, if applicable):

Proposed Amendment to Planned Development No. 139 (2828 N. Clark St., Chicago, IL)

G. Which City agency or department is requesting this EDS? DPD/COZ

If the Matter is a contract being handled by the City's Department of Procurement Services, please complete the following:

Specification # _____ and Contract # _____

SECTION II -- DISCLOSURE OF OWNERSHIP INTERESTS

A. NATURE OF THE DISCLOSING PARTY

1. Indicate the nature of the Disclosing Party:

- Person
- Limited liability company
- Publicly registered business corporation
- Limited liability partnership
- Privately held business corporation
- Joint venture
- Sole proprietorship
- Not-for-profit corporation
- General partnership
- (Is the not-for-profit corporation also a 501(c)(3))?
- Limited partnership
- Yes No
- Trust
- Other (please specify)

2. For legal entities, the state (or foreign country) of incorporation or organization, if applicable:

Delaware

3. For legal entities not organized in the State of Illinois: Has the organization registered to do business in the State of Illinois as a foreign entity?

- Yes
- No
- Organized in Illinois

B. IF THE DISCLOSING PARTY IS A LEGAL ENTITY:

1. List below the full names and titles, if applicable, of: (i) all executive officers and all directors of the entity; (ii) **for not-for-profit corporations**, all members, if any, which are legal entities (if there are no such members, write "no members which are legal entities"); (iii) **for trusts, estates or other similar entities**, the trustee, executor, administrator, or similarly situated party; (iv) **for general or limited partnerships, limited liability companies, limited liability partnerships or joint ventures**, each general partner, managing member, manager or any other person or legal entity that directly or indirectly controls the day-to-day management of the Applicant.

NOTE: Each legal entity listed below must submit an EDS on its own behalf.

Name	Title
Amit Barnoon	Manager
Eyal Lev Ari	Manager

2. Please provide the following information concerning each person or legal entity having a direct or indirect, current or prospective (i.e. within 6 months after City action) beneficial interest (including ownership) in excess of 7.5% of the Applicant. Examples of such an interest include shares in a corporation, partnership interest in a partnership or joint venture, interest of a member or manager in a

limited liability company, or interest of a beneficiary of a trust, estate or other similar entity. If none, state "None."

NOTE: Each legal entity listed below may be required to submit an EDS on its own behalf.

Name	Business Address	Percentage Interest in the Applicant
Amit Barnoon	720 E. Palisade Ave., Ste. 201, Englewood Cliffs, NJ 07632	50%
Eyal Lev Ari	720 E. Palisade Ave., Ste. 201, Englewood Cliffs, NJ 07632	50%

SECTION III -- INCOME OR COMPENSATION TO, OR OWNERSHIP BY, CITY ELECTED OFFICIALS

Has the Disclosing Party provided any income or compensation to any City elected official during the 12-month period preceding the date of this EDS? Yes No

Does the Disclosing Party reasonably expect to provide any income or compensation to any City elected official during the 12-month period following the date of this EDS? Yes No

If "yes" to either of the above, please identify below the name(s) of such City elected official(s) and describe such income or compensation:

N/A

Does any City elected official or, to the best of the Disclosing Party's knowledge after reasonable inquiry, any City elected official's spouse or domestic partner, have a financial interest (as defined in Chapter 2-156 of the Municipal Code of Chicago ("MCC")) in the Disclosing Party?

Yes No

If "yes," please identify below the name(s) of such City elected official(s) and/or spouse(s)/domestic partner(s) and describe the financial interest(s).

N/A

SECTION IV -- DISCLOSURE OF SUBCONTRACTORS AND OTHER RETAINED PARTIES

The Disclosing Party must disclose the name and business address of each subcontractor, attorney, lobbyist (as defined in MCC Chapter 2-156), accountant, consultant and any other person or entity whom the Disclosing Party has retained or expects to retain in connection with the Matter, as well as the nature of the relationship, and the total amount of the fees paid or estimated to be paid. The Disclosing Party is not required to disclose employees who are paid solely through the Disclosing Party's regular payroll. If the Disclosing Party is uncertain whether a disclosure is required under this Section, the Disclosing Party must either ask the City whether disclosure is required or make the disclosure.

Name (indicate whether retained or anticipated to be retained)	Business Address	Relationship to Disclosing Party (subcontractor, attorney, lobbyist, etc.)	Fees (<u>indicate whether paid or estimated.</u>) NOTE: "hourly rate" or "t.b.d." is not an acceptable response.
Law Offices of Samuel V.P. Banks		Attorney	
221 N. LaSalle St., 38th Floor			Est. \$27,500.00
Chicago, IL 60601			

(Add sheets if necessary)

Check here if the Disclosing Party has not retained, nor expects to retain, any such persons or entities.

SECTION V -- CERTIFICATIONS

A. COURT-ORDERED CHILD SUPPORT COMPLIANCE

Under MCC Section 2-92-415, substantial owners of business entities that contract with the City must remain in compliance with their child support obligations throughout the contract's term.

Has any person who directly or indirectly owns 10% or more of the Disclosing Party been declared in arrearage on any child support obligations by any Illinois court of competent jurisdiction?

Yes No No person directly or indirectly owns 10% or more of the Disclosing Party.

If "Yes," has the person entered into a court-approved agreement for payment of all support owed and is the person in compliance with that agreement?

Yes No

B. FURTHER CERTIFICATIONS

1. [This paragraph 1 applies only if the Matter is a contract being handled by the City's Department of Procurement Services.] In the 5-year period preceding the date of this EDS, neither the Disclosing Party nor any Affiliated Entity [see definition in (5) below] has engaged, in connection with the performance of any public contract, the services of an integrity monitor, independent private sector inspector general, or integrity compliance consultant (i.e., an individual or entity with legal, auditing, investigative, or other similar skills, designated by a public agency to help the agency monitor the activity of specified agency vendors as well as help the vendors reform their business practices so they can be considered for agency contracts in the future, or continue with a contract in progress).

2. The Disclosing Party and its Affiliated Entities are not delinquent in the payment of any fine, fee, tax or other source of indebtedness owed to the City of Chicago, including, but not limited to, water and sewer charges, license fees, parking tickets, property taxes and sales taxes, nor is the Disclosing Party delinquent in the payment of any tax administered by the Illinois Department of Revenue.

3. The Disclosing Party and, if the Disclosing Party is a legal entity, all of those persons or entities identified in Section II(B)(1) of this EDS:

- a. are not presently debarred, suspended, proposed for debarment, declared ineligible or voluntarily excluded from any transactions by any federal, state or local unit of government;
- b. have not, during the 5 years before the date of this EDS, been convicted of a criminal offense, adjudged guilty, or had a civil judgment rendered against them in connection with: obtaining, attempting to obtain, or performing a public (federal, state or local) transaction or contract under a public transaction; a violation of federal or state antitrust statutes; fraud; embezzlement; theft; forgery; bribery; falsification or destruction of records; making false statements; or receiving stolen property;
- c. are not presently indicted for, or criminally or civilly charged by, a governmental entity (federal, state or local) with committing any of the offenses set forth in subparagraph (b) above;
- d. have not, during the 5 years before the date of this EDS, had one or more public transactions (federal, state or local) terminated for cause or default; and
- e. have not, during the 5 years before the date of this EDS, been convicted, adjudged guilty, or found liable in a civil proceeding, or in any criminal or civil action, including actions concerning environmental violations, instituted by the City or by the federal government, any state, or any other unit of local government.

4. The Disclosing Party understands and shall comply with the applicable requirements of MCC Chapters 2-56 (Inspector General) and 2-156 (Governmental Ethics).

5. Certifications (5), (6) and (7) concern:

- the Disclosing Party;
- any "Contractor" (meaning any contractor or subcontractor used by the Disclosing Party in connection with the Matter, including but not limited to all persons or legal entities disclosed under Section IV, "Disclosure of Subcontractors and Other Retained Parties");
- any "Affiliated Entity" (meaning a person or entity that, directly or indirectly: controls the Disclosing Party, is controlled by the Disclosing Party, or is, with the Disclosing Party, under common control of another person or entity). Indicia of control include, without limitation: interlocking management or ownership; identity of interests among family members, shared facilities and equipment; common use of employees; or organization of a business entity following the ineligibility of a business entity to do business with federal or state or local government, including the City, using substantially the same management, ownership, or principals as the ineligible entity. With respect to Contractors, the term Affiliated Entity means a person or entity that directly or indirectly controls the Contractor, is controlled by it, or, with the Contractor, is under common control of another person or entity;
- any responsible official of the Disclosing Party, any Contractor or any Affiliated Entity or any other official, agent or employee of the Disclosing Party, any Contractor or any Affiliated Entity, acting pursuant to the direction or authorization of a responsible official of the Disclosing Party, any Contractor or any Affiliated Entity (collectively "Agents").

Neither the Disclosing Party, nor any Contractor, nor any Affiliated Entity of either the Disclosing Party or any Contractor, nor any Agents have, during the 5 years before the date of this EDS, or, with respect to a Contractor, an Affiliated Entity, or an Affiliated Entity of a Contractor during the 5 years before the date of such Contractor's or Affiliated Entity's contract or engagement in connection with the Matter:

- a. bribed or attempted to bribe, or been convicted or adjudged guilty of bribery or attempting to bribe, a public officer or employee of the City, the State of Illinois, or any agency of the federal government or of any state or local government in the United States of America, in that officer's or employee's official capacity;
 - b. agreed or colluded with other bidders or prospective bidders, or been a party to any such agreement, or been convicted or adjudged guilty of agreement or collusion among bidders or prospective bidders, in restraint of freedom of competition by agreement to bid a fixed price or otherwise; or
 - c. made an admission of such conduct described in subparagraph (a) or (b) above that is a matter of record, but have not been prosecuted for such conduct; or
 - d. violated the provisions referenced in MCC Subsection 2-92-320(a)(4)(Contracts Requiring a Base Wage); (a)(5)(Debarment Regulations); or (a)(6)(Minimum Wage Ordinance).
6. Neither the Disclosing Party, nor any Affiliated Entity or Contractor, or any of their employees, officials, agents or partners, is barred from contracting with any unit of state or local government as a result of engaging in or being convicted of (1) bid-rigging in violation of 720 ILCS 5/33E-3; (2) bid-rotating in violation of 720 ILCS 5/33E-4; or (3) any similar offense of any state or of the United States of America that contains the same elements as the offense of bid-rigging or bid-rotating.
7. Neither the Disclosing Party nor any Affiliated Entity is listed on a Sanctions List maintained by the United States Department of Commerce, State, or Treasury, or any successor federal agency.
8. [FOR APPLICANT ONLY] (i) Neither the Applicant nor any "controlling person" [see MCC Chapter 1-23, Article I for applicability and defined terms] of the Applicant is currently indicted or charged with, or has admitted guilt of, or has ever been convicted of, or placed under supervision for, any criminal offense involving actual, attempted, or conspiracy to commit bribery, theft, fraud, forgery, perjury, dishonesty or deceit against an officer or employee of the City or any "sister agency"; and (ii) the Applicant understands and acknowledges that compliance with Article I is a continuing requirement for doing business with the City. NOTE: If MCC Chapter 1-23, Article I applies to the Applicant, that Article's permanent compliance timeframe supersedes 5-year compliance timeframes in this Section V.
9. [FOR APPLICANT ONLY] The Applicant and its Affiliated Entities will not use, nor permit their subcontractors to use, any facility listed as having an active exclusion by the U.S. EPA on the federal System for Award Management ("SAM").
10. [FOR APPLICANT ONLY] The Applicant will obtain from any contractors/subcontractors hired or to be hired in connection with the Matter certifications equal in form and substance to those in Certifications (2) and (9) above and will not, without the prior written consent of the City, use any such

contractor/subcontractor that does not provide such certifications or that the Applicant has reason to believe has not provided or cannot provide truthful certifications.

11. If the Disclosing Party is unable to certify to any of the above statements in this Part B (Further Certifications), the Disclosing Party must explain below:

N/A

If the letters "NA," the word "None," or no response appears on the lines above, it will be conclusively presumed that the Disclosing Party certified to the above statements.

12. To the best of the Disclosing Party's knowledge after reasonable inquiry, the following is a complete list of all current employees of the Disclosing Party who were, at any time during the 12-month period preceding the date of this EDS, an employee, or elected or appointed official, of the City of Chicago (if none, indicate with "N/A" or "none").

N/A

13. To the best of the Disclosing Party's knowledge after reasonable inquiry, the following is a complete list of all gifts that the Disclosing Party has given or caused to be given, at any time during the 12-month period preceding the execution date of this EDS, to an employee, or elected or appointed official, of the City of Chicago. For purposes of this statement, a "gift" does not include: (i) anything made generally available to City employees or to the general public, or (ii) food or drink provided in the course of official City business and having a retail value of less than \$25 per recipient, or (iii) a political contribution otherwise duly reported as required by law (if none, indicate with "N/A" or "none"). As to any gift listed below, please also list the name of the City recipient.

N/A

C. CERTIFICATION OF STATUS AS FINANCIAL INSTITUTION

1. The Disclosing Party certifies that the Disclosing Party (check one)

is is not

a "financial institution" as defined in MCC Section 2-32-455(b).

2. If the Disclosing Party IS a financial institution, then the Disclosing Party pledges:

"We are not and will not become a predatory lender as defined in MCC Chapter 2-32. We further pledge that none of our affiliates is, and none of them will become, a predatory lender as defined in MCC Chapter 2-32. We understand that becoming a predatory lender or becoming an affiliate of a predatory lender may result in the loss of the privilege of doing business with the City."

If the Disclosing Party is unable to make this pledge because it or any of its affiliates (as defined in MCC Section 2-32-455(b)) is a predatory lender within the meaning of MCC Chapter 2-32, explain here (attach additional pages if necessary):

N/A

If the letters "NA," the word "None," or no response appears on the lines above, it will be conclusively presumed that the Disclosing Party certified to the above statements.

D. CERTIFICATION REGARDING FINANCIAL INTEREST IN CITY BUSINESS

Any words or terms defined in MCC Chapter 2-156 have the same meanings if used in this Part D.

1. In accordance with MCC Section 2-156-110: To the best of the Disclosing Party's knowledge after reasonable inquiry, does any official or employee of the City have a financial interest in his or her own name or in the name of any other person or entity in the Matter?

Yes

No

NOTE: If you checked "Yes" to Item D(1), proceed to Items D(2) and D(3). If you checked "No" to Item D(1), skip Items D(2) and D(3) and proceed to Part E.

2. Unless sold pursuant to a process of competitive bidding, or otherwise permitted, no City elected official or employee shall have a financial interest in his or her own name or in the name of any other person or entity in the purchase of any property that (i) belongs to the City, or (ii) is sold for taxes or assessments, or (iii) is sold by virtue of legal process at the suit of the City (collectively, "City Property Sale"). Compensation for property taken pursuant to the City's eminent domain power does not constitute a financial interest within the meaning of this Part D.

Does the Matter involve a City Property Sale?

Yes

No

3. If you checked "Yes" to Item D(1), provide the names and business addresses of the City officials or employees having such financial interest and identify the nature of the financial interest:

Name	Business Address	Nature of Financial Interest
N/A		

4. The Disclosing Party further certifies that no prohibited financial interest in the Matter will be acquired by any City official or employee.

E. CERTIFICATION REGARDING SLAVERY ERA BUSINESS

Please check either (1) or (2) below. If the Disclosing Party checks (2), the Disclosing Party must disclose below or in an attachment to this EDS all information required by (2). Failure to comply with these disclosure requirements may make any contract entered into with the City in connection with the Matter voidable by the City.

X 1. The Disclosing Party verifies that the Disclosing Party has searched any and all records of the Disclosing Party and any and all predecessor entities regarding records of investments or profits from slavery or slaveholder insurance policies during the slavery era (including insurance policies issued to slaveholders that provided coverage for damage to or injury or death of their slaves), and the Disclosing Party has found no such records.

2. The Disclosing Party verifies that, as a result of conducting the search in step (1) above, the Disclosing Party has found records of investments or profits from slavery or slaveholder insurance policies. The Disclosing Party verifies that the following constitutes full disclosure of all such records, including the names of any and all slaves or slaveholders described in those records:

_____ N/A

SECTION VI -- CERTIFICATIONS FOR FEDERALLY FUNDED MATTERS

NOTE: If the Matter is federally funded, complete this Section VI. If the Matter is not federally funded, proceed to Section VII. For purposes of this Section VI, tax credits allocated by the City and proceeds of debt obligations of the City are not federal funding.

A. CERTIFICATION REGARDING LOBBYING

1. List below the names of all persons or entities registered under the federal Lobbying Disclosure Act of 1995, as amended, who have made lobbying contacts on behalf of the Disclosing Party with respect to the Matter: (Add sheets if necessary):

_____ N/A

(If no explanation appears or begins on the lines above, or if the letters "NA" or if the word "None" appear, it will be conclusively presumed that the Disclosing Party means that NO persons or entities registered under the Lobbying Disclosure Act of 1995, as amended, have made lobbying contacts on behalf of the Disclosing Party with respect to the Matter.)

2. The Disclosing Party has not spent and will not expend any federally appropriated funds to pay any person or entity listed in paragraph A(1) above for his or her lobbying activities or to pay any person or entity to influence or attempt to influence an officer or employee of any agency, as defined by applicable federal law, a member of Congress, an officer or employee of Congress, or an employee

of a member of Congress, in connection with the award of any federally funded contract, making any federally funded grant or loan, entering into any cooperative agreement, or to extend, continue, renew, amend, or modify any federally funded contract, grant, loan, or cooperative agreement.

3. The Disclosing Party will submit an updated certification at the end of each calendar quarter in which there occurs any event that materially affects the accuracy of the statements and information set forth in paragraphs A(1) and A(2) above.

4. The Disclosing Party certifies that either: (i) it is not an organization described in section 501(c)(4) of the Internal Revenue Code of 1986; or (ii) it is an organization described in section 501(c)(4) of the Internal Revenue Code of 1986 but has not engaged and will not engage in "Lobbying Activities," as that term is defined in the Lobbying Disclosure Act of 1995, as amended.

5. If the Disclosing Party is the Applicant, the Disclosing Party must obtain certifications equal in form and substance to paragraphs A(1) through A(4) above from all subcontractors before it awards any subcontract and the Disclosing Party must maintain all such subcontractors' certifications for the duration of the Matter and must make such certifications promptly available to the City upon request.

B. CERTIFICATION REGARDING EQUAL EMPLOYMENT OPPORTUNITY

If the Matter is federally funded, federal regulations require the Applicant and all proposed subcontractors to submit the following information with their bids or in writing at the outset of negotiations. N/A - Not Federally Funded

Is the Disclosing Party the Applicant?
 Yes No

If "Yes," answer the three questions below:

1. Have you developed and do you have on file affirmative action programs pursuant to applicable federal regulations? (See 41 CFR Part 60-2.)
 Yes No

2. Have you filed with the Joint Reporting Committee, the Director of the Office of Federal Contract Compliance Programs, or the Equal Employment Opportunity Commission all reports due under the applicable filing requirements?
 Yes No Reports not required

3. Have you participated in any previous contracts or subcontracts subject to the equal opportunity clause?
 Yes No

If you checked "No" to question (1) or (2) above, please provide an explanation:

N/A

SECTION VII -- FURTHER ACKNOWLEDGMENTS AND CERTIFICATION

The Disclosing Party understands and agrees that:

A. The certifications, disclosures, and acknowledgments contained in this EDS will become part of any contract or other agreement between the Applicant and the City in connection with the Matter, whether procurement, City assistance, or other City action, and are material inducements to the City's execution of any contract or taking other action with respect to the Matter. The Disclosing Party understands that it must comply with all statutes, ordinances, and regulations on which this EDS is based.

B. The City's Governmental Ethics Ordinance, MCC Chapter 2-156, imposes certain duties and obligations on persons or entities seeking City contracts, work, business, or transactions. The full text of this ordinance and a training program is available on line at www.cityofchicago.org/Ethics, and may also be obtained from the City's Board of Ethics, 740 N. Sedgwick St., Suite 500, Chicago, IL 60610, (312) 744-9660. The Disclosing Party must comply fully with this ordinance.

C. If the City determines that any information provided in this EDS is false, incomplete or inaccurate, any contract or other agreement in connection with which it is submitted may be rescinded or be void or voidable, and the City may pursue any remedies under the contract or agreement (if not rescinded or void), at law, or in equity, including terminating the Disclosing Party's participation in the Matter and/or declining to allow the Disclosing Party to participate in other City transactions. Remedies at law for a false statement of material fact may include incarceration and an award to the City of treble damages.

D. It is the City's policy to make this document available to the public on its Internet site and/or upon request. Some or all of the information provided in, and appended to, this EDS may be made publicly available on the Internet, in response to a Freedom of Information Act request, or otherwise. By completing and signing this EDS, the Disclosing Party waives and releases any possible rights or claims which it may have against the City in connection with the public release of information contained in this EDS and also authorizes the City to verify the accuracy of any information submitted in this EDS.

E. The information provided in this EDS must be kept current. In the event of changes, the Disclosing Party must supplement this EDS up to the time the City takes action on the Matter. If the Matter is a contract being handled by the City's Department of Procurement Services, the Disclosing Party must update this EDS as the contract requires. **NOTE:** With respect to Matters subject to MCC Chapter 1-23, Article I (imposing **PERMANENT INELIGIBILITY** for certain specified offenses), the information provided herein regarding eligibility must be kept current for a longer period, as required by MCC Chapter 1-23 and Section 2-154-020.

CERTIFICATION

Under penalty of perjury, the person signing below: (1) warrants that he/she is authorized to execute this EDS, and all applicable Appendices, on behalf of the Disclosing Party, and (2) warrants that all certifications and statements contained in this EDS, and all applicable Appendices, are true, accurate and complete as of the date furnished to the City.

BAI Century, LLC

(Print or type exact legal name of Disclosing Party)

By: _____
(Sign here)

Amit Barnoon

(Print or type name of person signing)

Manager

(Print or type title of person signing)

Signed and sworn to before me on (date) January 12, 2023

at Bergen County, New Jersey (state).

Esther Baumohl
Notary Public

Commission expires: 9-9-26

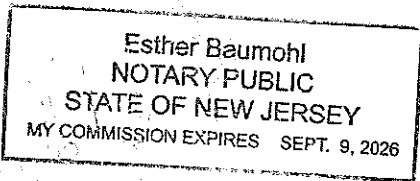

**CITY OF CHICAGO
ECONOMIC DISCLOSURE STATEMENT AND AFFIDAVIT
APPENDIX A**

**FAMILIAL RELATIONSHIPS WITH ELECTED CITY OFFICIALS
AND DEPARTMENT HEADS**

This Appendix is to be completed only by (a) the Applicant, and (b) any legal entity which has a direct ownership interest in the Applicant exceeding 7.5%. It is not to be completed by any legal entity which has only an indirect ownership interest in the Applicant.

Under MCC Section 2-154-015, the Disclosing Party must disclose whether such Disclosing Party or any "Applicable Party" or any Spouse or Domestic Partner thereof currently has a "familial relationship" with any elected city official or department head. A "familial relationship" exists if, as of the date this EDS is signed, the Disclosing Party or any "Applicable Party" or any Spouse or Domestic Partner thereof is related to the mayor, any alderman, the city clerk, the city treasurer or any city department head as spouse or domestic partner or as any of the following, whether by blood or adoption: parent, child, brother or sister, aunt or uncle, niece or nephew, grandparent, grandchild, father-in-law, mother-in-law, son-in-law, daughter-in-law, stepfather or stepmother, stepson or stepdaughter, stepbrother or stepsister or half-brother or half-sister.

"Applicable Party" means (1) all executive officers of the Disclosing Party listed in Section II.B.1.a., if the Disclosing Party is a corporation; all partners of the Disclosing Party, if the Disclosing Party is a general partnership; all general partners and limited partners of the Disclosing Party, if the Disclosing Party is a limited partnership; all managers, managing members and members of the Disclosing Party, if the Disclosing Party is a limited liability company; (2) all principal officers of the Disclosing Party; and (3) any person having more than a 7.5% ownership interest in the Disclosing Party. "Principal officers" means the president, chief operating officer, executive director, chief financial officer, treasurer or secretary of a legal entity or any person exercising similar authority.

Does the Disclosing Party or any "Applicable Party" or any Spouse or Domestic Partner thereof currently have a "familial relationship" with an elected city official or department head?

Yes No

If yes, please identify below (1) the name and title of such person, (2) the name of the legal entity to which such person is connected; (3) the name and title of the elected city official or department head to whom such person has a familial relationship, and (4) the precise nature of such familial relationship.

N/A

**CITY OF CHICAGO
ECONOMIC DISCLOSURE STATEMENT AND AFFIDAVIT
APPENDIX B**

BUILDING CODE SCOFFLAW/PROBLEM LANDLORD CERTIFICATION

This Appendix is to be completed only by (a) the Applicant, and (b) any legal entity which has a direct ownership interest in the Applicant exceeding 7.5% (an "Owner"). It is not to be completed by any legal entity which has only an indirect ownership interest in the Applicant.

1. Pursuant to MCC Section 2-154-010, is the Applicant or any Owner identified as a building code scofflaw or problem landlord pursuant to MCC Section 2-92-416?

Yes No

2. If the Applicant is a legal entity publicly traded on any exchange, is any officer or director of the Applicant identified as a building code scofflaw or problem landlord pursuant to MCC Section 2-92-416?

Yes No The Applicant is not publicly traded on any exchange.

3. If yes to (1) or (2) above, please identify below the name of each person or legal entity identified as a building code scofflaw or problem landlord and the address of each building or buildings to which the pertinent code violations apply.

N/A

**CITY OF CHICAGO
ECONOMIC DISCLOSURE STATEMENT AND AFFIDAVIT
APPENDIX C**

PROHIBITION ON WAGE & SALARY HISTORY SCREENING - CERTIFICATION

This Appendix is to be completed only by an Applicant that is completing this EDS as a “contractor” as defined in MCC Section 2-92-385. That section, which should be consulted (www.amlegal.com), generally covers a party to any agreement pursuant to which they: (i) receive City of Chicago funds in consideration for services, work or goods provided (including for legal or other professional services), or (ii) pay the City money for a license, grant or concession allowing them to conduct a business on City premises.

On behalf of an Applicant that is a contractor pursuant to MCC Section 2-92-385, I hereby certify that the Applicant is in compliance with MCC Section 2-92-385(b)(1) and (2), which prohibit: (i) screening job applicants based on their wage or salary history, or (ii) seeking job applicants’ wage or salary history from current or former employers. I also certify that the Applicant has adopted a policy that includes those prohibitions.

Yes

No

N/A – I am not an Applicant that is a “contractor” as defined in MCC Section 2-92-385.

This certification shall serve as the affidavit required by MCC Section 2-92-385(c)(1).

If you checked “no” to the above, please explain.

N/A

ADJACENT 408 CAR PARKING GARAGE
(LA FITNESS ABOVE LEVELS 7 & 8)

COLOR KEY
 [Hatched Box] PERMANENT
 [Dotted Box] TEMPORARY
 [White Box] AVAILABLE

ROOM KEY
 (100) - UNIT NUMBER
 0,000 S.F. - UNIT SQUARE FOOTAGE

DEVELOPMENT DATA

LEASABLE AREA	
OHMA LEVEL	21,713 S.F.
FIRST LEVEL	15,983 S.F.
SECOND LEVEL	20,457 S.F.
THIRD LEVEL	19,914 S.F.
FOURTH LEVEL	19,914 S.F.
LANDMARK'S CENTURY CENTRE OHMA (LEVELS 2 & 6)	24,944 S.F.
LA FITNESS (LEVELS 7 & 8)	50,779 S.F.
OVERALL LEASABLE AREA	174,836 S.F.
LAND AREA	1.39 ACRES
TOTAL PARKING SPACES PROVIDED IN PARKING GARAGE (LEVELS 1-4)	408 CARS

NOTE: ALL OF THE TENANT NAMES WHICH ARE INDICATED ON THIS PLAN REPRESENT THOSE LEASES WHICH ARE EXECUTED, OUT FOR SIGNATURE, IN NEGOTIATION, OR PROPOSED. ALL TENANTS WHOSE LEASES ARE NOT EXECUTED, OUT FOR SIGNATURE, IN NEGOTIATION, OR PROPOSED ARE APPROXIMATE AND SUBJECT TO FIELD VERIFICATION.

**FIRST LEVEL
LEASE PLAN
CENTURY SHOPPING CENTRE**

CHICAGO, ILLINOIS

Bon Aviv Investments
 MANAGED BY



231 MARKET STREET
 JOHNSTOWN, PA 15901
 (814) 254-4004
 abz@abzre.com
 REAL ESTATE | info@abzre.com

SCALE
 0 10 20 40 FEET

DATE: 03/20/2019

LP-1

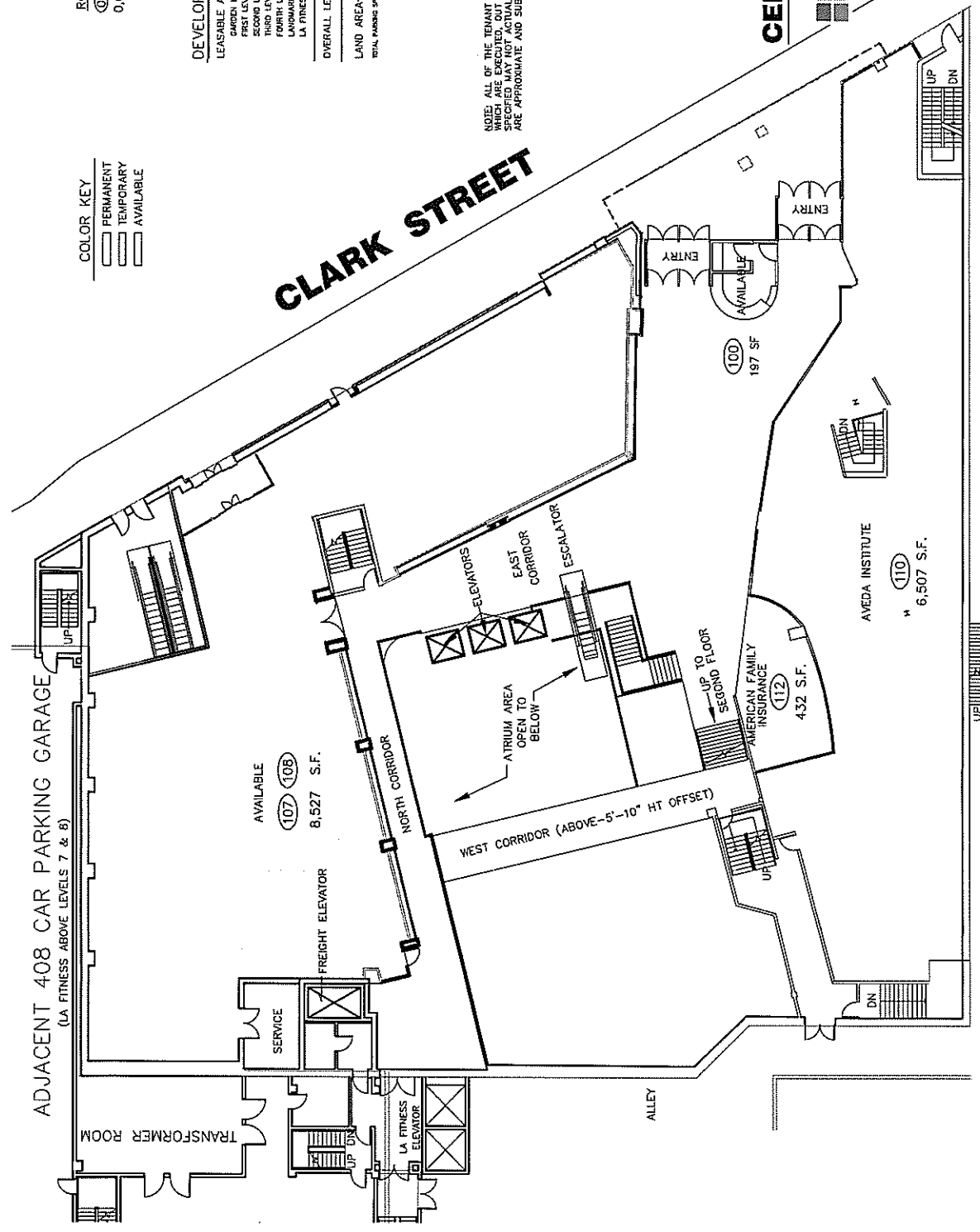

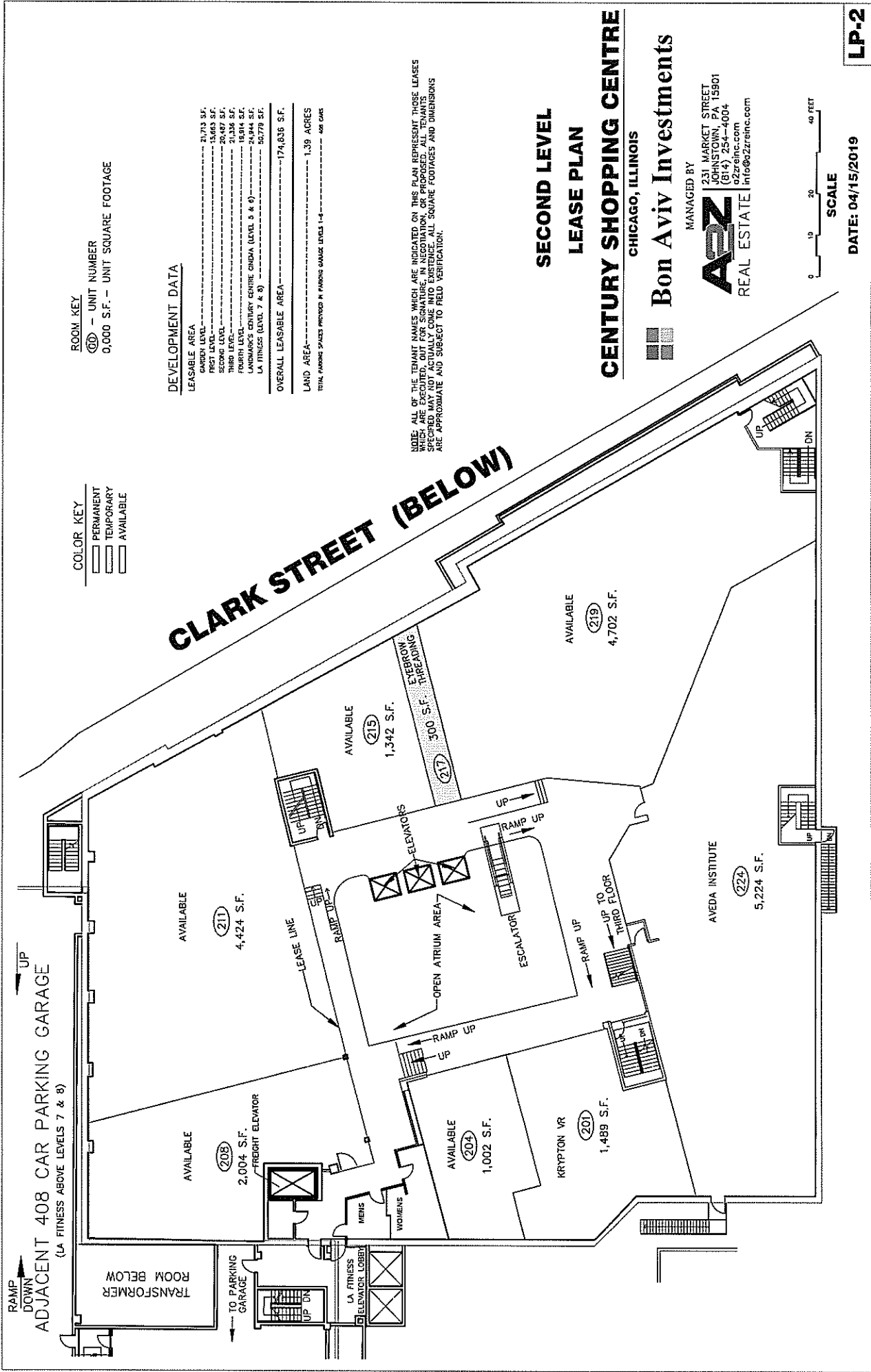

ROOM KEY
 (Circled number) - UNIT NUMBER
 0,000 S.F. - UNIT SQUARE FOOTAGE

COLOR KEY
 [Solid box] PERMANENT
 [Dotted box] TEMPORARY
 [Hatched box] AVAILABLE

DEVELOPMENT DATA

LEASABLE AREA	
GARAGE LEVEL	2,773 S.F.
FIRST LEVEL	15,663 S.F.
SECOND LEVEL	20,197 S.F.
THIRD LEVEL	18,117 S.F.
FOURTH LEVEL	18,914 S.F.
LANDMARK'S CENTURY CENTRE GINOA (LEVEL 5 & 6)	24,944 S.F.
LA FITNESS (LEVEL 7 & 8)	5,778 S.F.
OVERALL LEASABLE AREA	174,836 S.F.
LAND AREA	1.39 ACRES
TOTAL PARKING SPACES PROVIDED IN PARKING GARAGE LEVELS 7-8	408 CARS

NOTE: ALL OF THE TENANT NAMES WHICH ARE INDICATED ON THIS PLAN REPRESENT THOSE LEASES WHICH ARE EXECUTED, OUT FOR SIGNATURE, IN NEGOTIATION, OR PROPOSED. ALL TENANTS ARE SUBJECT TO THE TERMS AND CONDITIONS OF THEIR RESPECTIVE LEASES. ALL SQUARE FOOTAGES AND DIMENSIONS ARE APPROXIMATE AND SUBJECT TO FIELD VERIFICATION.

**SECOND LEVEL
LEASE PLAN**

CENTURY SHOPPING CENTRE
CHICAGO, ILLINOIS

Bon Aviv Investments
 MANAGED BY

AEZ
 REAL ESTATE
 231 MARKET STREET
 JOHNSTOWN, PA 15901
 (814) 254-4004
 ae2@aezre.com
 info@aezre.com



SCALE

DATE: 04/15/2019

ADJACENT 408 CAR PARKING GARAGE
(LA FITNESS ABOVE LEVELS 7 & 8)

COLOR KEY
 [Solid Line] PERMANENT
 [Dashed Line] TEMPORARY
 [Dotted Line] AVAILABLE

ROOM KEY
 (00) - UNIT NUMBER
 0,000 S.F. - UNIT SQUARE FOOTAGE

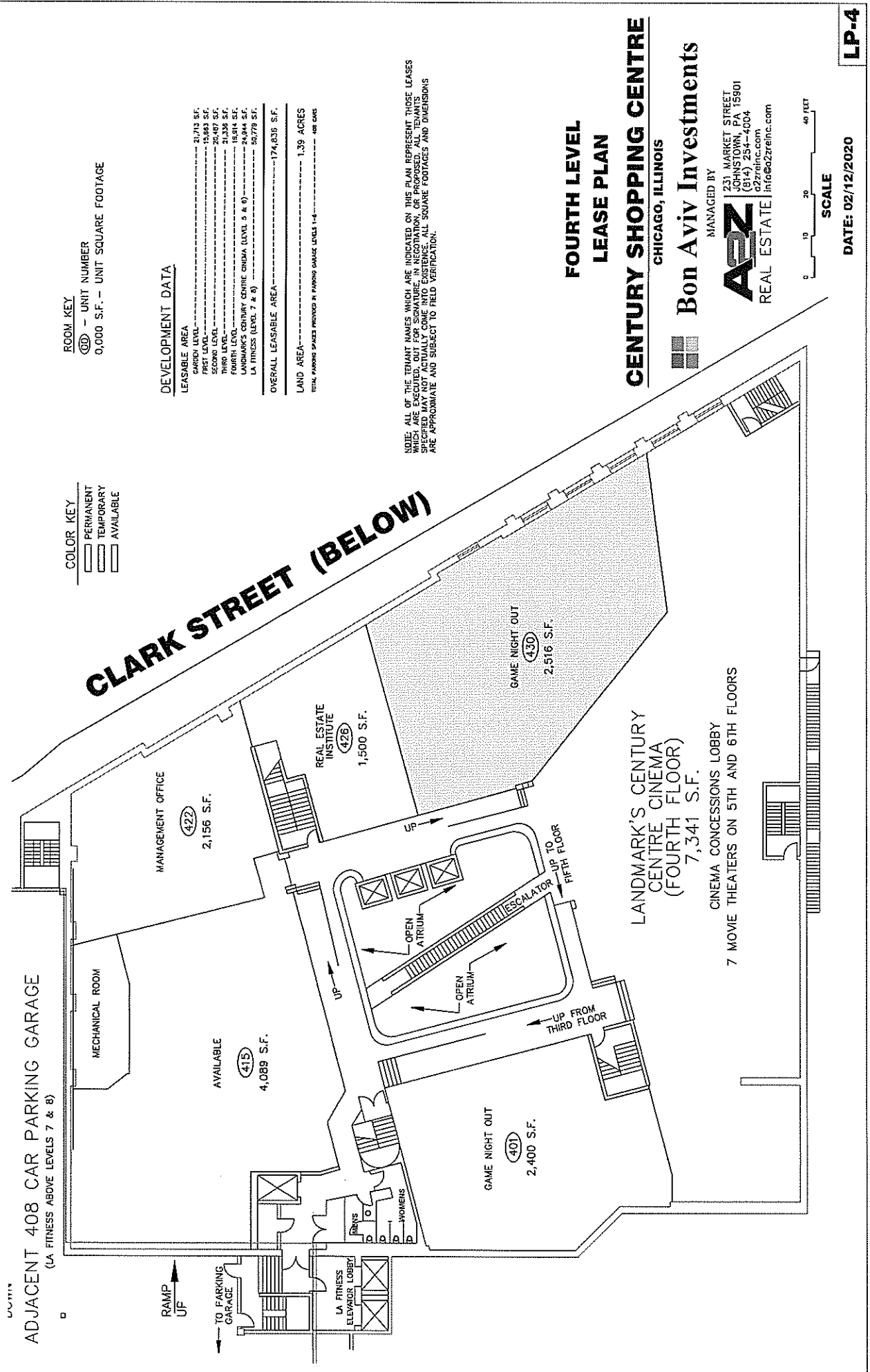

DEVELOPMENT DATA

LEASABLE AREA	2,713 S.F.
GARAGE LEVEL	15,983 S.F.
FIRST LEVEL	26,407 S.F.
SECOND LEVEL	18,914 S.F.
THIRD LEVEL	18,914 S.F.
FOURTH LEVEL	24,944 S.F.
LANDMARK'S CENTURY CENTRE CINEMA (LEVEL 5 & 6)	59,778 S.F.
LA FITNESS (LEVEL 7 & 8)	174,835 S.F.
OVERALL LEASABLE AREA	1,39 ACRES
LAND AREA	TOTAL PARKING SPACES PROVIDED IN PARKING GARAGE, LEVELS 1-6
	408 SPACES

NOTE: ALL OF THE TENANT NAMES WHICH ARE INDICATED ON THIS PLAN REPRESENT THOSE LEASES WHICH ARE EXECUTED, OUT FOR SIGNATURE, IN NEGOTIATION, OR PROPOSED. ALL TENANTS WHOSE NAMES ARE NOT INDICATED ON THIS PLAN ARE SUBJECT TO FUTURE NEGOTIATION. SQUARE FOOTAGES AND DIMENSIONS ARE APPROXIMATE AND SUBJECT TO FIELD VERIFICATION.

**FOURTH LEVEL
LEASE PLAN**

**CENTURY SHOPPING CENTRE
CHICAGO, ILLINOIS**

Bon Aviv Investments
 MANAGED BY



1231 MARKET STREET
 JOHNSTOWN, PA 15901
 (814) 254-4004
 czze@abzre.com
 info@abzre.com

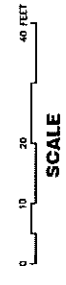

DATE: 02/12/2020

LP-4

DOWN
 ADJACENT 408 CAR PARKING GARAGE
 (LA FITNESS ABOVE LEVELS 7 & 8)

**LANDMARK'S CENTURY
 CENTRE CINEMA**
 24,944 S.F.
 (FIFTH & SIXTH FLOOR)

ROOM KEY
 (C) - UNIT NUMBER
 0,000 S.F. - UNIT SQUARE FOOTAGE

DEVELOPMENT DATA

LEASABLE AREA	-----	174,836 S.F.
CHINA LEVEL	-----	2,713 S.F.
FIRST LEVEL	-----	15,983 S.F.
SECOND LEVEL	-----	20,497 S.F.
THIRD LEVEL	-----	18,914 S.F.
FOURTH LEVEL	-----	24,944 S.F.
LANDMARK'S CENTURY CENTRE CHINA (LEVEL 5 & 6)	-----	24,944 S.F.
LA FITNESS (LEVEL 7 & 8)	-----	50,779 S.F.
OVERALL LEASABLE AREA	-----	174,836 S.F.
LAND AREA	-----	1.39 ACRES
TOTAL PARKING SPACES PROVIDED AT PARKING GARAGE LEVELS 7-8	-----	400 SPACES

NOTE: ALL OF THE TENANT NAMES WHICH ARE INDICATED ON THIS PLAN REPRESENT THOSE LEASES WHICH ARE EXECUTED, BUT FOR SIGNATURE, IN NEGOTIATION, OR PROPOSED. ALL TENANTS WHOSE LEASES ARE NOT EXECUTED, IN NEGOTIATION, OR PROPOSED, ALL SQUARE FOOTAGES AND DIMENSIONS ARE APPROXIMATE AND SUBJECT TO FIELD VERIFICATION.

CLARK STREET (BELOW)

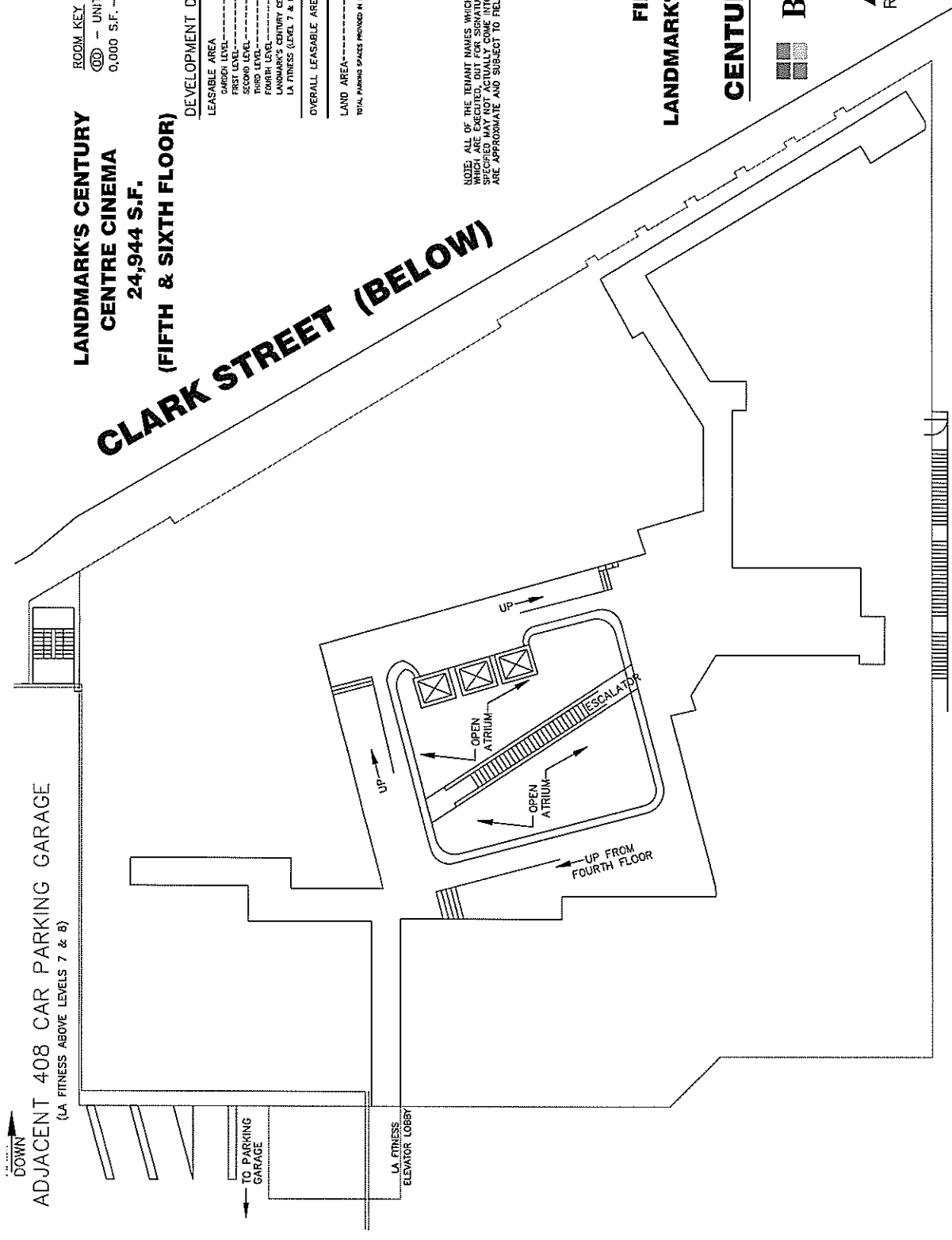

**FIFTH AND SIXTH LEVEL
 LANDMARK'S CENTURY CENTRE THEATER
 LEASE PLAN
 CENTURY SHOPPING CENTRE
 CHICAGO, ILLINOIS**

Bon Aviv Investments

MANAGED BY
AAZ
 231 MARKET STREET
 JOHNSTOWN, PA 15901
 (814) 254-4004
 aaz@reinc.com
 REAL ESTATE | info@aaazreinc.com

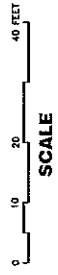

DATE: 06/15/2016

COLOR KEY
 [Hatched Box] OCCUPIED
 [White Box] VACANT

ROOM KEY
 [Circle with 00] - UNIT NUMBER
 0,000 S.F. - UNIT SQUARE FOOTAGE

ORCHARD STREET BELOW

LA FITNESS
 50,779 S.F.

408 CAR PARKING GARAGE BELOW

CLARK STREET BELOW

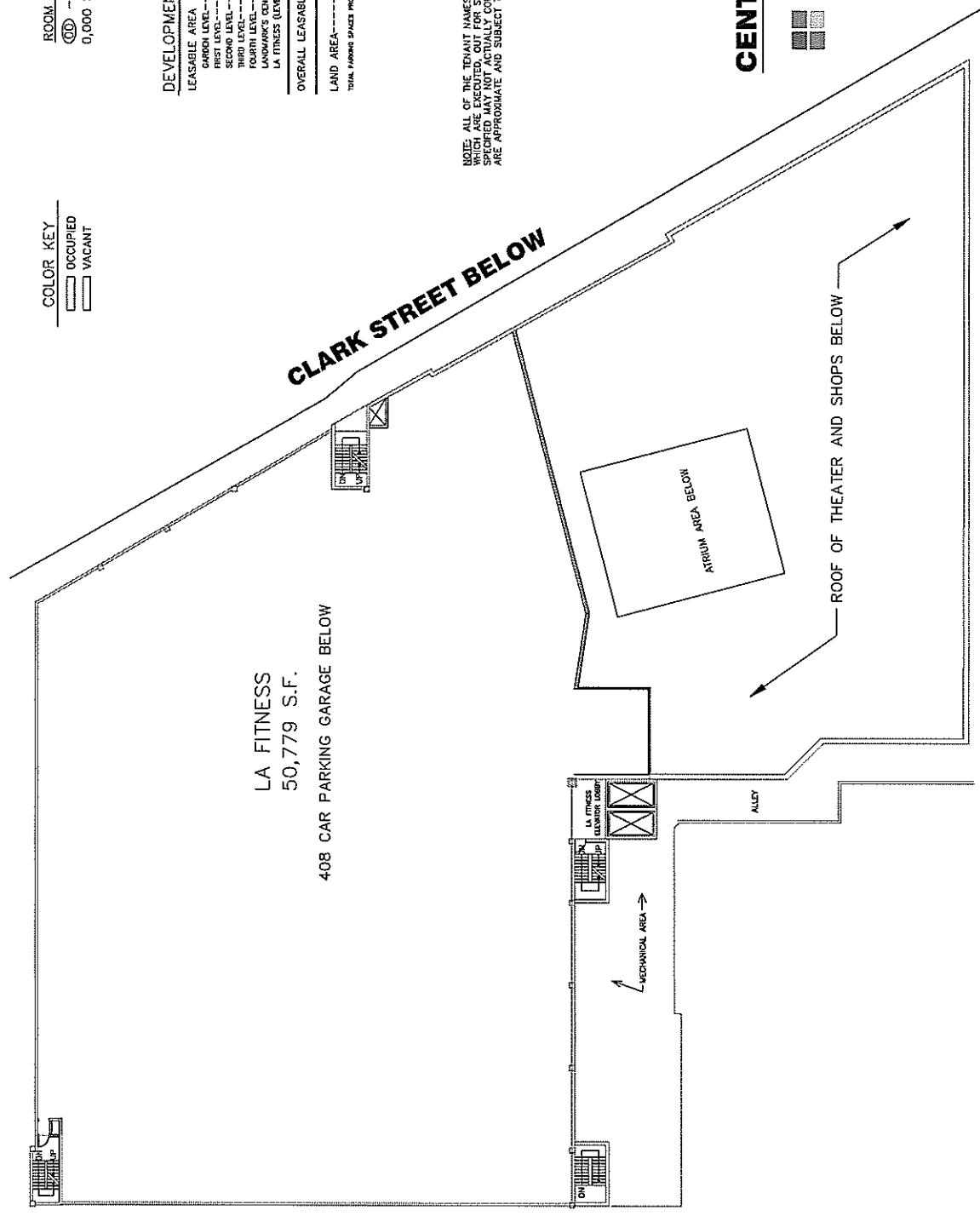

DEVELOPMENT DATA

LEASABLE AREA	
CURRENT LEVEL	21,713 S.F.
FIRST LEVEL	15,083 S.F.
SECOND LEVEL	20,497 S.F.
THIRD LEVEL	15,083 S.F.
FOURTH LEVEL	19,914 S.F.
LANDMARK'S CENTURY CENTRE CHINA (LEVEL 5 & 6)	24,944 S.F.
LA FITNESS (LEVEL 7 & 8)	50,779 S.F.
OVERALL LEASABLE AREA	174,936 S.F.
LAND AREA ----- 1.39 ACRES	
TOTAL PARKING SPACES PROVIDED IN PARKING GARAGE (LEVELS 1-4)----- 408 CARS	

NOTE: ALL OF THE TENANT NAMES WHICH ARE INDICATED ON THIS PLAN REPRESENT THOSE LEASES WHICH ARE EXECUTED, OUT FOR SIGNATURE, IN NEGOTIATION, OR PROPOSED. ALL TENANTS ARE SUBJECT TO THE TERMS AND CONDITIONS OF THEIR RESPECTIVE LEASES. SQUARE FOOTAGES AND DIMENSIONS ARE APPROXIMATE AND SUBJECT TO FIELD VERIFICATION.

**LA FITNESS LEVEL 7
 LEASE PLAN
 CENTURY SHOPPING CENTRE**

CHICAGO, ILLINOIS

Bon Aviv Investments

MANAGED BY



231 MARKET STREET
 JOHNSTOWN, PA 15801
 (814) 254-4004
 a2zreinc.com

REAL ESTATE info@a2zreinc.com



DATE: 01/23/2018

LP-7

ROOM KEY
 (Circled number) - UNIT NUMBER
 0,000 S.F. - UNIT SQUARE FOOTAGE

COLOR KEY
 [Solid line] PERMANENT
 [Dashed line] TEMPORARY
 [Dotted line] AVAILABLE

DEVELOPMENT DATA

LEASABLE AREA	
CARDEN LEVEL	21,713 S.F.
FIRST LEVEL	15,663 S.F.
SECOND LEVEL	20,487 S.F.
THIRD LEVEL	7,000 S.F.
FOURTH LEVEL	21,814 S.F.
LANDMARK'S CENTURY CENTRE CHINA (LEVEL 5 & 6)	21,814 S.F.
LA FITNESS (LEVEL 7 & 8)	50,779 S.F.
OVERALL LEASABLE AREA	174,836 S.F.
LAND AREA	
	1.39 ACRES
TOTAL PARKING SPACES PROVIDED IN PARKING GARAGE LEVELS 1-4 408 CARS	

NOTE: ALL OF THE TENANT NAMES WHICH ARE INDICATED ON THIS PLAN REPRESENT THOSE LEASES WHICH ARE EXECUTED, OUT FOR SIGNATURE, IN NEGOTIATION, OR PROPOSED. ALL TENANTS ARE SUBJECT TO ALL APPLICABLE ORDINANCES AND ALL SQUARE FOOTAGES AND DIMENSIONS ARE APPROXIMATE AND SUBJECT TO FIELD VERIFICATION.

**LA FITNESS LEVEL 8
 LEASE PLAN
 CENTURY SHOPPING CENTRE**

CHICAGO, ILLINOIS

Bon Aviv Investments

MANAGED BY



231 MARKET STREET
 JOHNSTOWN, PA 15801
 (814) 254-4004
 a2zreinc.com

REAL ESTATE info@a2zreinc.com



DATE: 01/23/2018

LP-8

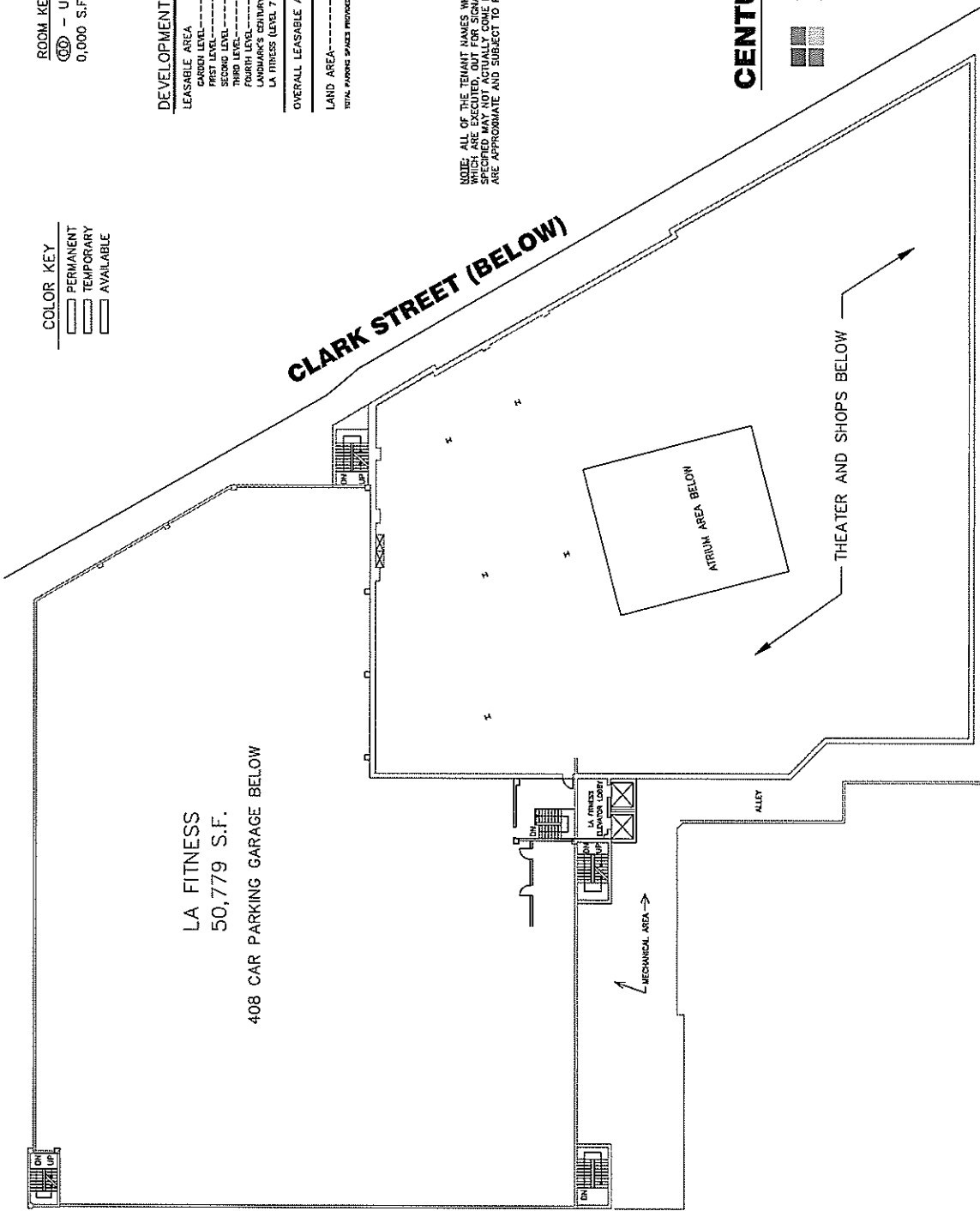

ORCHARD STREET BELOW

ADJACENT 408 CAR PARKING GARAGE
(LA FITNESS ABOVE LEVELS 7 & 8)

- COLOR KEY**
- PERMANENT
 - TEMPORARY
 - AVAILABLE

ROOM KEY
 (00) - UNIT NUMBER
 0,000 S.F. - UNIT SQUARE FOOTAGE

DEVELOPMENT DATA

LEASEABLE AREA	
GARAGE LEVEL	21,713 S.F.
FIRST LEVEL	15,983 S.F.
SECOND LEVEL	20,497 S.F.
THIRD LEVEL	19,814 S.F.
FOURTH LEVEL	19,814 S.F.
LANDMARK'S CENTURY CENTRE ONYX (LEVEL 5 & 6)	24,944 S.F.
LA FITNESS (LEVEL 7 & 8)	50,779 S.F.
OVERALL LEASEABLE AREA	174,836 S.F.
LAND AREA	
TOTAL PAVING SPACES PROVIDED IN PARKING GARAGE LEVELS 1-4	1.39 ACRES
	488 CARS

NOTE: ALL OF THE TENANT NAMES WHICH ARE INDICATED ON THIS PLAN REPRESENT THOSE LEASES WHICH ARE EXECUTED, OUT FOR SIGNATURE, IN NEGOTIATION, OR PROPOSED. ALL TENANTS ARE SUBJECT TO THE STANDARD LEASE TERMS AND CONDITIONS. ALL SQUARE FOOTAGES AND DIMENSIONS ARE APPROXIMATE AND SUBJECT TO FIELD VERIFICATION.

GARDEN LEVEL LEASE PLAN

CENTURY SHOPPING CENTRE

CHICAGO, ILLINOIS

Bon Aviv Investments

MANAGED BY

A&Z
 231 MARKET STREET
 JOHNSTOWN, PA 15901
 (814) 254-4004
 az@azreinc.com
 REAL ESTATE info@azreinc.com

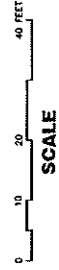

DATE: 03/20/2019

LP-G

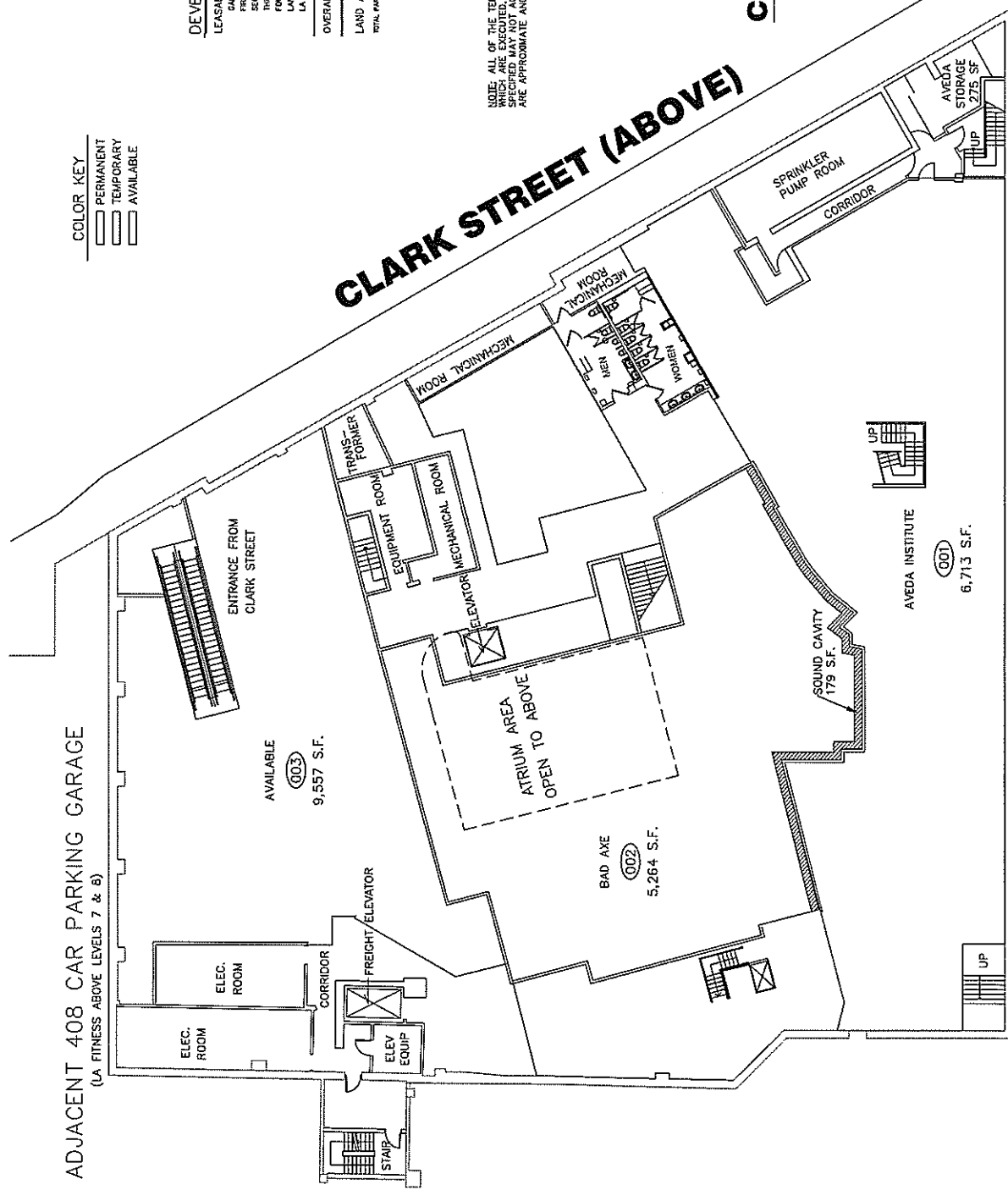

COLOR KEY
 [Solid Box] PERMANENT
 [Dashed Box] TEMPORARY
 [Hatched Box] AVAILABLE

ROOM KEY
 [Circle with Number] - UNIT NUMBER
 [Circle with Number] 0,000 S.F. - UNIT SQUARE FOOTAGE

DEVELOPMENT DATA

LEASABLE AREA	21,713 S.F.
FIRST LEVEL	15,148 S.F.
SECOND LEVEL	26,497 S.F.
THIRD LEVEL	21,336 S.F.
FOURTH LEVEL	19,914 S.F.
LANDMARKS CENTURY CENTRE CHEDIA (LEVEL 5 & 6)	24,944 S.F.
LA FITNESS (LEVEL 7 & 8)	52,779 S.F.
OVERALL LEASABLE AREA	174,836 S.F.
LAND AREA	1.39 ACRES
TOTAL PARKING SPACES PROVIDED IN PARKING GARAGE LEVELS 1-4	492 CARS

NOTE: ALL OF THE TENANT NAMES WHICH ARE INDICATED ON THIS PLAN REPRESENT THOSE LEASES WHICH ARE EXECUTED, OUT FOR SIGNATURE, IN NEGOTIATION, OR PROPOSED. ALL TENANTS SPECIFIED MAY NOT ACTUALLY COME INTO EXISTENCE. ALL SQUARE FOOTAGES AND DIMENSIONS ARE APPROXIMATE AND SUBJECT TO FIELD VERIFICATION.

CLARK STREET (BELOW)

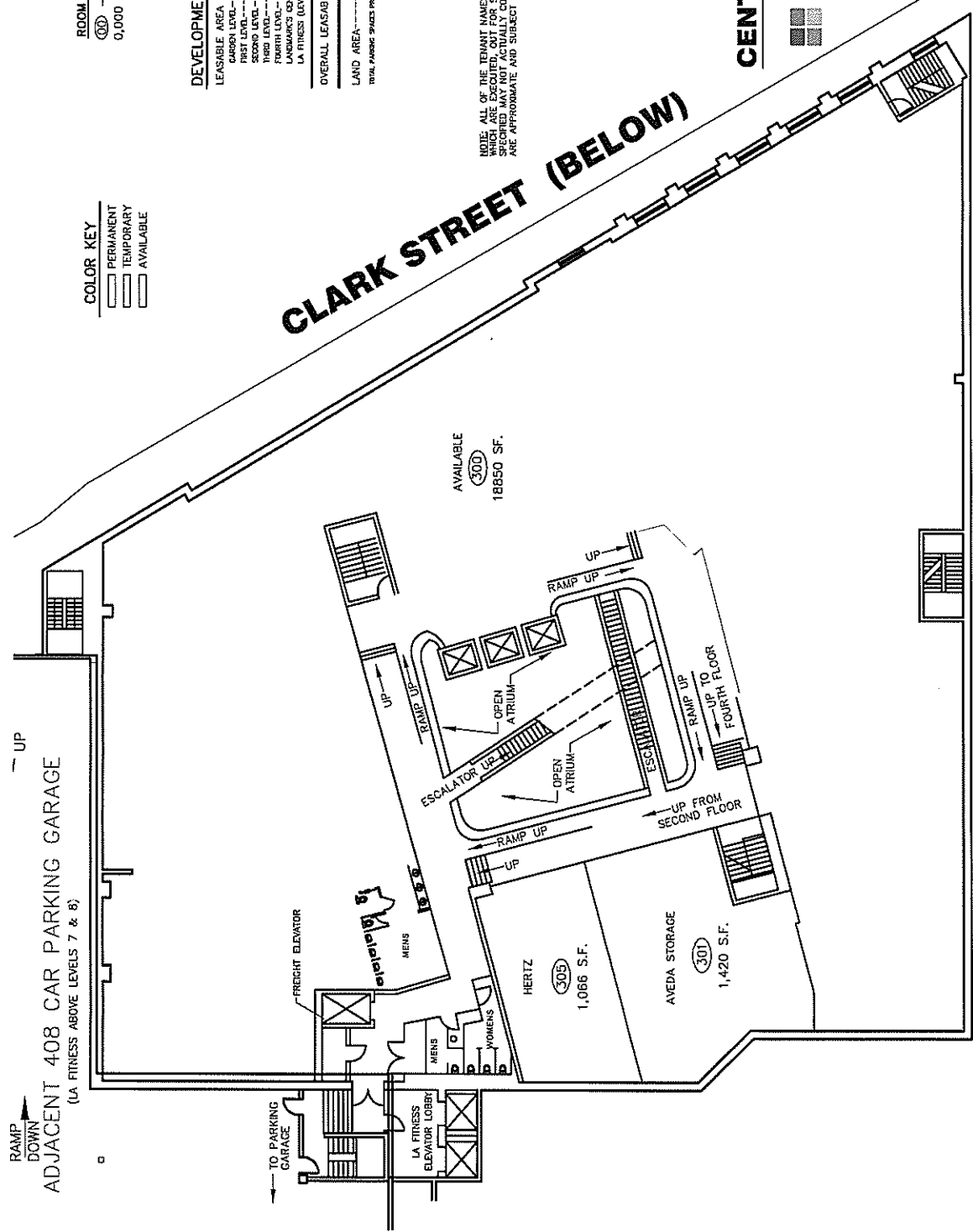

**THIRD LEVEL
LEASE PLAN**

CENTURY SHOPPING CENTRE

CHICAGO, ILLINOIS

Bon Aviv Investments

LEASED BY

ZAMIAS SERVICES INC

P.O. BOX #5540
 JOHNSTOWN, PA 15904
 TELE: (814)933-5563



SCALE

DATE: 03/14/2019

LP-3

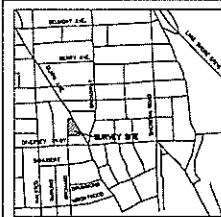

GREMLEY & BIEDERMANN

PLCS Corporation

License No. 01-00332

PROFESSIONAL LAND SURVEYORS

1525 NORTH ELSTON AVENUE, CHICAGO, IL 60640
 TELEPHONE: (773) 845-5122 EMAIL: INFO@PLCS-SURVEY.COM

Plat of Survey

GRAPHIC SCALE



Legend

- ⊙ Storm MH
- ⊙ Storm CB
- ⊙ Storm Inlet
- ⊙ Water MH
- ⊙ Telephone MH
- ⊙ Utility Pole
- ⊙ Electric MH
- ⊙ Electric Light Pole
- ⊙ Gas Valve
- ⊙ Gas MH
- ⊙ Sign Post
- ⊙ Undersized Manhole
- ⊙ Auto Sprinkler
- ⊙ Hose Connection
- ⊙ Bke Rock
- ⊙ Electric Meter

PARCEL 1: LOTS 1 AND 2 (EXCEPT THAT PART OF THE SOUTH 0.71 FEET AS MEASURED AT RIGHT ANGLES TO THE SOUTH LINE, 17.00 FEET, AS MEASURED ALONG THE SOUTH LINE OF SAID LOT 2) IN BRODMLEY'S SUBDIVISION OF THE EAST PART OF THE SOUTH HALF OF LOT 18 IN BICKERDING'S AND STEELE'S SUBDIVISION IN THE WEST HALF OF THE NORTHWEST QUARTER OF SECTION 28, TOWNSHIP 40 NORTH, RANGE 14, EAST OF THE THIRD PRINCIPAL MERIDIAN, IN COOK COUNTY, ILLINOIS.

PARCEL 2: LOTS 3, 4, 5, 6, 7 AND 8 IN THE SUBDIVISION OF THE NORTH HALF OF LOT 19 IN BICKERDING'S AND STEELE'S SUBDIVISION IN THE WEST HALF OF THE NORTHWEST QUARTER OF SECTION 28, TOWNSHIP 40 NORTH, RANGE 14, EAST OF THE THIRD PRINCIPAL MERIDIAN, IN COOK COUNTY, ILLINOIS.

PARCEL 3: THE EAST 207 FEET OF THE SOUTH HALF OF LOT 11 IN BICKERDING'S AND STEELE'S SUBDIVISION IN THE WEST HALF OF THE NORTHWEST QUARTER OF SECTION 28, TOWNSHIP 40 NORTH, RANGE 14, EAST OF THE THIRD PRINCIPAL MERIDIAN, IN COOK COUNTY, ILLINOIS.

PROPERTY AREA= 40,688 SQ. FT. OR 1.39 ACRES MORE OR LESS.
 GROSS AREA= 94,495 SQ. FT. OR 1.48 ACRES MORE OR LESS.
 AREA IN DEDICATED STREETS = 3,800 SQ. FT. OR 0.08 ACRES MORE OR LESS.

METER AND BOUNDS LEGAL DESCRIPTION:

BEGINNING AT THE INTERSECTION OF A LINE 0.71 FEET NORTH OF THE SOUTH LINE OF LOT 2 IN BRODMLEY'S SUBDIVISION AS SHOWN AT RIGHT ANGLES TO SAID SOUTH LINE AND THE WESTERLY LINE OF NORTHCLARK STREET; THENCE NORTH 89° 20' 20" WEST ALONG SAID LINE 0.71 FEET NORTH OF SAID SOUTH LINE, 48.13 FEET; THENCE SOUTH 89° 20' 20" EAST, 13.11 FEET TO THE SOUTH LINE OF SAID LOT 2; THENCE NORTH 89° 20' 20" WEST ALONG SAID SOUTH LINE OF LOT 2, 161.00 FEET TO THE SOUTHWEST CORNER OF LOT 3 IN BRODMLEY'S SUBDIVISION AS SHOWN; THENCE NORTH 89° 20' 20" EAST ALONG THE WEST LINE OF SAID LOT 3, 28.81 FEET TO THE SOUTH LINE OF LOT 1 IN SAID BRODMLEY'S SUBDIVISION; THENCE NORTH 89° 20' 20" WEST ALONG SAID SOUTH LINE OF LOT 1, 11.81 FEET TO THE SOUTHWEST CORNER OF LOT 1 IN BICKERDING'S & STEELE'S SUBDIVISION, 115.88 FEET EAST OF THE SOUTHWEST CORNER THEREOF; THENCE NORTH 89° 20' 20" WEST ALONG SAID SOUTH LINE OF LOT 1, 115.88 FEET TO THE EAST LINE OF NORTH ORCHARD STREET; THENCE NORTH 89° 20' 20" EAST ALONG SAID EAST LINE OF NORTH ORCHARD STREET, 182.33 FEET TO THE NORTHWEST CORNER OF LOT 18 IN RAWORTH & OTHERS' SUBDIVISION OF PARTS OF LOTS 11, 12, 13 AND 14 IN SAID BICKERDING'S & STEELE'S SUBDIVISION; THENCE SOUTH 89° 20' 20" WEST ALONG SAID WEST LINE OF LOT 18 AND THE NORTH LINE OF THE SOUTH HALF OF LOT 11 IN SAID BICKERDING'S & STEELE'S SUBDIVISION, 316.00 FEET TO THE NORTHWEST CORNER OF SAID LOT 11, BEING ALSO THE CENTERLINE OF NORTH CLARK STREET; THENCE SOUTH 29° 48' 30" EAST 118.08 FEET ALONG THE EASTERLY LINE OF SAID LOT 11 AND THE CENTERLINE OF NORTH CLARK STREET TO THE SOUTHWEST CORNER OF SAID LOT 11; THENCE NORTH 89° 20' 20" WEST, 38.32 FEET TO THE WEST LINE OF NORTH CLARK STREET; THENCE SOUTH 89° 20' 20" EAST ALONG THE WESTERLY LINE OF NORTH CLARK STREET, 383.22 FEET TO THE POINT OF BEGINNING, IN THE WEST HALF OF THE NORTHWEST QUARTER OF SECTION 28, TOWNSHIP 40 NORTH, RANGE 14, EAST OF THE THIRD PRINCIPAL MERIDIAN, IN COOK COUNTY, ILLINOIS.

CONTAINING 64.68 SQ. FT. OR 1.48 ACRES MORE OR LESS.

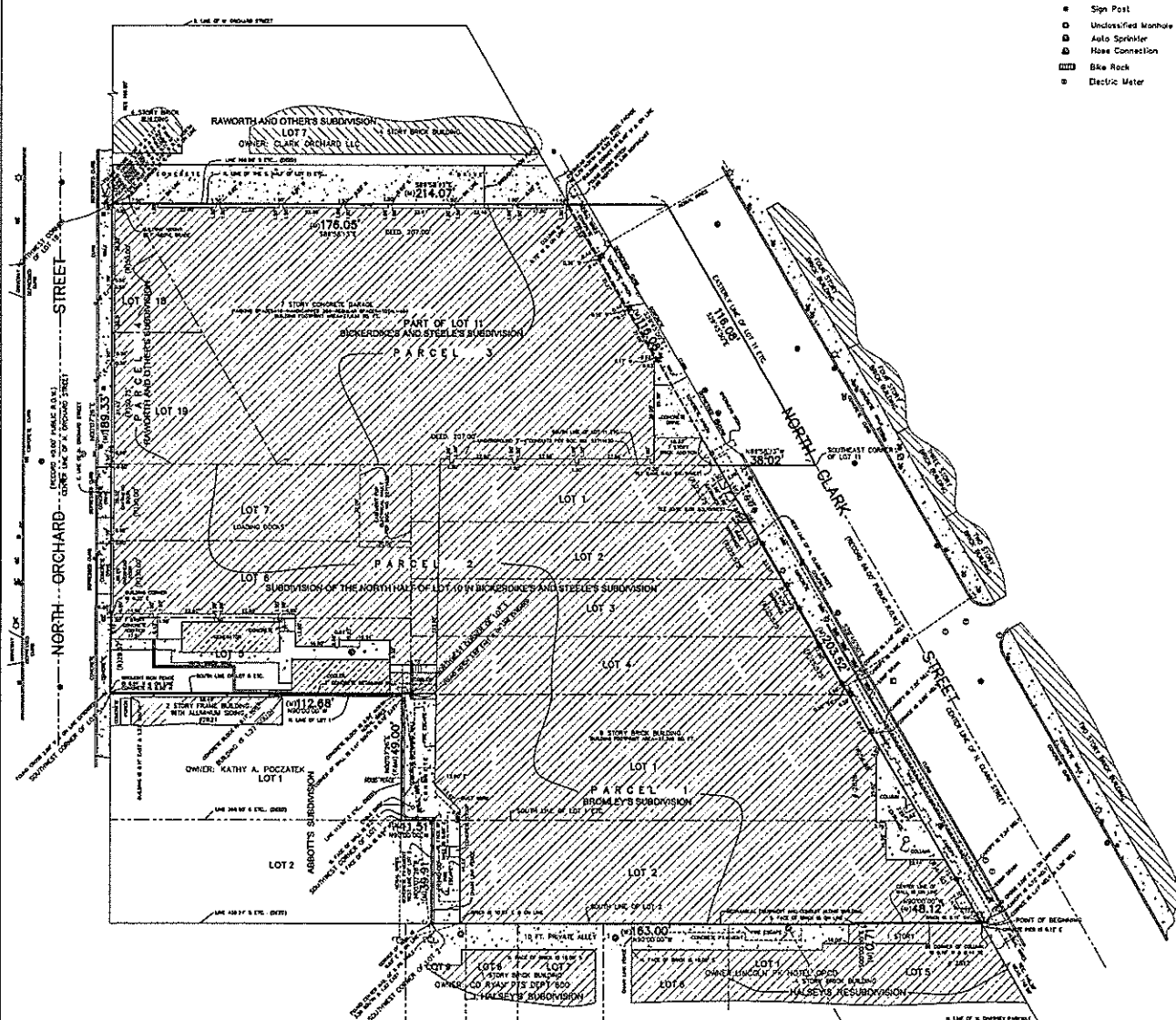

ORDERED BY: SAU DESIGN/LLC	ORDERED DATE: 09/18/2022	DATE: 09/18/2022	PLAT NO: 1 of 1
GREMLEY & BIEDERMANN PLCS Corporation License No. 01-00332 1525 North Elston Avenue, Chicago, IL 60640 Telephone: (773) 845-5122 Email: info@plcs-survey.com			
ORDER NO: 2022-30518-001	DATE: 09/18/2022	PLAT NO: 1 of 1	

SURVEY NOTES:
 SURVEYOR'S LICENSE EXPIRES November 30, 2023.
 THIS PLAT contains Record and Measured Distances respectively.
 Distances are marked in feet and decimal parts thereof. Corners at points BEFORE building by same and at same points as afterwards BEFORE damaged or built.
 For easements, building lines and other matters, not shown on survey, please refer to your abstract, deed, contract, the plat and the building line regulations.
 All dimensions shall be measured by some measurement unless the plat indicates otherwise.
 Measurements of all other parts shown are not to the contrary hereof.
 Unless otherwise noted, the Survey, Station, Boundary Data and Computed Data are in accordance with the standards for a boundary survey.
 COPYRIGHT © GREMLEY & BIEDERMANN, INC. 2022. All Rights Reserved.

STATE OF ILLINOIS
 COUNTY OF COOK

WE, GREMLEY & BIEDERMANN, INC. HEREBY CERTIFY THAT WE HAVE SURVEYED THE ABOVE DESCRIBED PROPERTY AND THAT THE PLAT HEREON DRAWN IS A CORRECT REPRESENTATION OF SAID SURVEY CONDUCTED TO A TEMPERATURE OF 60° FAHRENHEIT.

FIELD MEASUREMENTS COMPLETED ON SEPTEMBER 7, 2022.
 SIGNED ON SEPTEMBER 18, 2022.

BY: *[Signature]*

PROFESSIONAL ILLINOIS LAND SURVEYOR NO. 2822
 THIS PROFESSIONAL SERVICE CONFORMS TO THE CURRENT ILLINOIS MEASUREMENT STANDARDS FOR A BOUNDARY SURVEY.



14-28-115-011-0000
SONGTAO ZHAO & YUJUN P
2903 N BURLING ST
CHICAGO, IL 60657

14-28-115-012-0000
JOHN LEE
2901 N BURLING
CHICAGO, IL 60657

14-28-115-019-0000
BURLING BUILDING I LLC
2320 N DAMEN AVE STE1D
CHICAGO, IL 60647

14-28-115-021-0000
ERIC YEW
2821 N BURLING ST
CHICAGO, IL 60657

14-28-115-022-0000
EMIL PROPERTIES INC
2819 N BURLING ST
CHICAGO, IL 60657

14-28-115-023-0000
THE SUSAN & RICHARD GO
2817 N BURLING ST
CHICAGO, IL 60657

14-28-115-025-0000
SAWBILL PROPERTIES LLC
3080 N LINCOLN
CHICAGO, IL 60657

14-28-115-026-0000
SAWBILL PROPERTIES LLC
3080 N LINCOLN
CHICAGO, IL 60657

14-28-115-029-0000
MICHAEL SEBASKI
27 FERNCLIFF RD
SCARSDALE, NY 10583

14-28-115-031-0000
ORCHARD BLDG I LLC
2320 N DAMEN STE 1D
CHICAGO, IL 60647

14-28-115-032-0000
CHICAGO ORCHARD PTR II
PO BOX 4900
SCOTTSDALE, AZ 85261

14-28-115-033-0000
CHICAGO ORCHARD PTR II
PO BOX 4900
SCOTTSDALE, AZ 85261

14-28-115-034-0000
SHARON BUCKLEY
603 S WASHINGTON
ELMHURST, IL 60126

14-28-115-036-0000
CHICAGO ORCHARD PARTNE
PO BOX 4900 DEPT 128
SCOTTSDALE, AZ 85261

14-28-115-050-0000
KATHERINE MERRELL TRUS
2825 N BURLING ST
CHICAGO, IL 60657

14-28-115-051-0000
ERIC YEW
2821 N BURLING ST
CHICAGO, IL 60657

14-28-115-052-0000
ERIC YEW
2821 N BURLING ST
CHICAGO, IL 60657

14-28-115-057-1006
JOSEPH C MANI
2851 N BURLING ST #3S
CHICAGO, IL 60657

14-28-115-057-1008
DAVID PATTON PARKER JR
2851 N BURLING ST#2S
CHICAGO, IL 60657

14-28-115-057-1009
HOWELL JONATHAN
2853 N BURLING 1N
CHICAGO, IL 60657

14-28-115-057-1010
VICTORIA RONAN & JOSEP
2851 N BURLING ST #1S
CHICAGO, IL 60657

14-28-115-057-1011
ALAINA C COLE
2853 N BURLING ST#2N
CHICAGO, IL 60657

14-28-115-057-1012
BETH ERIN KASKEL
2853 N BURLING ST 3N
CHICAGO, IL 60657

14-28-115-059-0000
METROPOLITAN RENTAL
1839 N LINCOLN
CHICAGO, IL 60614

14-28-115-060-0000
RYAN A DESPERSIA
2929 N BURLING ST
CHICAGO, IL 60657

14-28-115-061-0000
SCOTT UHER
1429 HARBOUR WALK ROAD
TAMPA, FL 33602

14-28-115-062-0000
JACOB CHARLES PIERCE
2850 N ORCHARD ST
CHICAGO, IL 60657

14-28-115-063-1001
ROBERT PRICE
2837 N BURLING ST#1S
CHICAGO, IL 60657

14-28-115-063-1002
LYNDSEY KANTARSKI
2837 N BURLING #2S
CHICAGO, IL 60657

14-28-115-063-1003
AURA LICHTENBERG
2837 N BURLING ST#3S
CHICAGO, IL 60657

14-28-115-063-1004
MAI HONG
2837 N BURLING ST
CHICAGO, IL 60657

14-28-115-063-1005
STEPHANIE HETREA
8N ROSE STREET
LODI, CA 95240

14-28-115-063-1006
DEIRDRE LAVERDIERE AS
2839 N BURLING ST
CHICAGO, IL 60657

14-28-115-063-1007
STEPHANIE M CALDERON
2839 N BURLING 3N
CHICAGO, IL 60657

14-28-115-063-1008
HURON REALTY LLC
2623 N SHEFFIELD AVE3S
CHICAGO, IL 60614

14-28-115-064-0000
ANDY SCHCOLNIK
2035 W GIDDINGS ST
CHICAGO, IL 60625

14-28-115-065-0000
STEVE CGOURAS
4349 N KENMORE
CHICAGO, IL 60613

14-28-115-066-1001
ANNE KUEHL
2831 N BURLING ST#1S
CHICAGO, IL 60657

14-28-115-066-1002
NATALIE V LAU
616 W SURF ST #1
CHICAGO, IL 60657

14-28-115-066-1003
TYLER VIRGINIA MYERS
2831 N BURLING ST#3S
CHICAGO, IL 60657

14-28-115-066-1004
TYLER V MYERS & BRANDO
2831 N BURLING ST#GS
CHICAGO, IL 60657

14-28-115-066-1005
KELSEY HANRAHAN
2833 N BURLING ST#1N
CHICAGO, IL 60657

14-28-115-066-1006
BRETT WEBER
1 E SCOTT ST #2304
CHICAGO, IL 60610

14-28-115-066-1007
ANDREW FEDOR
2833 N BURLING ST 3N
CHICAGO, IL 60657

14-28-115-066-1008
KAIHTLYN E SCHLACHTER
2833 N BURLING ST #G
CHICAGO, IL 60657

14-28-115-067-1001
CHARLIE KEEL
2913 N BURLING
CHICAGO, IL 60657

14-28-115-067-1002
BRENT HOFFMANN
2911 N BURLING #2
CHICAGO, IL 60657

14-28-115-067-1003
GREGORY BRISSON
2911 N BURLING #3
CHICAGO, IL 60657

14-28-115-068-1001
B D BERMAN
2822 N ORCHARD 1
CHICAGO, IL 60657

14-28-115-068-1002
WESLEY SHAY HOWE
1701 LONG AVE
NASHVILLE, TN 37206

14-28-115-068-1003
TAXPAYER OF UNIT 3
2822N ORCHARD ST APT 3
CHICAGO, IL 60657

14-28-115-073-1001
LYSSA CHAVKA
2919 N BURLING ST
CHICAGO, IL 60657

14-28-115-073-1002
AMALIA FRANCES MARTINE
2919 N BURLING ST#B
CHICAGO, IL 60657

14-28-115-073-1003
BRIAN SONTAG
2919 N BURLING ST#C
CHICAGO, IL 60657

14-28-115-073-1004
ZACHARY COUGHLIN
2919 N BURLING ST#D
CHICAGO, IL 60657

14-28-115-073-1005
AMARJEET S BHACHU
2919 N BURLING ST #E
CHICAGO, IL 60657

14-28-115-073-1006
CHANGIL JEONG
2919 N BURLING ST#F
CHICAGO, IL 60657

14-28-115-073-1007
ALEXANDER & E EYGENSON
3300 CARRIAGE WAY 112
ARLINGTON HTS, IL 60004

14-28-115-073-1008
JOHN NEMETH
4080 EL PRADO BLVD
COCONUT GRV, FL 33133

14-28-115-073-1009
RYAN D SIEMERS
2919 N BURLING ST#I
CHICAGO, IL 60657

14-28-115-073-1010
JASON ECKERLY
2919 N BURLING ST
CHICAGO, IL 60657

14-28-115-074-1001
O & S AKPOLAT
2931 WHITE PINE DR
NORTHBROOK, IL 60062

14-28-115-074-1002
CHRISTY J BENTON
2860 N ORCHARD 202
CHICAGO, IL 60657

14-28-115-074-1003
CHRISTINE SEIBERLICH
2860 N ORCHARD ST 203
CHICAGO, IL 60657

14-28-115-074-1004
GABRIEL NIEVES
2860 N ORCHARD ST#204
CHICAGO, IL 60657

14-28-115-074-1005
LAM NGUYEN
2860 N ORCHARD ST#301
CHICAGO, IL 60657

14-28-115-074-1006
ELIZABETH LOWRY
2860 N ORCHARD ST#302
CHICAGO, IL 60657

14-28-115-074-1007
ECE TZOUMAS
2001 W ERIE ST
CHICAGO, IL 60612

14-28-115-074-1008
DIANE PATRICK THOMAS
2860 N ORCHARD ST 304
CHICAGO, IL 60657

14-28-115-074-1009
GYE YOUNG PARK
2860 N ORCHARD ST#401
CHICAGO, IL 60657

14-28-115-074-1010
YAN SUN
3416 CURLING POND CT
CRYSTAL LAKE, IL 60012

14-28-115-074-1011
RAJIVE TANDON
3304 KELLER LANE
NAPERVILLE, IL 60565

14-28-115-074-1012
SAMANTHA LEIGH FOX
2860 N ORCHARD ST#404
CHICAGO, IL 60657

14-28-115-074-1013
JANET G BISCHOFF & CAI
2860 N ORCHARD ST#501
CHICAGO, IL 60657

14-28-115-074-1014
ROBERT & K FLEMING
2860 N ORCHARD 502
CHICAGO, IL 60657

14-28-115-074-1015
JOEL RABINOWITZ
2860 N ORCHARD ST#503
CHICAGO, IL 60657

14-28-115-074-1016
CHRISTINE SEIBERLICH
2860 N ORCHARD ST 203
CHICAGO, IL 60657

14-28-115-074-1017
DIANE THOMAS
2860 N ORCHARD ST 304
CHICAGO, IL 60657

14-28-115-074-1018
ROBERT & K FLEMING
2860 N ORCHARD 502
CHICAGO, IL 60657

14-28-115-074-1019
SAMANTHA LEIGH FOX
2860 N ORCHARD ST#404
CHICAGO, IL 60657

14-28-115-074-1020
GABRIEL NIEVES
2860 N ORCHARD ST#204
CHICAGO, IL 60657

14-28-115-074-1021
STEPHEN VAN PELT
2860 N ORCHARD ST #302
CHICAGO, IL 60657

14-28-115-074-1022
JOEL RABINOWITZ
2860 N ORCHARD ST#503
CHICAGO, IL 60657

14-28-115-074-1023
RAJIVE TANDON
2860 N ORCHARD ST 403
CHICAGO, IL 60657

14-28-115-074-1024
ELIZABETH LOWRY
2860 N ORCHARD ST#302
CHICAGO, IL 60657

14-28-115-074-1025
O & S AKPOLAT
2931 WHITE PINE DR
NORTHBROOK, IL 60062

14-28-115-074-1026
LAM NGUYEN
2860 N ORCHARD ST#301
CHICAGO, IL 60657

14-28-115-074-1027
GYE YOUNG PARK
2860 N ORCHARD ST#401
CHICAGO, IL 60657

14-28-115-074-1028
YAN SUN
2860 N ORCHARD ST #402
CHICAGO, IL 60657

14-28-115-074-1029
ECE TZOUMAS
2001 W ERIE ST
CHICAGO, IL 60612

14-28-115-074-1030
STEVEN A KNOR TRUST
2859 N BURLING ST#1C
CHICAGO, IL 60657

14-28-115-074-1031
SHARON L BUCKLEY
603 WASHINGTON
ELMHURST, IL 60126

14-28-115-074-1032
SANDRA HEBENSTREIT
2857 N BURLING ST 1S
CHICAGO, IL 60657

14-28-115-074-1033
TRUPTI DESAI
2861 N BURLING ST#IN
CHICAGO, IL 60657

14-28-115-074-1034
BERNARD J BRUNSMAN
2901 N BURLING ST
CHICAGO, IL 60657

14-28-115-074-1035
BERNARD J BRUNSMAN
2901 N BURLING ST
CHICAGO, IL 60657

14-28-115-074-1036
KELLY JUNG
2861 N BURLING ST 2N
CHICAGO, IL 60657

14-28-115-074-1037
KIRSTIN ANN MILTON
2859 N BURLING ST3C
CHICAGO, IL 60657

14-28-115-074-1038
DAMANI Y SEALE
245 E 124TH ST APT 8E
NEW YORK, NY 10035

14-28-115-074-1039
DAMANI Y SEALE
245 E 124TH ST APT 8E
NEW YORK, NY 10035

14-28-115-074-1040
DAMANI Y SEALE
245 E 124TH ST APT 8E
NEW YORK, NY 10035

14-28-115-074-1041
JANICE KNIGHT
2857 N BURLING ST 2S
CHICAGO, IL 60657

14-28-115-074-1042
CHRISTY J BENTON
2860 N ORCHARD 202
CHICAGO, IL 60657

14-28-115-074-1043
JENNA A MORRIS
2861 N BURLING ST #3N
CHICAGO, IL 60657

14-28-115-074-1044
KATHERINE MERRELL
2825 N BURLING ST
CHICAGO, IL 60657

14-28-115-074-1045
VLADIMIR KRAVCHENKO
2859 N BURLING ST 2C
CHICAGO, IL 60657

14-28-115-075-0000
CAREY ELDER
2862 N ORCHARD ST
CHICAGO, IL 60657

14-28-115-076-0000
DYLAN RICHARDSON
2864 N ORCHARD ST
CHICAGO, IL 60657

14-28-115-077-0000
DWIGHT DEPPEN
2866 N ORCHARD
CHICAGO, IL 60657

14-28-115-078-0000
JUAN AND DAVID ROESNER
514 AMERICAS WAY 19433
BOX ELDER, SD 57719

14-28-115-079-0000
JENNIFER K LEHMAN
2862 N ORCHARD ST
CHICAGO, IL 60657

14-28-115-080-0000
MICHAEL PENCE
2864 N ORCHARD ST
CHICAGO, IL 60657

14-28-115-081-0000
DWIGHT DEPPEN
2866 N ORCHARD
CHICAGO, IL 60657

14-28-115-082-0000
JUAN AND DAVID ROESNER
514 AMERICAS WAY 19433
BOX ELDER, SD 57719

14-28-115-083-1001
TRUPTI DESAI
2861 N BURLING ST#IN
CHICAGO, IL 60657

14-28-115-083-1002
STEVEN A KNOR TRUST
2859 N BURLING ST#1C
CHICAGO, IL 60657

14-28-115-083-1003
SANDRA L HEBENSTREIT
2857 N BURLING 1S
CHICAGO, IL 60657

14-28-115-083-1004
KELLY S JUNG LIVING TR
2861 N BURLING ST#2N
CHICAGO, IL 60657

14-28-115-083-1005
VLADIMIR KRAVCHENKO
2859 N BURLING ST 2C
CHICAGO, IL 60657

14-28-115-083-1006
JANICE KNIGHT
2857 N BURLING 2S
CHICAGO, IL 60657

14-28-115-083-1007
JENNA A MORRIS
2861 N BURLING ST #3N
CHICAGO, IL 60657

14-28-115-083-1008
KRISTIN ANN MILTON
2859 N BURLING ST 3C
CHICAGO, IL 60657

14-28-115-083-1009
RYAN S SELLEY
2857 N BURLING ST#3S
CHICAGO, IL 60657

14-28-115-084-0000
700 W DIVERSEY LLC
9229 N OKETO
MORTON GROVE, IL 60053

14-28-115-085-0000
700 W DIVERSEY LLC
9229 N OKETO
MORTON GROVE, IL 60053

14-28-115-087-1001
SUSAN E LARSON
2849 N BURLING ST#1
CHICAGO, IL 60657

14-28-115-087-1002
CHARLES ARCHER
2849 N BURLING ST#2
CHICAGO, IL 60657

14-28-115-087-1003
BENJAMIN E SEDRISH
2849 N BURLING ST#3
CHICAGO, IL 60657

14-28-115-087-1004
MATTHEW BENSON
2849 N BURLING ST #G
CHICAGO, IL 60657

14-28-115-087-1005
SUSAN E LARSON
2849 N BURLING ST#1
CHICAGO, IL 60657

14-28-115-087-1006
CHARLES ARCHER
2849 N BURLING ST#2
CHICAGO, IL 60657

14-28-115-087-1007
BOWEN DAN
2845 N BURLING ST #1N
CHICAGO, IL 60657

14-28-115-087-1008
BENJAMIN E SEDRISH
2849 N BURLING ST#3
CHICAGO, IL 60657

14-28-115-088-1001
GEORGIA C NESTER
2845 N BURLING ST#GN
CHICAGO, IL 60657

14-28-115-088-1002
EMMA M EVANS
2843 N BURLING ST#GS
CHICAGO, IL 60657

14-28-115-088-1003
SANIBH ARYAN
2845 N BURLING ST#1N
CHICAGO, IL 60657

14-28-115-088-1004
DANIEL OVAERT
2843 N BURLING STREET
CHICAGO, IL 60657

14-28-115-088-1005
C THUNANDER & C FINN
2845 N BURLING #2N
CHICAGO, IL 60657

14-28-115-088-1006
DAVID JONES
2843 N BURLING ST#2S
CHICAGO, IL 60657

14-28-115-088-1007
LAUCK OLSON
2845 N BURLING ST 3N
CHICAGO, IL 60657

14-28-115-088-1008
KATHERINE A MCALLISTER
2843 N BURLING ST#3S
CHICAGO, IL 60657

14-28-115-089-1001
STACY FORSYTHE
2800 N ORCHARD ST#807
CHICAGO, IL 60657

14-28-115-089-1002
KRISTIE SMITH
2800 N ORCHARD ST#809
CHICAGO, IL 60657

14-28-115-089-1003
MICHAEL D MILSTEAD
2800 N ORCHARD ST #805
CHICAGO, IL 60657

14-28-115-089-1004
PAUL WEAKLEY
2490 W REYNOLDS RD
BLOOMINGTON, IN 47404

14-28-115-089-1005
JOEL JACKSON
2800 N ORCHARD ST 602
CHICAGO, IL 60657

14-28-115-089-1006
JOEL JACKSON
2800 N ORCHARD ST 602
CHICAGO, IL 60657

14-28-115-089-1007
ROBERT ADAM WIETECKI
2800 N ORCHARD ST#802
CHICAGO, IL 60657

14-28-115-089-1008
ANTHONY NEGRI
2855 N MILDRED AV #35
CHICAGO, IL 60657

14-28-115-089-1009
SOPHIA PARHAS
2800 N ORCHARD #609
CHICAGO, IL 60657

14-28-115-089-1010
CHRISTINE YANG
2800 N ORCHARD ST
CHICAGO, IL 60657

14-28-115-089-1011
2800 NORTH ORCHARD LLC
2800 N. ORCHARD
CHICAGO, IL 60657

14-28-115-089-1012
ISRAEL & SYLVIA FINGER
4816 GREEN ACRES CT
METAIRIE, LA 70003

14-28-115-089-1013
T & D ENGLEHART
2800 N ORCHARD #905
CHICAGO, IL 60657

14-28-115-089-1014
TYLER WADE BAUM
2800 N ORCHARD ST#909
CHICAGO, IL 60657

14-28-115-089-1015
WENDY LAWLER
2800 N ORCHARD ST #903
CHICAGO, IL 60657

14-28-115-089-1016
SHIBU JOSEPH & MAINAKI
3944 N PROCTOR CIR
ARLINGTON HTS, IL 60004

14-28-115-089-1017
SUSAN PARKER
812 STRAWBERRY HILL
GLENCOE, IL 60022

14-28-115-089-1018
STEVEN N JACKSON
2800 N ORCHARD ST #902
CHICAGO, IL 60657

14-28-115-089-1019
POLINA JORDANOVA
36 HARRISON DR
LARCHMONT, NY 10538

14-28-115-089-1020
MATILDE OJEDA
5855 N SHERIDAN #15K
CHICAGO, IL 60660

14-28-115-089-1021
TAXPAYER OF
2800 N ORCHARD
CHICAGO, IL 60657

14-28-115-089-1022
CHRISTINE HSING
1107 ASHLEY LN
INVERNESS, IL 60010

14-28-115-089-1023
ANNELI ALERS
2800 N ORCHARD 908
CHICAGO, IL 60657

14-28-115-089-1024
MARY KATE HUFFMAN
521 POND GATE DR
BARRINGTON, IL 60010

14-28-115-089-1025
PETER BROUSALIS & HEAT
2800 N ORCHARD ST#503
CHICAGO, IL 60657

14-28-115-089-1026
2800 NORTH ORCHARD LLC
2800 N. ORCHARD
CHICAGO, IL 60657

14-28-115-089-1027
GUILLERMO AMEER
3136 N ORCHARD ST #1
CHICAGO, IL 60657

14-28-115-089-1028
2800 NORTH ORCHARD LLC
2800 N. ORCHARD
CHICAGO, IL 60657

14-28-115-089-1029
ALEX HANNS
2800 N ORCHARD ST#302
CHICAGO, IL 60657

14-28-115-089-1030
ELANA SCHUMAN
789 HORATIO BLVD
BUFFALO GROV, IL 60089

14-28-115-089-1031
REID FRYE
2800 N ORCHARD ST#408
CHICAGO, IL 60657

14-28-115-089-1032
SCOTT OTTENHEIMER P32
2800 N ORCHARD ST #907
CHICAGO, IL 60657

14-28-115-089-1033
WILLIAM D MCGUIRE TTEE
171 RIVERSIDE DR
NORTHFIELD, IL 60093

14-28-115-089-1034
2800 NORTH ORCHARD LLC
2800 N. ORCHARD
CHICAGO, IL 60657

14-28-115-089-1035
LAUREN ABATO
2800 N ORCHARD ST#508
CHICAGO, IL 60657

14-28-115-089-1036
SACHIN B SURESH
2208 N SOUTHPORT AVE
CHICAGO, IL 60614

14-28-115-089-1037
PURPLE CARNATIONS LLC
7143 FOSTER ST
MORTON GROVE, IL 60053

14-28-115-089-1038
2800 ORCHARD LLC
7125 HEADLEY ST BOX213
ADA, MI 49301

14-28-115-089-1039
JULIE ENGELMAN
2800 N ORCHARD ST #607
CHICAGO, IL 60657

14-28-115-089-1040
GLENN PREMINGER
321 CIRCLE PARK PLACE
CHAPEL HILL, NC 27517

14-28-115-089-1041
JAMES STUDNICKA
200 W GRAND 2602
CHICAGO, IL 60654

14-28-115-089-1042
JAMES STUDNICKA
200 W GRAND AVE 2602
CHICAGO, IL 60654

14-28-115-089-1043
JASON C RUPP UNIT 309
2800 N ORCHARD STREET
CHICAGO, IL 60657

14-28-115-089-1044
2800 NORTH ORCHARD LLC
2800 N. ORCHARD
CHICAGO, IL 60657

14-28-115-089-1045
MAGER CHICAGO LLC
2800 N ORCHARD ST#409
CHICAGO, IL 60657

14-28-115-089-1046
JENNIFER L VUCKOVICH
2800 N ORCHARD ST#510
CHICAGO, IL 60657

14-28-115-089-1047
L & V TENNERELLI
2130 W IRVING PK RD 2
CHICAGO, IL 60618

14-28-115-089-1048
ANITA RAO
4423 123RD AVE SE
BELLEVUE, WA 98006

14-28-115-089-1049
KAREN S TOLLOFF
2800 N ORCHARD ST 301
CHICAGO, IL 60657

14-28-115-089-1050
MICHELLE HUIZENGA
2800 N ORCHARD #407
CHICAGO, IL 60657

14-28-115-089-1051
JOSEPH AIELLO
1713 JULIET LANE
LIBERTYVILLE, IL 60048

14-28-115-089-1052
ERIC R MCCANN
2800 N ORCHARD #808
CHICAGO, IL 60657

14-28-115-089-1053
TOM NJEGOVAN 4501
235 W VAN BUREN ST
CHICAGO, IL 60607

14-28-115-089-1054
ALI HASANALI
2800 N ORCHARD ST#707
CHICAGO, IL 60657

14-28-115-089-1055
2800 NORTH ORCHARD LLC
2800 N. ORCHARD
CHICAGO, IL 60657

14-28-115-089-1056
PURPLE CARNATIONS LLC
7143 FOSTER ST
MORTON GROVE, IL 60053

14-28-115-089-1057
PURPLE CARNATIONS LLC
7143 FOSTER ST
MORTON GROVE, IL 60053

14-28-115-089-1058
MICHAEL V PHAM
2800 N ORCHARD ST#501
CHICAGO, IL 60657

14-28-115-089-1059
MICHAEL V PHAM
2800 N ORCHARD ST#501
CHICAGO, IL 60657

14-28-115-089-1060
DEBRA ARTERBURY
3364 JAMES CT SW
PRIOR LAKE, MN 55372

14-28-115-089-1061
KAREN S TOLLOFF
2800 N ORCHARD ST 301
CHICAGO, IL 60657

14-28-115-089-1062
ALEX HANNS
2800 N ORCHARD ST#302
CHICAGO, IL 60657

14-28-115-089-1063
MARY KATE HUFFMAN
521 POND GATE DR
BARRINGTON, IL 60010

14-28-115-089-1064
2800 NORTH ORCHARD LLC
2800 N. ORCHARD
CHICAGO, IL 60657

14-28-115-089-1065
PURPLE CARNATIONS LLC
7143 FOSTER ST
MORTON GROVE, IL 60053

14-28-115-089-1066
2800 NORTH ORCHARD LLC
2800 N. ORCHARD
CHICAGO, IL 60657

14-28-115-089-1067
2800 NORTH ORCHARD LLC
2800 N. ORCHARD
CHICAGO, IL 60657

14-28-115-089-1068
2800 NORTH ORCHARD LLC
2800 N. ORCHARD
CHICAGO, IL 60657

14-28-115-089-1069
JASON C RUPP
2800 N ORCHARD ST #309
CHICAGO, IL 60657

14-28-115-089-1070
JASON C RUPP UNIT 309
2800 N ORCHARD STREET
CHICAGO, IL 60657

14-28-115-089-1071
MATTHEW MORENO
1675 YORK AVENUE 9D
NEW YORK, NY 10128

14-28-115-089-1072
CHRISTINE HSING
1107 ASHLEY LN
INVERNESS, IL 60010

14-28-115-089-1073
2800 NORTH ORCHARD LLC
2800 N. ORCHARD
CHICAGO, IL 60657

14-28-115-089-1074
2800 ORCHARD LLC
7125 HEADLEY ST BOX213
ADA, MI 49301

14-28-115-089-1075
PURPLE CARNATIONS SERI
7143 FOSTER ST
MORTON GROVE, IL 60053

14-28-115-089-1076
DEBRA ROMZ ARTERBURY &
2800 N ORCHARD ST#406
CHICAGO, IL 60657

14-28-115-089-1077
MICHELLE HUIZENGA
2800 N ORCHARD #407
CHICAGO, IL 60657

14-28-115-089-1078
REID FRYE
2800 N ORCHARD ST#408
CHICAGO, IL 60657

14-28-115-089-1079
REID FRYE
2800 N ORCHARD ST#408
CHICAGO, IL 60657

14-28-115-089-1080
MAGER CHICAGO LLC
2800 N ORCHARD ST#409
CHICAGO, IL 60657

14-28-115-089-1081
MAGER CHICAGO LLC
2800 N ORCHARD ST#409
CHICAGO, IL 60657

14-28-115-089-1082
ELIZABETH RANNO
2800 N ORCHARD #410
CHICAGO, IL 60657

14-28-115-089-1083
MICHAEL V PHAM
2800 N ORCHARD ST#501
CHICAGO, IL 60657

14-28-115-089-1084
GLENN M PREMINGER
321 CIRCLE PARK PLACE
CHAPEL HILL, NC 27517

14-28-115-089-1085
PETER BROUSALIS & HEAT
2800 N ORCHARD ST#503
CHICAGO, IL 60657

14-28-115-089-1086
SUSAN PARKER
812 STRAWBERRY HILL
GLENCOE, IL 60022

14-28-115-089-1087
PRESTON L YOUNG
2800 N ORCHARD ST 507
CHICAGO, IL 60657

14-28-115-089-1088
LAUREN ABATO
2800 N ORCHARD ST#508
CHICAGO, IL 60657

14-28-115-089-1089
LAUREN ABATO
2800 N ORCHARD ST#508
CHICAGO, IL 60657

14-28-115-089-1090
SHIBU JOSEPH & MAINAKI
3944 N PROCTOR CIR
ARLINGTON HTS, IL 60004

14-28-115-089-1091
SHIBU JOSEPH & MAINAKI
3944 N PROCTOR CIR
ARLINGTON HTS, IL 60004

14-28-115-089-1092
JENNIFER L VUCKOVICH
2800 N ORCHARD ST#510
CHICAGO, IL 60657

14-28-115-089-1093
GUILLERMO AMEER
3136 N ORCHARD ST #1
CHICAGO, IL 60657

14-28-115-089-1094
JOEL JACKSON
2800 N ORCHARD ST 602
CHICAGO, IL 60657

14-28-115-089-1095
SACHIN B SURESH
2208 N SOUTHPORT AVE
CHICAGO, IL 60614

14-28-115-089-1096
ISRAEL & SYLVIA FINGER
4816 GREEN ACRES CT
METAIRIE, LA 70003

14-28-115-089-1097
JULIE ENGELMAN
2800 N ORCHARD ST #607
CHICAGO, IL 60657

14-28-115-089-1098
POLINA JORDANOVA
36 HARRISON DR
LARCHMONT, NY 10538

14-28-115-089-1099
POLINA JORDANOVA
36 HARRISON DR
LARCHMONT, NY 10538

14-28-115-089-1100
SOPHIA PARHAS
2800 N ORCHARD #609
CHICAGO, IL 60657

14-28-115-089-1101
SOPHIA PARHAS
2800 N ORCHARD #609
CHICAGO, IL 60657

14-28-115-089-1102
THOMAS JOHN NJEGOVAN
235 W VAN BUREN #4501
CHICAGO, IL 60607

14-28-115-089-1103
WILLIAM D MCGUIRE TTEE
171 RIVERSIDE DR
NORTHFIELD, IL 60093

14-28-115-089-1104
ELANA SCHUMAN
789 HORATIO BLVD
BUFFALO GROV, IL 60089

14-28-115-089-1105
ERIL BROXTERMAN
2800 N ORCHARD #703
CHICAGO, IL 60657

14-28-115-089-1106
JOSEPH AIELLO
1713 JULIET LANE
LIBERTYVILLE, IL 60048

14-28-115-089-1107
ALI HASANALI
2800 N ORCHARD ST#707
CHICAGO, IL 60657

14-28-115-089-1108
JAMES STUDNICKA
200 W GRAND AVE 2602
CHICAGO, IL 60654

14-28-115-089-1109
JAMES STUDNICKA
200 W GRAND AVE 2602
CHICAGO, IL 60654

14-28-115-089-1110
PAUL WEAKLEY
2490 W REYNOLDS RD
BLOOMINGTON, IN 47404

14-28-115-089-1111
PAUL WEAKLEY
2490 W REYNOLDS RD
BLOOMINGTON, IN 47404

14-28-115-089-1112
ANTHONY NEGRI
2855 N MILDRED AV #35
CHICAGO, IL 60657

14-28-115-089-1113
L & V TENNERELLI
2130 W IRVING PK RD 2
CHICAGO, IL 60618

14-28-115-089-1114
ROBERT ADAM WIETECKI
2800 N ORCHARD ST#802
CHICAGO, IL 60657

14-28-115-089-1115
ANITA RAO
4423 123RD AVE SE
BELLEVUE, WA 98006

14-28-115-089-1116
MICHAEL D MILSTEAD
2800 N ORCHARD ST #805
CHICAGO, IL 60657

14-28-115-089-1117
STACY FORSYTHE
2800 N ORCHARD ST#807
CHICAGO, IL 60657

14-28-115-089-1118
ERIC R MCCANN
2800 N ORCHARD #808
CHICAGO, IL 60657

14-28-115-089-1119
ERIC R MCCANN
2800 N ORCHARD #808
CHICAGO, IL 60657

14-28-115-089-1120
KRISTIE SMITH
2800 N ORCHARD ST#809
CHICAGO, IL 60657

14-28-115-089-1121
KRISTIE SMITH
2800 N ORCHARD ST#809
CHICAGO, IL 60657

14-28-115-089-1122
JAISHRI ATRI
2800 N ORCHARD ST#810
CHICAGO, IL 60657

14-28-115-089-1123
CHRISTINE YANG
2800 N ORCHARD ST
CHICAGO, IL 60657

14-28-115-089-1124
STEVEN N JACKSON
2800 N ORCHARD ST #902
CHICAGO, IL 60657

14-28-115-089-1125
WENDY LAWLER
2800 N ORCHARD ST #903
CHICAGO, IL 60657

14-28-115-089-1126
T & D ENGLEHART
2800 N ORCHARD #905
CHICAGO, IL 60657

14-28-115-089-1127
SCOTT A OTTENHEIMER
2800 N ORCHARD ST #907
CHICAGO, IL 60657

14-28-115-089-1128
ANNELI ALERS
2800 N ORCHARD 908
CHICAGO, IL 60657

14-28-115-089-1129
ANNELI ALERS
2800 N ORCHARD 908
CHICAGO, IL 60657

14-28-115-089-1130
TYLER WADE BAUM
2800 N ORCHARD ST#909
CHICAGO, IL 60657

14-28-115-089-1131
TYLER WADE BAUM
2800 N ORCHARD ST#909
CHICAGO, IL 60657

14-28-115-089-1132
2800 NORTH ORCHARD LLC
2800 N. ORCHARD
CHICAGO, IL 60657

14-28-115-090-1001
KIMBERLY EBERL
2828 N ORCHARD ST
CHICAGO, IL 60657

14-28-115-090-1002
ORCHARD ST ACQUISITION
2828 N. ORCHARD
CHICAGO, IL 60657

14-28-115-090-1003
SKANDER DJERAI
2828 N ORCHARD ST 2F
CHICAGO, IL 60657

14-28-115-090-1004
MATTHEW THOMAS
2828 N ORCHARD ST#3
CHICAGO, IL 60657

14-28-115-090-1005
DANIEL&EMILY WAITZMAN
2826 N ORCHARD UNIT CH
CHICAGO, IL 60657

14-28-115-090-1006
ALEXANDER KRUEGER
2828 N ORCHARD ST 1F
CHICAGO, IL 60657

14-28-119-001-0000
CHICAGO CLARK PARTNERS
PO BOX 4900 DEPT 128
SCOTTSDALE, AZ 85261

14-28-119-002-0000
CLARK ORCHARD LLC
1 RIVERSHIRE LN
LINCOLNSHIRE, IL 60069

14-28-119-008-0000
BAI CENTURY LLC
720 E PALISADE AVE 201
ENGLEWD CLFS, NJ 76323

14-28-119-013-0000
676 W DIVERSEY LLC
676 W DIVERSEY PKWY
CHICAGO, IL 60614

14-28-119-014-0000
674 DIVERSEY LLC
674 W DIVERSEY
CHICAGO, IL 60614

14-28-119-015-0000
PARADISE CLIFFS LLC
150 N MICHIGAN #2700
CHICAGO, IL 60601

14-28-119-016-0000
PARADISE CLIFFS LLC
150 N MICHIGAN #2700
CHICAGO, IL 60601

14-28-119-017-0000
PARADISE CLIFFS LLC
150 N MICHIGAN #2700
CHICAGO, IL 60601

14-28-119-018-0000
CO RYAN PTS DEPT 800
PO BOX 460169
HOUSTON, TX 77056

14-28-119-019-0000
CO RYAN PTS DEPT 800
PO BOX 460169
HOUSTON, TX 77056

14-28-119-024-0000
BAI CENTURY LLC
720 E PALISADE AVE 201
ENGLEWD CLFS, NJ 76323

14-28-119-025-0000
LINCOLN PK HOTEL OPCO
644 W DIVERSEY PKWY
CHICAGO, IL 60614

14-28-119-026-0000
KATHY A POCZATEK
2821 N ORCHARD
CHICAGO, IL 60657

14-28-119-028-0000
KATHY POCZATEK
2821 N ORCHARD
CHICAGO, IL 60657

14-28-119-030-0000
BAI CENTURY LLC
720 E PALISADE AVE 201
ENGLEWD CLFS, NJ 76323

14-28-119-031-0000
BAI CENTURY LLC
720 E PALISADE AVE 201
ENGLEWD CLFS, NJ 76323

14-28-119-032-0000
BAI CENTURY LLC
720 E PALISADE AVE 201
ENGLEWD CLFS, NJ 76323

14-28-119-033-0000
BAI CENTURY LLC
720 E PALISADE AVE 201
ENGLEWD CLFS, NJ 76323

14-28-119-034-0000
BAI CENTURY LLC
720 E PALISADE AVE 201
ENGLEWD CLFS, NJ 76323

14-28-119-035-0000
BAI CENTURY LLC
720 E PALISADE AVE 201
ENGLEWD CLFS, NJ 76323

14-28-119-036-0000
BAI CENTURY LLC
720 E PALISADE AVE 201
ENGLEWD CLFS, NJ 76323

14-28-119-037-0000
BAI CENTURY LLC
720 E PALISADE AVE 201
ENGLEWD CLFS, NJ 76323

14-28-119-038-0000
BAI CENTURY LLC
720 E PALISADE AVE 201
ENGLEWD CLFS, NJ 76323

14-28-119-039-0000
BAI CENTURY LLC
720 E PALISADE AVE 201
ENGLEWD CLFS, NJ 76323

14-28-119-040-0000
BAI CENTURY LLC
720 E PALISADE AVE 201
ENGLEWD CLFS, NJ 76323

14-28-119-041-0000
BAI CENTURY LLC
720 E PALISADE AVE 201
ENGLEWD CLFS, NJ 76323

14-28-119-042-0000
BAI CENTURY LLC
720 E PALISADE AVE 201
ENGLEWD CLFS, NJ 76323

14-28-119-043-0000
BAI CENTURY LLC
720 E PALISADE AVE 201
ENGLEWD CLFS, NJ 76323

14-28-119-044-0000
BAI CENTURY LLC
720 E PALISADE AVE 201
ENGLEWD CLFS, NJ 76323

14-28-119-045-0000
BAI CENTURY LLC
720 E PALISADE AVE 201
ENGLEWD CLFS, NJ 76323

14-28-119-046-0000
BAI CENTURY LLC
720 E PALISADE AVE 201
ENGLEWD CLFS, NJ 76323

14-28-119-047-1001
MOHIT REHANI
2817 N ORCHARD ST 1N
CHICAGO, IL 60657

14-28-119-047-1002
DAVID M P KENNEY
2817 N ORCHARD ST #2
CHICAGO, IL 60657

14-28-119-047-1003
YEVGENIY YADOVENKO
2817 N ORCHARD ST #3N
CHICAGO, IL 60657

14-28-119-047-1004
ADAM MCDONALD
2815 N ORCHARD ST#G
CHICAGO, IL 60657

14-28-119-047-1005
JIHYE LEE
2815 N ORCHARD 1S
CHICAGO, IL 60657

14-28-119-047-1006
DAVID & AMY ARENSEN
2815 N ORCHARD ST #2
CHICAGO, IL 60657

14-28-119-047-1007
NATHAN JUDAS
2817 N ORCHARD ST 3S
CHICAGO, IL 60657

14-28-119-047-1008
DAVID & AMY ARENSEN
2815 N ORCAHRD ST #2
CHICAGO, IL 60657

14-28-119-047-1009
ADAM MCDONALD
2815 N ORCHARD ST#G
CHICAGO, IL 60657

14-28-119-047-1010
NATHAN JUDAS
2817 N ORCHARD ST 3S
CHICAGO, IL 60657

14-28-119-047-1011
JIHYE LEE
2815 N ORCHARD ST #1S
CHICAGO, IL 60657

14-28-119-047-1012
DAVID M P KENNEY
2817 N ORCHARD ST #2
CHICAGO, IL 60657

14-28-119-047-1013
YEVGENIY YADOVENKO
2817 N ORCHARD ST #3N
CHICAGO, IL 60657

14-28-119-047-1014
MATTHEW MUCKERHEIDE
2062 N BINGHAM ST
CHICAGO, IL 60647

14-28-119-047-1015
DANIEL & EMILY WAITZMAN
2826 N ORCHARD ST CH
CHICAGO, IL 60657

14-28-119-047-1016
JAMES MICHAEL DOLAN TR
2606 N ORCHARD ST
CHICAGO, IL 60614

14-28-119-047-1017
MOHIT REHANI
2817 N ORCHARD ST
CHICAGO, IL 60657

14-28-119-048-0000
LINCOLN PK HOTEL OPCO
1290 AVENUE OF THE AME
NEW YORK, NY 10104

14-28-119-049-0000
LINCOLN PK HOTEL OPCO
1290 AVENUE OF THE AME
NEW YORK, NY 10104

14-28-119-050-0000
LINCOLN PK HOTEL OPCO
1290 AVENUE OF THE AME
NEW YORK, NY 10104

14-28-119-051-0000
LINCOLN PK HOTEL OPCO
1290 AVENUE OF THE AME
NEW YORK, NY 10104

14-28-119-052-0000
LINCOLN PK HOTEL OPCO
1290 AVENUE OF THE AME
NEW YORK, NY 10104

14-28-119-053-0000
LINCOLN PK HOTEL OPCO
1290 AVENUE OF THE AME
NEW YORK, NY 10104

14-28-119-054-0000
LINCOLN PK HOTEL OPCO
1290 AVENUE OF THE AME
NEW YORK, NY 10104

14-28-119-055-0000
LINCOLN PK HOTEL OPCO
1290 AVE OF THE AMERICA
NEW YORK, NY 10104

14-28-120-002-0000
ANTHONY BRIZGYS
2867 N CLARK
CHICAGO, IL 60657

14-28-120-003-0000
2863 65 CLARK LLC
12011 SAN VICENTE #702
LOS ANGELES, CA 90049

14-28-120-004-0000
NATHAN MOERI
639 W SURF ST
CHICAGO, IL 60657

14-28-120-005-0000
ALESSANDRO PAVAN & DAN
637 W SURF ST
CHICAGO, IL 60657

14-28-120-006-0000
ANNE DODGE
635 W SURF ST
CHICAGO, IL 60657

14-28-120-007-0000
MARIA J MONTALBANO
633 W SURF ST
CHICAGO, IL 60657

14-28-120-008-0000
EARL A TALBOT
631 W SURF ST
CHICAGO, IL 60657

14-28-120-009-0000
DOUGLAS E BALLOTTI & F
629 W SURF ST
CHICAGO, IL 60657

14-28-120-011-0000
VLADIMIR MARINKOVICH
842 S WASHINGTON ST
ELMHURST, IL 60126

14-28-120-014-0000
JOHN ROONEY
3847 N KENNETH
CHICAGO, IL 60641

14-28-120-018-0000
2845 N CLARK LLC
445 RAVINE DR
WINTHROP HBR, IL 60096

14-28-120-019-0000
CLARK CENTURION LTD
PO BOX 46353
CHICAGO, IL 60646

14-28-120-020-0000
GIL YOUNG SUH
2841 N CLARK ST
CHICAGO, IL 60657

14-28-120-021-0000
SAXONY CLARK 2835
222 NORTHFIELD RD S200
NORTHFIELD, IL 60093

14-28-120-029-0000
WALGREEN CO TAX DEPT
PO BOX 901
DEERFIELD, IL 60015

14-28-120-030-0000
WALGREEN CO TAX DEPT
PO BOX 901
DEERFIELD, IL 60015

14-28-120-033-0000
SAXONY CLARK 2831
222 NORTHFIELD RD S200
NORTHFIELD, IL 60093

14-28-120-036-1001
C & P DEMPSEY
617 W SURF #1F
CHICAGO, IL 60657

14-28-120-036-1002
DANIEL SPILOTRO
6160 N CICERO STE 650
CHICAGO, IL 60646

14-28-120-036-1003
KENNETH PRESKI
617 W SURF ST APT 3
CHICAGO, IL 60657

14-28-120-036-1004
RILEY HAEMER TRUST
617 W SURF ST APT 4
CHICAGO, IL 60657

14-28-120-037-0000
SAXONY CLARK 2827 LLC
222 NORTHFIELD RD 200
NORTHFIELD, IL 60093

14-28-120-038-0000
WALGREEN CO TAX DEPT
PO BOX 901
DEERFIELD, IL 60015

14-28-120-042-0000
BROADWAY AT SURF LLC
1 PARKVIEW PLAZA FL 9
OAKBRK TERR, IL 60181

14-28-120-043-0000
BROADWAY AT SURF LLC
1 PARKVIEW PLAZA FL 9
OAKBRK TERR, IL 60181

14-28-120-044-0000
BROADWAY AT SURF LESSE
1 E WACKER DR STE 3110
CHICAGO, IL 60601

14-28-120-045-1001
BRIAN E THOMAS
619 W SURF ST #1
CHICAGO, IL 60657

14-28-120-045-1002
M NACHEMSON & A PISCZA
619 W SURF ST #2
CHICAGO, IL 60657

14-28-120-045-1003
ARJUN REDDY
619 W SURF ST 3
CHICAGO, IL 60657

14-28-120-046-1001
RICHARD & ELLEN CHAPPE
627 W SURF ST #1
CHICAGO, IL 60657

14-28-120-046-1002
CHRIS & ELLEN REAGAN
627 W SURF #2
CHICAGO, IL 60657

14-28-120-046-1003
DOUG HENRY TRUST
627 W SURF ST UNIT 3
CHICAGO, IL 60657

14-28-121-001-0000
WOLF INVEST PROPERTIES
125 N HALSTED ST#203
CHICAGO, IL 60661

14-28-121-002-0000
FRANK BRUSCIANELLI
2827 N BROADWAY 1 FL
CHICAGO, IL 60657

14-28-121-004-0000
LOLN PARK PLAZA LOFTS
14 MAIN ST
PARK RIDGE, IL 60068

14-28-121-005-0000
NATL SHOPPING PLAZA
200 W MADISON ST #4200
CHICAGO, IL 60606

14-28-121-006-0000
NATL SHOPPING PLAZA
200 W MADISON ST #4200
CHICAGO, IL 60606

14-28-121-007-0000
LINCOLN PARK PLAZA LLC
14 MAIN ST
PARK RIDGE, IL 60068

14-28-121-008-0000
LINCOLN PARK PLAZA LOF
14 MAIN ST
PARK RIDGE, IL 60068

14-28-122-003-0000
LINCOLN PARK PLAZA LLC
14 MAIN ST
PARK RIDGE, IL 60068

14-28-122-017-1001
HELEN BADESCH
559 W SURF ST APT 100
CHICAGO, IL 60657

14-28-122-017-1002
SEBASTIAN V ARDELEAN
559 W SURF ST APT 101
CHICAGO, IL 60657

14-28-122-017-1003
HELEN BADESCH
559 W SURF ST APT 102
CHICAGO, IL 60657

14-28-122-017-1004
ANNE M BOUSE
2955 VAN NESS AVE #10
SANFRANCISCO, CA 94109

14-28-122-017-1005
RAYEN P DENNIS
2823 BENT BOW
SAN ANTONIO, TX 78209

14-28-122-017-1006
EMILY MCCANDLESS
559 W SURF ST APT 106
CHICAGO, IL 60657

14-28-122-017-1007
ALINA JANIK
46323 AARONS WAY
CANTON, MI 48188

14-28-122-017-1008
EANDDANDLANDM II LLC
559 W SURF ST APT 200
CHICAGO, IL 60657

14-28-122-017-1009
P TONER
559 W SURF 201
CHICAGO, IL 60657

14-28-122-017-1010
TERESITA BUENUENIDA
559 W SURF 202 GB
CHICAGO, IL 60657

14-28-122-017-1011
RYAN HOPKINS
559 SURF 203
CHICAGO, IL 60657

14-28-122-017-1012
REBECCA LALEZ
3911 NORTH JANSSEN AVE
CHICAGO, IL 60613

14-28-122-017-1013
BRIAN E DAVIS
8010 GREENBRIAR CT
BURR RIDGE, IL 60527

14-28-122-017-1014
SCOTT J LAZARUS
559 W SURF ST APT 206
CHICAGO, IL 60657

14-28-122-017-1015
ALLAN J NIEMERG
559 W SURF ST APT 207
CHICAGO, IL 60657

14-28-122-017-1016
DIANA STAPP
559 W SURF ST APT 209
CHICAGO, IL 60657

14-28-122-017-1017
STEPHEN DEWART
425 LINDEN ST
WINNETKA, IL 60093

14-28-122-017-1018
JATARE BARRETT
559 W SURF ST APT 301
CHICAGO, IL 60657

14-28-122-017-1019
ANDREW W KOERTH
559 W SURF ST #302
CHICAGO, IL 60657

14-28-122-017-1020
CHELSEA SARIKAS
559 W SURF ST APT 303
CHICAGO, IL 60657

14-28-122-017-1021
JERRY J CUNNINGHAM
559 W SURF 304
CHICAGO, IL 60657

14-28-122-017-1022
GARY G MARCONI
559 W SURF ST 305
CHICAGO, IL 60657

14-28-122-017-1023
FEI HAO RENEE LUWIS
559 W SURF ST APT 306
CHICAGO, IL 60657

14-28-122-017-1024
RICHARD A DAVIS
559 W SURF ST 307
CHICAGO, IL 60657

14-28-122-017-1025
JIYOUNG KANG
559 W SURF ST APT 309
CHICAGO, IL 60657

14-28-122-017-1026
JAMES P SULLIVAN
559 W SURF ST 400
CHICAGO, IL 60657

14-28-122-017-1027
DEVIN CARTER
559 W SURF 401
CHICAGO, IL 60657

14-28-122-017-1028
JOHN A PHILLIPS
4319 N SACRAMENTO AVE
CHICAGO, IL 60618

14-28-122-017-1029
JENNIFER GRAHAM
559 W SURF ST APT 403
CHICAGO, IL 60657

14-28-122-017-1030
ROCK PAUSIG
559 W SURF ST 404
CHICAGO, IL 60657

14-28-122-017-1031
MATTHEW MEHILL
559 W SURF ST APT 405
CHICAGO, IL 60657

14-28-122-017-1032
NICHOLAS A AIELLO
559 W SURF ST APT 406
CHICAGO, IL 60657

14-28-122-017-1033
ANDREAS MELINAT
559 W SURF ST #407
CHICAGO, IL 60657

14-28-122-017-1034
JOSEPHINE TUNG
559 W SURF ST APT 409
CHICAGO, IL 60657

14-28-122-017-1035
BERNADETTE ARNDT
559 W SURF #500
CHICAGO, IL 60657

14-28-122-017-1036
ALINA A STERNER
559 W SURF ST APT 501
CHICAGO, IL 60657

14-28-122-017-1037
DIRK GILLESPIE
559 W SURF ST #502
CHICAGO, IL 60657

14-28-122-017-1038
DANIELLE PATARAZZI
758 N LARRABEE APT 426
CHICAGO, IL 60654

14-28-122-017-1039
SB HORWITZ MR HORWITZ
559 W SURF ST 504
CHICAGO, IL 60657

14-28-122-017-1040
KURT BOWEN
559 W SURF #505
CHICAGO, IL 60657

14-28-122-017-1041
LUCAS CUPKOVIC
559 W SURF 506
CHICAGO, IL 60657

14-28-122-017-1042
ALAN LADUKE
1840 LONG POINTE DR
BLOOMFLD HLS, MI 48302

14-28-122-017-1043
JENNA LYNN QUINETTE
559 W SURF ST APT 509
CHICAGO, IL 60657

14-28-122-017-1044
STEVEN L ANDERSON
559 W SURF ST APT 600
CHICAGO, IL 60657

14-28-122-017-1045
JOHN HAMBRICK
559 W SURF #604
CHICAGO, IL 60657

14-28-122-017-1046
GINA M RICARD
559 W SURF ST APT 602
CHICAGO, IL 60657

14-28-122-017-1047
STEPHEN M STATKUS
2225 ILLINOIS ROAD
NORTHBROOK, IL 60062

14-28-122-017-1048
JOHN DOUGLAS HAMBRICK
559 W SURF 604
CHICAGO, IL 60657

14-28-122-017-1049
MADELINE RAE MCHUGH
559 W SURF ST APT 605
CHICAGO, IL 60657

14-28-122-017-1050
JOHN D HAMBRICK
559 W SURF ST 606
CHICAGO, IL 60657

14-28-122-017-1051
PIA BARTOLAI & DEREK H
559 W SURF ST UNIT 607
CHICAGO, IL 60657

14-28-122-017-1052
EMILY SCHULZE
559 W SURF ST APT 609
CHICAGO, IL 60657

14-28-122-017-1053
CAROL MAYER
559 W SURF 700
CHICAGO, IL 60657

14-28-122-017-1054
CHEVONNE SWITZER
559 W SURF #701
CHICAGO, IL 60657

14-28-122-017-1055
KYLE T MURRAY
559 W SURF ST APT 702
CHICAGO, IL 60657

14-28-122-017-1056
KRISTEN BRENDT
559 W SURF ST APT 703
CHICAGO, IL 60657

14-28-122-017-1057
CAROLINE ELIZABETH NOR
559 W SURF ST APT 704
CHICAGO, IL 60657

14-28-122-017-1058
JEAN LUC SCALABRE
910 LEONORA APT 302
SEATTLE, WA 98121

14-28-122-017-1059
YUCHEN ZHANG
4710 REYES ST UNIT 1
AUSTIN, TX 78721

14-28-122-017-1060
BARBARA DESALVO
559 W SURF 707
CHICAGO, IL 60657

14-28-122-017-1061
ARRON MANSFIELD
559 W SURF 709
CHICAGO, IL 60657

14-28-122-017-1062
MONICA HASBUN
2728 N HAMPDEN CT 1502
CHICAGO, IL 60614

14-28-122-017-1063
JASON E MOORE
559 W SURF ST APT 801
CHICAGO, IL 60657

14-28-122-017-1064
KAREN EICH
559 W SURF ST APT 802
CHICAGO, IL 60657

14-28-122-017-1065
KIMBERLY K SMITH
559 W SURF ST APT 803
CHICAGO, IL 60657

14-28-122-017-1066
559 804 WEST SURF STRE
465 WASHINGTON ST#2
BROOKLINE, MA 24466

14-28-122-017-1067
RICHARD KASEMSARN
559 W SURF ST 805
CHICAGO, IL 60657

14-28-122-017-1068
KATHLEEN T LOGAN
559 W SURF ST APT 806
CHICAGO, IL 60657

14-28-122-017-1069
HEMANSHU & J KANG
559 W SURF ST #807
CHICAGO, IL 60657

14-28-122-017-1070
PAUL RONDINELLA
559 W SURF ST APT 809
CHICAGO, IL 60657

14-28-122-017-1071
DAVID J HURLEY
559 W SURF 900
CHICAGO, IL 60657

14-28-122-017-1072
ALI & KELLY SOLAKSUBAS
559 W SURF #901
CHICAGO, IL 60657

14-28-122-017-1073
NOAH ZUENGLER
7222 THIRD AVE
KENOSHA, WI 53143

14-28-122-017-1074
KEVIN MC CARTHY
559 W SURF 904
CHICAGO, IL 60657

14-28-122-017-1075
ALI SOLAKSUBASI
420 E WATERSIDE
CHICAGO, IL 60601

14-28-122-017-1076
MEGAN GROGAN
559 W SURF ST APT 906
CHICAGO, IL 60657

14-28-122-017-1077
ROBERT TODD HARGAN
559 W SURF ST 907
CHICAGO, IL 60657

14-28-122-017-1078
JOSEPH BECKER
559 W SURF ST #909
CHICAGO, IL 60657

14-28-122-017-1079
JOHN P LYNCH
550 W SURF UNIT 103
CHICAGO, IL 60657

14-28-122-017-1080
JOHN P LYNCH
550 W SURF UNIT 103
CHICAGO, IL 60657

14-28-122-017-1081
LORI ROBERTSON
550 WEST SURF UNIT 203
CHICAGO, IL 60657

14-28-122-017-1082
VALERIE SANDS
550 W SURF 303
CHICAGO, IL 60657

14-28-122-017-1083
BRIAN RODY
550 W SURF 403
CHICAGO, IL 60657

14-28-122-017-1084
KELLY CONNERY ZECH
4217 GARDEN AV
WESTERN SPGS, IL 60558

14-28-122-017-1085
AARON RIOS LEBOWITZ
1322 W EDDY ST #3
CHICAGO, IL 60657

14-28-122-017-1086
WILLIAM LARSEN
550 W SURF ST #C104
CHICAGO, IL 60657

14-28-122-017-1087
MICAH T TAUPULE
550 W SURF ST 204
CHICAGO, IL 60657

14-28-122-017-1088
SYDNEY SCHULHOF
550 W SURF ST APT 304
CHICAGO, IL 60657

14-28-122-017-1089
BRENT J ROSENBOWER
550 W SURF
CHICAGO, IL 60657

14-28-122-017-1090
PETER LUGTEN
550 W SURF ST
CHICAGO, IL 60657

14-28-122-017-1091
NICHOLAS BIANCHI
550 W SURF ST APT 504
CHICAGO, IL 60657

14-28-122-017-1092
CHRISTINA TIAN ZHANG
550 W SURF ST APT 105
CHICAGO, IL 60657

14-28-122-017-1093
SARAH DREYER
1401 S JOYCE ST 211
ARLINGTON, VA 22202

14-28-122-017-1094
MATTHEW M SULLIVAN
15331 W 49TH AVE
GOLDEN, CO 80403

14-28-122-017-1095
MICHAEL B LULAY
2420 SUTTON LN
AURORA, IL 60502

14-28-122-017-1096
AIMA MORI
550 W SURF ST APT 505
CHICAGO, IL 60657

14-28-122-017-1097
JONATHAN STEPHEN GRANA
550 W SURF ST APT 106
CHICAGO, IL 60657

14-28-122-017-1098
A & N LOPINTO
70 LITTLE WEST ST #25E
NEW YORK, NY 10004

14-28-122-017-1099
MAUREEN SULLIVAN
550 W SURF 306C
CHICAGO, IL 60657

14-28-122-017-1100
MEGAN MCNIVEN
550 W SURF ST APT 406
CHICAGO, IL 60657

14-28-122-017-1101
LIAM KING
550 W SURF ST APT 506
CHICAGO, IL 60657

14-28-122-017-1102
ADAM LASH
550 W SURF ST APT 107
CHICAGO, IL 60657

14-28-122-017-1103
ANGELA HANSON
550 W SURF 207
CHICAGO, IL 60657

14-28-122-017-1104
CARLOS ROMAN
684 YORKSHIRE RD NE
ATLANTA, GA 30306

14-28-122-017-1105
THE COOKIEJAR TRUST
550 W SURF ST APT 407
CHICAGO, IL 60657

14-28-122-017-1106
SHEILA MARIE WEIGERT
550 W SURF ST APT 507
CHICAGO, IL 60657

14-28-122-017-1107
WHITNEY WRIGHT
550 W SURF ST APT 108
CHICAGO, IL 60657

14-28-122-017-1108
CONOR WILLIAM KINFORD
550 W SURF ST 208
CHICAGO, IL 60657

14-28-122-017-1109
VICTORIA HARDY
550 W SURF STREET 308
CHICAGO, IL 60657

14-28-122-017-1110
CALEIGH ANNE PURCELL
550 W SURF ST APT 408
CHICAGO, IL 60657

14-28-122-017-1111
AXEL LEICHUM
550 W SURF #508
CHICAGO, IL 60657

14-28-122-017-1112
KRISTIN BONIFAS
550 W SURF ST#C109
CHICAGO, IL 60657

14-28-122-017-1113
CHANDRA DERUS
35 E DIVISION ST 1A
CHICAGO, IL 60610

14-28-122-017-1114
THOMAS PAYNE
550 W SURF ST APT 309
CHICAGO, IL 60657

14-28-122-017-1115
MICHAEL GALLAGHER
PO BOX 13047
CHICAGO, IL 60613

14-28-122-017-1116
CARSON REDISH
550 W SURF ST APT 509
CHICAGO, IL 60657

14-28-122-017-1117
WINNEMAC HOLDINGS SURF
14044 NORWICH LANE
ORLAND PARK, IL 60467

14-28-122-017-1118
MEIR HAUSER
500 W SURF ST UNIT 112
CHICAGO, IL 60657

14-28-122-017-1119
SHIRA L JACOBSON
550 W SURF #212
CHICAGO, IL 60657

14-28-122-017-1120
R M LOWE JR
550 W SURF 312
CHICAGO, IL 60657

14-28-122-017-1121
MCKENNA ALISON
550 W SURF #412
CHICAGO, IL 60657

14-28-122-017-1122
LUIS MONJE
550 W SURF ST #512
CHICAGO, IL 60657

14-28-122-017-1123
MELISSA L NAVARETTE
550 W SURF ST #C612
CHICAGO, IL 60657

14-28-122-017-1124
MARILYN WHITE
550 W SURF 113
CHICAGO, IL 60657

14-28-122-017-1125
WILLIAM A MCMILLAN
550 W SURF ST #213
CHICAGO, IL 60657

14-28-122-017-1126
KEVIN R MORKIN
550 W SURF ST #313
CHICAGO, IL 60657

14-28-122-017-1127
GAIL MEYER
550 W SURF ST APT 413
CHICAGO, IL 60657

14-28-122-017-1128
MICHAEL LULAY
2323 NAPERVILLE RD
NAPERVILLE, IL 60563

14-28-122-017-1129
PATRICIA G KLING
550 W SURF #613
CHICAGO, IL 60657

14-28-122-017-1130
SATINDER DALAWARI
550 W SURF ST APT 115
CHICAGO, IL 60657

14-28-122-017-1131
JONATHAN KADET
550 W SURF ST APT 215
CHICAGO, IL 60657

14-28-122-017-1132
EDWARD KEATING
550 W SURF 315C
CHICAGO, IL 60657

14-28-122-017-1133
HEJIANGNAN XU
550 W SURF ST APT 415
CHICAGO, IL 60657

14-28-122-017-1134
RICHARD R WAGNER TRUST
550 W SURF ST APT 515
CHICAGO, IL 60657

14-28-122-017-1135
ANNE MARIE THROM
2008 COLONIAL COURT
RICHARDSON, TX 75082

14-28-122-017-1136
LISA VLACH
550 W SURF ST APT 214
CHICAGO, IL 60657

14-28-122-017-1137
ALANNAH LARSEN
550 W SURF ST#C314
CHICAGO, IL 60657

14-28-122-017-1138
CHRISTOPHER TROJNIAR
550 W SURF 414
CHICAGO, IL 60657

14-28-122-017-1139
KEITH GROEBE
203 N LASALLE ST #2500
CHICAGO, IL 60601

14-28-122-017-1140
RYAN LASURE
550 W SURF ST #117
CHICAGO, IL 60657

14-28-122-017-1141
EILEEN SCHATZ
550 W SURF ST 217
CHICAGO, IL 60657

14-28-122-017-1142
DUNG T NGUYEN
550 W SURF ST APT 317
CHICAGO, IL 60657

14-28-122-017-1143
ROXANNE MEYER
550 W SURF ST #C417
CHICAGO, IL 60657

14-28-122-017-1144
BROWN & GIGS AN ILLINO
1584 SUNCREST LN
BOLINGBROOK, IL 60490

14-28-122-017-1145
DANIEL GARBER & DANA K
550 W SURF ST UNIT 116
CHICAGO, IL 60657

14-28-122-017-1146
MICHAEL A METZGER & EL
677 WINGATE RD
GLEN ELLYN, IL 60137

14-28-122-017-1147
DANIEL SNICKENBERGER
550 W SURF ST#C316
CHICAGO, IL 60657

14-28-122-017-1148
GENEVA S CURRIN
550 W SURF STREET 416
CHICAGO, IL 60657

14-28-122-017-1149
JENNIFER KELLR
550 W SURF 516
CHICAGO, IL 60657

14-28-122-017-1150
JESSICA RANGEL
550 W SURF ST APT 119
CHICAGO, IL 60657

14-28-122-017-1151
SAMANTHA SCHNEIDER
550 W SURF ST APT 219
CHICAGO, IL 60657

14-28-122-017-1152
KATHRYN GLAZE
550 W SURF 319
CHICAGO, IL 60657

14-28-122-017-1153
PETER HARRIS
550 W SURF ST APT 419
CHICAGO, IL 60657

14-28-122-017-1154
LOMONACO LAW LLC
3 W HAWTHORN PKWY#180
VERNON HILLS, IL 60061

14-28-122-017-1155
KATHRYN JACKSON
550 W SURF ST #C118
CHICAGO, IL 60657

14-28-122-017-1156
ERIN GROHMAN
550 W SURF ST APT 218
CHICAGO, IL 60657

14-28-122-017-1157
CHARLOTTE R MCNERNEY
550 W SURF ST
CHICAGO, IL 60657

14-28-122-017-1158
HUNTER SCHIFFMAN
550 W SURF ST APT 418
CHICAGO, IL 60657

14-28-122-017-1159
550 WEST SURF C518 ARV
2733 N PINE GROVE AVE
CHICAGO, IL 60614

14-28-122-017-1160
KELSEY GARLOCK
550 W SURF ST APT 121
CHICAGO, IL 60657

14-28-122-017-1161
ANGSUMAN DUTTA
2500 BILTER RD
AURORA, IL 60502

14-28-122-017-1162
FREDDA BERMAN
550 W SURF APT 321
CHICAGO, IL 60657

14-28-122-017-1163
JACQUELINE MAGGIO
550 W SURF ST 421C
CHICAGO, IL 60657

14-28-122-017-1164
HEIDI NORDBROCK
1130 N VANDERBURG ST
GARY, IN 46403

14-28-122-017-1165
COLLIN ONEILL
550 W SURF ST APT 120
CHICAGO, IL 60657

14-28-122-017-1166
JEREMY ILLENBERGER
31162 CASA GRANDE DR
SANJUANCAPIS, CA 92675

14-28-122-017-1167
CHRISTOPHER L PALCIS
550 W SURF 320
CHICAGO, IL 60657

14-28-122-017-1168
JEFFREY KIMBALL
550 W SURF 420
CHICAGO, IL 60657

14-28-122-017-1169
L SHIVELY & D HAMBLIN
550 W SURF 520
CHICAGO, IL 60657

14-28-122-017-1170
KATHERINE MERRILL
550 W SURF
CHICAGO, IL 60657

14-28-122-017-1171
ANNA MORGAN
550 W SURF 102
CHICAGO, IL 60657

14-28-122-017-1172
JEFFERY W ORIAN
550 W SURF 202
CHICAGO, IL 60657

14-28-122-017-1173
VESNA NAUMOVSKI
550 W SURF ST APT 302
CHICAGO, IL 60657

14-28-122-017-1174
ROBERT M LOKE
1310 BOCAGE CV APT 303
MEMPHIS, TN 0

14-28-122-017-1175
BREANNA BENTHAM
550 W SURF ST
CHICAGO, IL 60657

14-28-122-017-1176
ANN L HAMMON
550 W SURF AV 101
CHICAGO, IL 60657

14-28-122-017-1177
BONNIE L ALEXANDER
550 W SURF ST #201
CHICAGO, IL 60657

14-28-122-017-1178
ALISON GAYLE TUROFF
550 W SURF ST 301
CHICAGO, IL 60657

14-28-122-017-1179
AMANDA FEDER
550 W SURF ST 501
CHICAGO, IL 60657

14-28-122-017-1180
NICHOLAS BIANCHI
541 W ADDISON ST 3S
CHICAGO, IL 60613

14-28-122-017-1181
JONATHAN OCONNELL
36W718 OAK RIDGE LN
ST CHARLES, IL 60174

14-28-122-017-1182
JERRY MODELO
550 W SURF 411
CHICAGO, IL 60657

14-28-122-017-1183
A MAGBANUA C
4322 N KEDVALE
CHICAGO, IL 60641

14-28-122-017-1184
ANISSA JESSICA VASQUEZ
550 W SURF ST APT C611
CHICAGO, IL 60657

14-28-122-017-1185
C SMITH
550 W SURF ST APT 110
CHICAGO, IL 60657

14-28-122-017-1186
ALLISON MARY SCHNAEDTE
550 W SURF ST APT 210
CHICAGO, IL 60657

14-28-122-017-1187
ELISE AUERBACH
550 W SURF ST 310
CHICAGO, IL 60657

14-28-122-017-1188
AMY ROGALINER
550 W SURF ST 410
CHICAGO, IL 60657

14-28-122-017-1189
NEAL S GAINSBURG
334 WAGNER ROAD
NORTHFIELD, IL 60093

14-28-122-017-1190
JOSHUA HOSCH
550 W SURF ST APT 522C
CHICAGO, IL 60657

14-28-122-017-1191
AGATHA C VALENZUELA
550 W SURF ST#C523
CHICAGO, IL 60657

14-28-122-017-1192
BENJAMIN W LARRISON
550 W SURF ST APT 524
CHICAGO, IL 60657

14-28-122-017-1193
PETER MOROH
550 W SURF 525
CHICAGO, IL 60657

14-28-122-017-1194
BENJAMIN W LARRISON
550 W SURF ST APT 524
CHICAGO, IL 60657

14-28-122-017-1195
JESSICA
550 W SURF ST #314
CHICAGO, IL 60657

14-28-122-017-1196
JATARE BARRETT
559 W SURF ST APT 301
CHICAGO, IL 60657

14-28-122-017-1197
BRIAN RODY
550 W SURF #403
CHICAGO, IL 60657

14-28-122-017-1198
EANDDANDLANDM II LLC
559 W SURF ST APT 200
CHICAGO, IL 60657

14-28-122-017-1199
EILEEN SCHATZ
550 W SURF ST 217
CHICAGO, IL 60657

14-28-122-017-1200
AXEL LEICHUM
550 W SURF #508
CHICAGO, IL 60657

14-28-122-017-1201
RICHARD A DAVIS
559 W SURF ST 307
CHICAGO, IL 60657

14-28-122-017-1202
KEITH GROEBE
203 N LASALLE ST #2500
CHICAGO, IL 60601

14-28-122-017-1203
ANGELA HANSON
550 W SURF 207
CHICAGO, IL 60657

14-28-122-017-1204
KEVIN MCCARTHY
559 W SURF ST #904
CHICAGO, IL 60657

14-28-122-017-1205
JONATHAN KADET
550 W SURF ST APT 215
CHICAGO, IL 60657

14-28-122-017-1206
HELEN BADESCH
559 W SURF ST APT 100
CHICAGO, IL 60657

14-28-122-017-1207
SEBASTIAN V ARDELEAN
559 W SURF ST APT 101
CHICAGO, IL 60657

14-28-122-017-1208
JERRY J CUNNINGHAM
559 W SURF 304
CHICAGO, IL 60657

14-28-122-017-1209
ANDREAS MELINAT
559 W SURF ST #407
CHICAGO, IL 60657

14-28-122-017-1210
STEPHEN DEWART
425 LINEN ST
WINNETKA, IL 60093

14-28-122-017-1211
SB HORWITZ MR HORWITZ
559 W SURF ST 504
CHICAGO, IL 60657

14-28-122-017-1212
DAVID J HURLEY
559 W SURF 900
CHICAGO, IL 60657

14-28-122-017-1213
STEVEN L ANDERSON
559 W SURF ST#STE600
CHICAGO, IL 60657

14-28-122-017-1214
WHITNEY WRIGHT
550 W SURF ST APT 108
CHICAGO, IL 60657

14-28-122-017-1215
AGATHA C VALENZUELA
550 W SURF ST#C523
CHICAGO, IL 60657

14-28-122-017-1216
BRENT J ROSENOWER
550 W SURF ST C 404
CHICAGO, IL 60657

14-28-122-017-1217
JAMES P SULLIVAN
559 W SURF ST 400
CHICAGO, IL 60657

14-28-122-017-1218
DEVIN CARTER
559 W SURF 401
CHICAGO, IL 60657

14-28-122-017-1219
ALI & KELLY SOLAKSUBAS
559 W SURF #901
CHICAGO, IL 60657

14-28-122-017-1220
MARILYN WHITE
550 W SURF ST APT 113
CHICAGO, IL 60657

14-28-122-017-1221
PAUL RONDINELLA
559 W SURF ST APT 809
CHICAGO, IL 60657

14-28-122-017-1222
JOHN HAMBRICK
559 W SURF #604
CHICAGO, IL 60657

14-28-122-017-1223
MCKENNA ALISON
550 W SURF #412
CHICAGO, IL 60657

14-28-122-017-1224
CHEVONNE SWITZER
559 W SURF #701
CHICAGO, IL 60657

14-28-122-017-1225
KATHLEEN T LOGAN
559 W SURF ST APT 806
CHICAGO, IL 60657

14-28-122-017-1226
PATRICIA G KLING
550 W SURF #613
CHICAGO, IL 60657

14-28-122-017-1227
JEAN LUC SCALABRE
910 LEONORA APT 302
SEATTLE, WA 98121

14-28-122-017-1228
KEVIN M SCHREIBER
550 W SURF 417
CHICAGO, IL 60657

14-28-122-017-1229
STEPHEN M STATKUS
2225 ILLINOIS ROAD
NORTHBROOK, IL 60062

14-28-122-017-1230
PIA BARTOLAI & DEREK H
559 W SURF ST UNIT 607
CHICAGO, IL 60657

14-28-122-017-1231
GAIL MEYER
550 W SURF UNIT 413
CHICAGO, IL 60657

14-28-122-017-1232
ANNE M BOUSE
2955 VAN NESS AVE #10
SAN FRANCISCO, CA 94109

14-28-122-017-1233
KURT BOWEN
559 W SURF #505
CHICAGO, IL 60657

14-28-122-017-1234
KAREN EICH
559 W SURF ST APT 802
CHICAGO, IL 60657

14-28-122-017-1235
MONICA HASBUN
2728 N HAMPDEN CT 1502
CHICAGO, IL 60614

14-28-122-017-1236
ALINA A STERNER
559 W SURF ST APT 501
CHICAGO, IL 60657

14-28-122-017-1237
KATHERINE PETERSON
2195 140TH ST
FORT DODGE, IA 50501

14-28-122-017-1238
REBECCA LALEZ
3911 N JANSSEN AVE
CHICAGO, IL 60613

14-28-122-017-1239
KIMBERLY K SMITH
559 W SURF ST APT 803
CHICAGO, IL 60657

14-28-122-017-1240
MICHAEL A METZGER & EL
677 WINGATE RD
GLEN ELLYN, IL 60137

14-28-122-017-1241
EMILY SCHULZE
559 W SURF ST APT 609
CHICAGO, IL 60657

14-28-122-017-1242
EDWARD KEATING
550 W SURF 315C
CHICAGO, IL 60657

14-28-122-017-1243
LUIS MONJE
550 W SURF ST #512
CHICAGO, IL 60657

14-28-122-017-1244
MICHAEL GALLAGHER
PO BOX 13047
CHICAGO, IL 60613

14-28-122-017-1245
KRISTIN BONIFAS
550 W SURF ST#C109
CHICAGO, IL 60657

14-28-122-017-1246
HIEN HUYNH
550 W SURF ST 105
CHICAGO, IL 60657

14-28-122-017-1247
BERNADETTE ARNDT
559 W SURF #500
CHICAGO, IL 60657

14-28-122-017-1248
SHEILA MARIE WEIGERT
550 W SURF ST APT 507
CHICAGO, IL 60657

14-28-122-017-1249
MICHAEL LULAY
2323 NAPERVILLE RD
NAPERVILLE, IL 60563

14-28-122-017-1250
ALAN GERARD LADUKE
559 W SURF ST APT 507
CHICAGO, IL 60657

14-28-122-017-1251
KEVIN R MORKIN
550 W SURF ST #313
CHICAGO, IL 60657

14-28-122-017-1252
CAROLINE ELIZABETH NOR
559 W SURF ST APT 704
CHICAGO, IL 60657

14-28-122-017-1253
RICHARD R WAGNER TRUST
550 W SURF ST APT 515
CHICAGO, IL 60657

14-28-122-017-1254
WINNEMAC HOLDINGS SURF
14044 NORWICH LANE
ORLAND PARK, IL 60467

14-28-122-017-1255
HEIDI NORDBROCK
1130 N VANDERBURG ST
GARY, IN 46403

14-28-122-017-1256
BRIAN RODY
550 W SURF 403
CHICAGO, IL 60657

14-28-122-017-1257
CAROL MAYER
559 W SURF 700
CHICAGO, IL 60657

14-28-122-017-1258
SHIRA JACOBSON
550 W SURF ST #212
CHICAGO, IL 60657

14-28-122-017-1259
ROBERT TODD HARGAN
559 W SURF ST #907
CHICAGO, IL 60657

14-28-122-017-1260
P TONER
559 W SURF 201
CHICAGO, IL 60657

14-28-122-017-1261
A & N LOPINTO
70 LITTLE WEST ST #25E
NEW YORK, NY 10004

14-28-122-017-1262
RANDALL S FLEER
550 W SURF 612
CHICAGO, IL 60657

14-28-122-017-1263
JASON MOORE
559 W SURF ST APT 801
CHICAGO, IL 60657

14-28-122-017-1264
MICHAEL B LULAY
2420 SUTTON LN
AURORA, IL 60502

14-28-122-017-1265
HEMANSHU K & J KANG
559 W SURF ST 807
CHICAGO, IL 60657

14-28-122-017-1266
WINNEMAC HOLDINGS SURF
14044 NORWICH LANE
ORLAND PARK, IL 60467

14-28-122-017-1267
MAUREEN SULLIVAN
550 W SURF ST 306
CHICAGO, IL 60657

14-28-122-017-1268
AIMA MORI
550 W SURF ST APT 505
CHICAGO, IL 60657

14-28-122-017-1269
J ORIAN
550 W SURF 202
CHICAGO, IL 60657

14-28-122-017-1270
NOAH ZUENGLER
7222 THIRD AVE
KENOSHA, WI 53143

14-28-122-017-1271
TAXPAYER OF
559 W SURF ST #C524
CHICAGO, IL 60657

14-28-300-021-0000
FRED L LUNDGREN JR
711 W DIVERSEY AV
CHICAGO, IL 60614

14-28-300-022-0000
TAXPAYER OF
709 W DIVERSEY PKWY
CHICAGO, IL 60614

14-28-300-025-0000
G JANSON & T MCGUAN
701 W DIVERSEY PKWY
CHICAGO, IL 60614

14-28-300-036-0000
LYNN M MCGOVERN
155 N WACKER DR 2700
CHICAGO, IL 60606

14-28-300-037-0000
JUSTIN DEARBORN
712 W SCHUBERT AVE
CHICAGO, IL 60614

14-28-300-039-0000
SAM B ROVIT
702 W SCHUBERT
CHICAGO, IL 60614

14-28-300-040-0000
CHRIS KNOEPEL
11921 SETTLERS RD
CEDARBURG, WI 53012

14-28-300-041-1001
HARRY MARKELLOS
2707 W CHASE
CHICAGO, IL 60645

14-28-300-041-1002
HARRY MARKELLOS
2707 WEST CHASE
CHICAGO, IL 60645

14-28-300-041-1003
HARRY MARKELLOS
2707 W CHASE
CHICAGO, IL 60645

14-28-300-041-1004
HARRY MARKELLOS
2707 WEST CHASE
CHICAGO, IL 60645

14-28-300-041-1005
HARRY MARKELLOS
2707 WEST CHASE
CHICAGO, IL 60645

14-28-300-041-1006
HARRY MARKELLOS
2707 WEST CHASE
CHICAGO, IL 60645

14-28-300-041-1007
HARRY MARKELLOS
2707 WEST CHASE
CHICAGO, IL 60645

14-28-300-041-1008
HARRY MARKELLOS
2707 WEST CHASE
CHICAGO, IL 60645

14-28-300-041-1009
HARRY MARKELLOS
2707 WEST CHASE
CHICAGO, IL 60645

14-28-300-041-1010
HARRY MARKELLOS
2707 WEST CHASE
CHICAGO, IL 60645

14-28-300-042-1001
DARLA JANSEN
707 W DIVERSEY #A
CHICAGO, IL 60614

14-28-300-042-1002
LOUIS BASILE
707 W DIVERSEY PKWY #B
CHICAGO, IL 60614

14-28-300-042-1003
LAURA MCKAY
707 W DIVERSEY PKWY#C
CHICAGO, IL 60614

14-28-300-042-1004
BETTINA R JOHNSON
707 W DIVERSEY PKWY#D
CHICAGO, IL 60614

14-28-300-042-1005
707 MANAGEMENT LLC
707 W DIVERSEY PKWY#E
CHICAGO, IL 60614

14-28-300-042-1006
HENNESSY ROAD PROP 70
6359 N RIDGE AVE#302
CHICAGO, IL 60660

14-28-300-042-1007
DAVID ARENSON
707 W DIVERSEY UNIT G
CHICAGO, IL 60614

14-28-300-042-1008
GILBERT A KRAUSE
707 W DIVERSEY PKWY#H
CHICAGO, IL 60614

14-28-300-042-1009
OMA LLC
5855 N SHERIDAN RD#11A
CHICAGO, IL 60660

14-28-300-042-1010
MARION VELEZ
6618 E CARON DR
PARADISE VLY, AZ 85253

14-28-300-043-0000
EXNAT-25631-VAL REALTY
2218 N GENEVA TERRACE
CHICAGO, IL 60614

14-28-300-048-1001
DAVID FOK
710 W SCHUBERT AVE#A
CHICAGO, IL 60614

14-28-300-048-1002
MATTHEW CANNON
710 W SCHUBERT AVE#B
CHICAGO, IL 60614

14-28-300-048-1003
JACK VIELLIEU
710 W SCHUBERT AVE#C
CHICAGO, IL 60614

14-28-300-049-1001
SAM DE FRANK TR
708 W SCHUBERT #A
CHICAGO, IL 60614

14-28-300-049-1002
HAYDEN KORNBLUT
708 W SCHUBERT AVE#B
CHICAGO, IL 60614

14-28-300-049-1003
ROBERT GOLDSMITH
708 W SCHUBERT AVE#C
CHICAGO, IL 60614

14-28-300-050-1001
JOSHUA KONNER
706 W SCHUBERT AVE A
CHICAGO, IL 60614

14-28-300-050-1002
JUAN BOIDO
706 W SCHUBERT AVE#B
CHICAGO, IL 60614

14-28-300-050-1003
MANNI GONG TRUSTEE
706 W SCHUBERT AVE#C
CHICAGO, IL 60614

14-28-301-001-0000
TRADER JOES INC 703
PO BOX 5049 RE DEPT
MONROVIA, CA 91017

14-28-301-002-0000
TRADER JOES INC 703
PO BOX 5049 RE DEPT
MONROVIA, CA 91017

14-28-301-003-0000
TRADER JOES INC 703
PO BOX 5049 RE DEPT
MONROVIA, CA 91017

14-28-301-004-0000
TRADER JOES INC 703
PO BOX 5049 RE DEPT
MONROVIA, CA 91017

14-28-301-014-0000
PATRICK NOONAN
630 W SCHUBERT
CHICAGO, IL 60614

14-28-301-017-0000
CO RYAN PTS DEPT 800
PO BOX 460169
HOUSTON, TX 77056

14-28-301-018-0000
PARKWAY VENTURE LLC
P O BOX 232
HIGHLAND PK, IL 60035

14-28-301-021-0000
CO RYAN PTS DEPT 800
PO BOX 460169
HOUSTON, TX 77056

14-28-301-022-0000
JEFFREY T YAMANE
634 W SCHUBERT AV
CHICAGO, IL 60614

14-28-301-024-1001
ARABEL ALVA ROSALES AS
642 W SCHUBERT AVE#A
CHICAGO, IL 60614

14-28-301-024-1002
DIETER O BARDY
640 W SCHUBERT AVE #B
CHICAGO, IL 60614

14-28-301-024-1003
HEIDI HUNT
640 W SCHUBERT C
CHICAGO, IL 60614

14-28-301-024-1004
MATTHEW LOPPNOW
642 W SCHUBERT AVE #D
CHICAGO, IL 60614

14-28-301-024-1005
MICHELLE HARBURN
642 W SCHUBERT AVE#E
CHICAGO, IL 60614

14-28-301-024-1006
DIANE HANDELSMAN TRUST
640 W SCHUBERT AVE#F
CHICAGO, IL 60614

14-28-301-025-0000
NRG CS HOLDINGS LIMITE
225 W HUBBARD ST
CHICAGO, IL 60654

14-28-301-027-1001
MELANIE PETERSEN
628 W SCHUBERT AVE#1F
CHICAGO, IL 60614

14-28-301-027-1002
HILLARY C MOORE
628 W SCHUBERT AVE #2F
CHICAGO, IL 60614

14-28-301-027-1003
CTLTC 000000132862
10 S LASALLE ST #2750
CHICAGO, IL 60603

14-28-301-027-1005
SCHULTZ REAL ESTATE HO
901 N UPPER BROADWAY
CORPS CHRSTI, TX 78401

14-28-301-027-1006
ALEX HONG JU LIN
14711 ENGLAND STREET
OVERLAND PK, KS 66221

14-28-301-028-1001
MIRCEA D CIUBANCAN
636 W SCHUBERT AVE#A
CHICAGO, IL 60614

14-28-301-028-1002
ANUJA DADWAL
636 W SCHUBERT AVE #B
CHICAGO, IL 60614

14-28-301-028-1003
JENNA L GLASS
636 W SCHUBERT AVE #C
CHICAGO, IL 60614

14-28-301-028-1004
MIRCEA D CIUBANCAN
636 W SCHUBERT AVE#A
CHICAGO, IL 60614

14-28-301-028-1005
ANUJA DADWAL
636 W SCHUBERT AVE #B
CHICAGO, IL 60614

14-28-301-028-1006
JENNA L GLASS
636 W SCHUBERT AVE #C
CHICAGO, IL 60614

14-28-301-029-1001
APARNA SHARMA
616 W SCHUBERT AV #1E
CHICAGO, IL 60614

14-28-301-029-1002
KYLE E KOROL
616 W SCHUBERT AVE#2E
CHICAGO, IL 60614

14-28-301-029-1003
TAXPAYER OF
616 W SCHUBERT #3E
CHICAGO, IL 60614

14-28-301-029-1004
ANDREW J MOAG
616 W SCHUBERT 4E
CHICAGO, IL 60614

14-28-301-029-1005
MARCELLO BERZERI
618 W SCHUBERT #1W
CHICAGO, IL 60614

14-28-301-029-1006
TAYLOR MCGREGOR
618 W SCHUBERT AVE#2W
CHICAGO, IL 60614

14-28-301-029-1007
PATRICK SHARP
131 OLD QUARRY RD
GUILFORD, CT 64373

14-28-301-029-1008
JEFFEREY JOHNSUN & HEL
618 W SCHUBERT AVE#4W
CHICAGO, IL 60614

14-28-301-029-1009
MARIA HAWILO
622 W SCHUBERT AVE#1E
CHICAGO, IL 60614

14-28-301-029-1010
JIARUI LI
622 W SCHUBERT AVE#2E
CHICAGO, IL 60614

14-28-301-029-1011
SONIA SHAH
622 WEST SCHUBERT #3E
CHICAGO, IL 60614

14-28-301-029-1012
SIMON DAVIES
622 W SCHUBERT AVE#4E
CHICAGO, IL 60614

14-28-301-029-1013
MITCHELL AARON ADAM CO
624 W SCHUBERT AVE#1W
CHICAGO, IL 60614

14-28-301-029-1014
PAUL BARHAM
624 W SCHUBERT AVE 2W
CHICAGO, IL 60614

14-28-301-029-1015
MICHAEL SMITH
624 W SCHUBERT AVE#3W
CHICAGO, IL 60614

14-28-301-029-1016
J DORN
624 W SCHUBERT AVE
CHICAGO, IL 60614

14-28-301-030-0000
CO RYAN PTS DEPT 800
PO BOX 460169
HOUSTON, TX 77056

14-28-301-031-0000
CO RYAN PTS DEPT 800
PO BOX 460169
HOUSTON, TX 77056

14-28-301-032-0000
CO RYAN PTS DEPT 800
PO BOX 460169
HOUSTON, TX 77056

14-28-301-033-0000
SCOTT KAPP
3053 NORTH KENMORE AV
CHICAGO, IL 60657

14-28-301-034-0000
SCOTT KAPP
3053 NORTH KENMORE AV
CHICAGO, IL 60657

14-28-301-035-1001
PEDRO ALBUQUERQUE
632 W SCHUBERT AVE #1
CHICAGO, IL 60614

14-28-301-035-1002
RAKESH SHETTY
632 W SCHUBERT AVE #2
CHICAGO, IL 60614

14-28-301-035-1003
TIMOTHY L RYAN TRUSTEE
632 W SCHUBERT AVE #3
CHICAGO, IL 60614

14-28-306-001-0000
CO RYAN PTS DEPT 800
PO BOX 460169
HOUSTON, TX 77056

14-28-306-002-0000
2735 N CLARK ST LLC
2735 N CLARK ST
CHICAGO, IL 60614

14-28-306-003-0000
CO RYAN PTS DEPT 800
PO BOX 460169
HOUSTON, TX 77056

14-28-306-011-0000
VICTOR PATEL
601 W DIVERSEY PKWY
CHICAGO, IL 60614

14-28-306-012-0000
VICTOR PATEL
601 W DIVERSEY PKWY
CHICAGO, IL 60614

14-28-306-013-0000
VICTOR PATEL
601 W DIVERSEY PKWY
CHICAGO, IL 60614

14-28-119-021-0000
EXEMPT

14-28-119-022-0000
EXEMPT

14-28-119-023-0000
EXEMPT

14-28-120-017-0000
EXEMPT

14-28-120-035-0000
EXEMPT

