

# IL Sustainable Barging Project

River Ecology and Governance Task Force

8/2/2022



# Welcome

LRS is the **industry leader** in providing **innovative** and **environmentally responsible** waste and recycling solutions.

- **Port 1:** California Avenue Construction & Demolition (C&D) Material Recovery Facility
- **Port 2:** Heartland Recycling Center

# LRS

- 62 facilities located throughout Illinois and the Midwest
- 6 sites in the City of Chicago employing 258 people

# Overview of Barging



"One of the cheapest and safest ways to move waste"

Barge transport is seven times more fuel efficient than truck transport

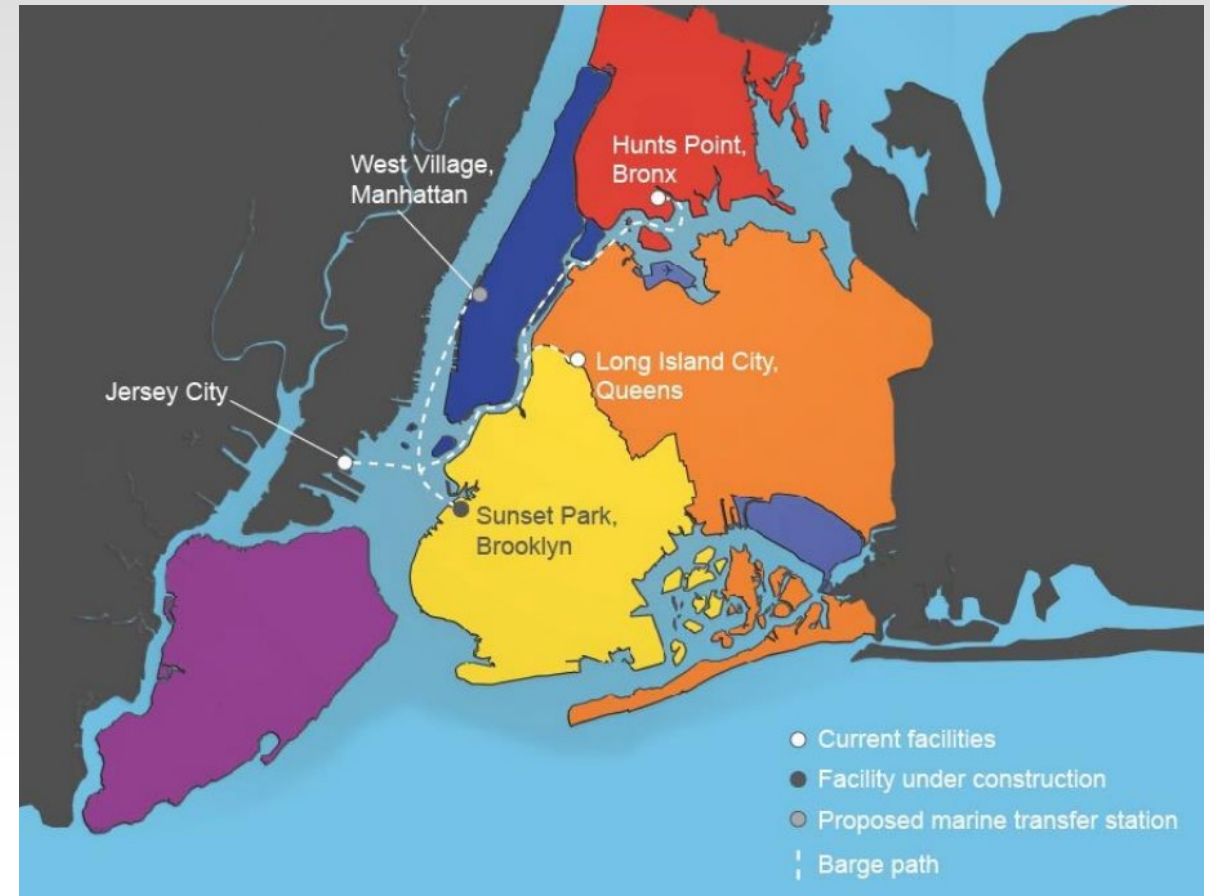





# Environmental Benefits

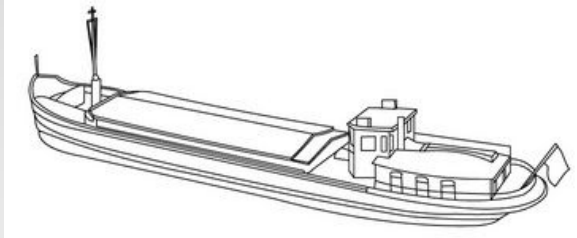

**1 barge**

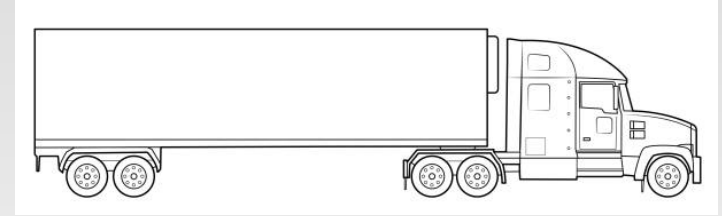

**61 diesel semi-trailers**

- 22 million lbs. of CO<sub>2</sub> emissions eliminated yearly
- 1.5 million lbs. of particulate emissions eliminated yearly
- 1 million gallons of diesel fuel reduced yearly
- 275 truck trips reduced daily







## LOCATION MAP

## ZONING MAP

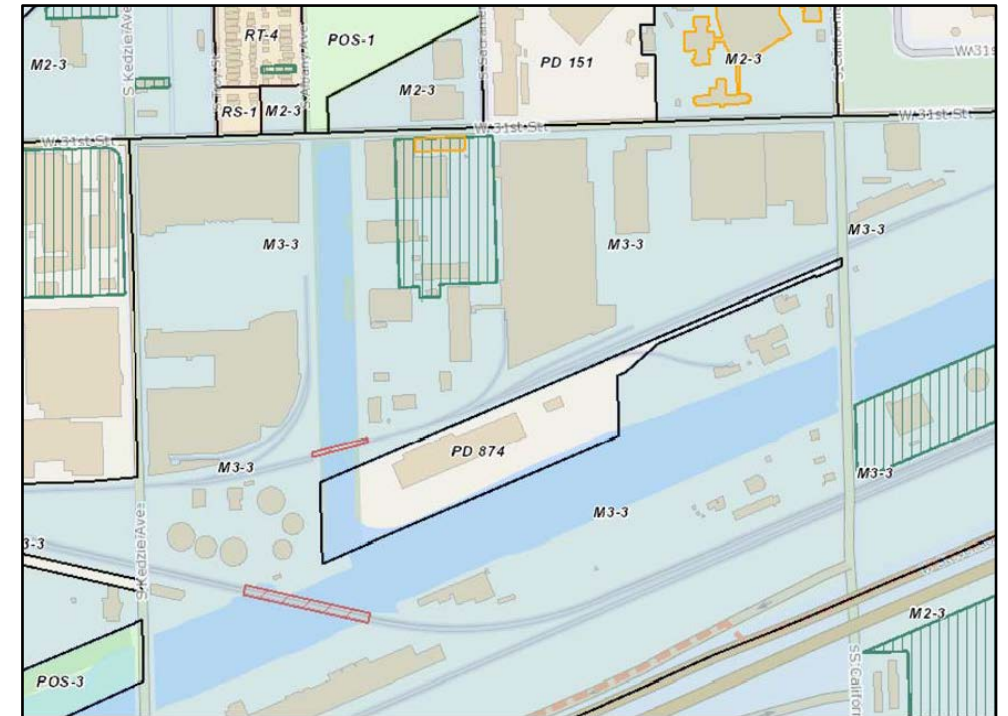
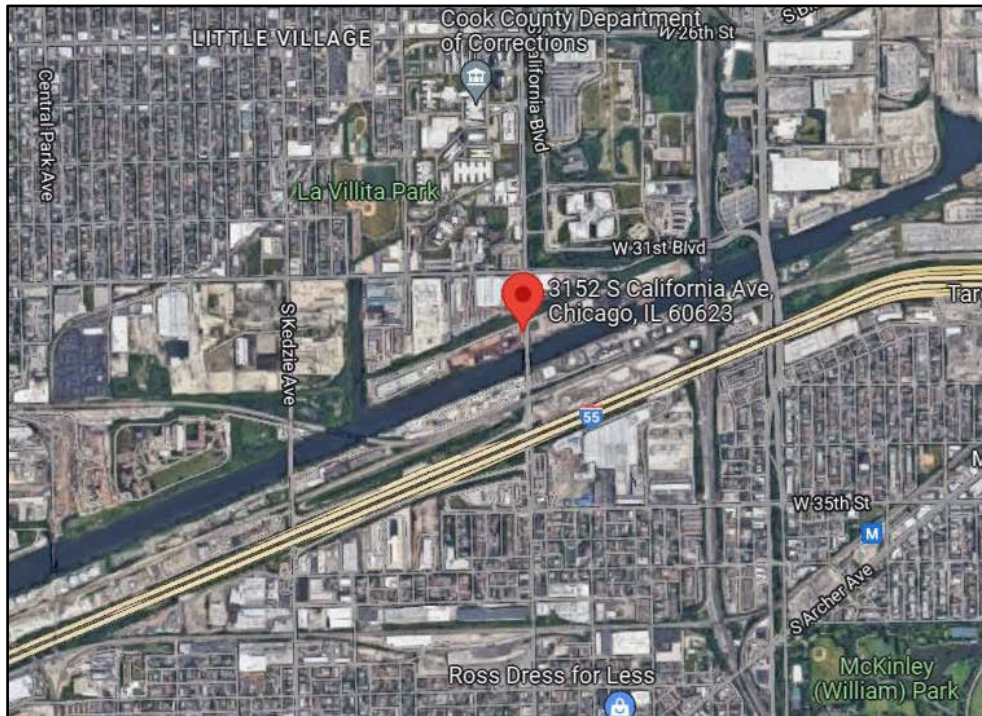





# EXISTING LANDSCAPE PLAN

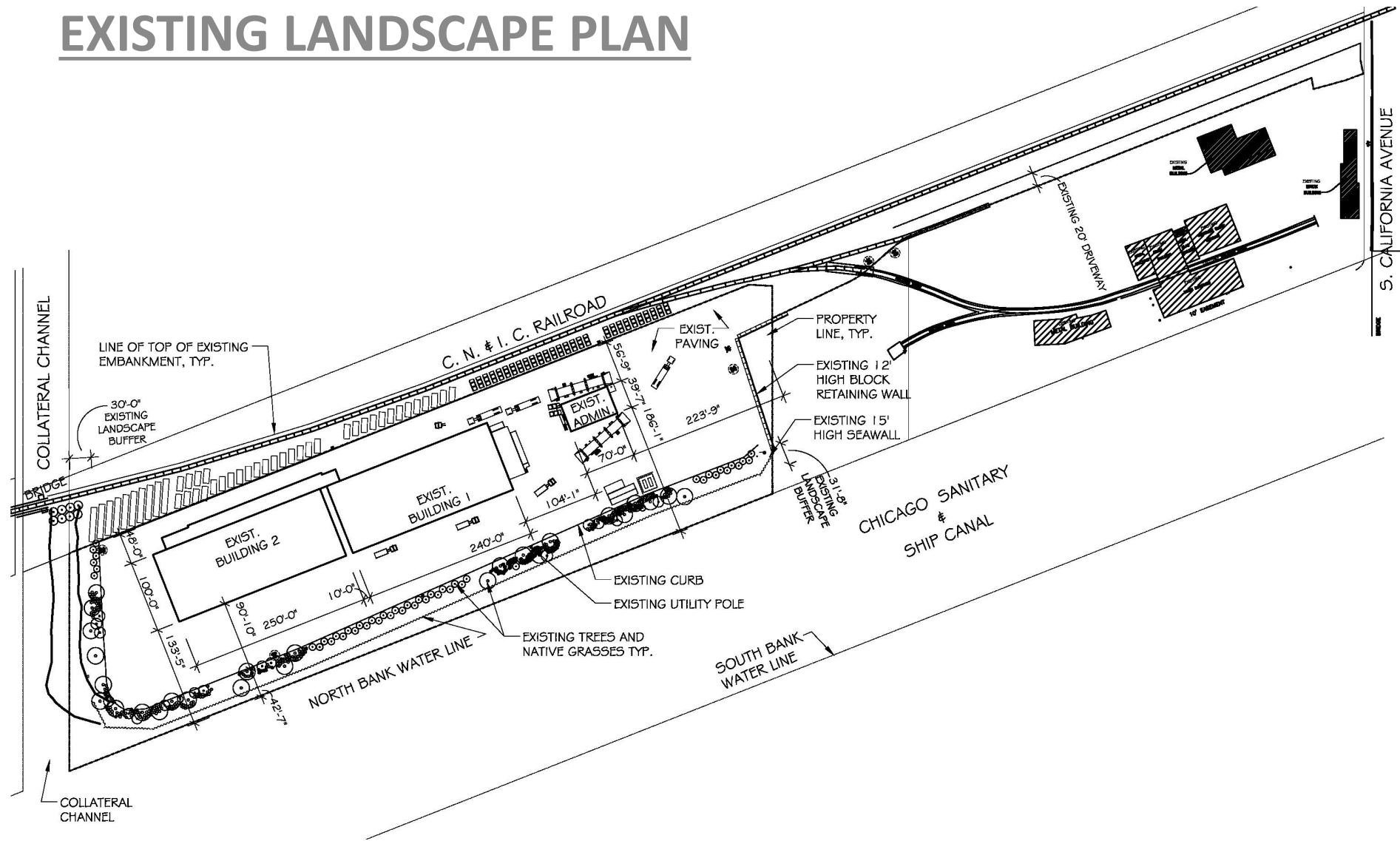

S. CALIFORNIA AVENUE



## EXISTING NATIVE HABITAT





## EXISTING NATIVE HABITAT





## EXISTING NATIVE HABITAT





## EXISTING NATIVE HABITAT





# PROPOSED SITE PLAN

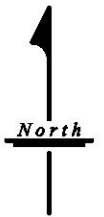
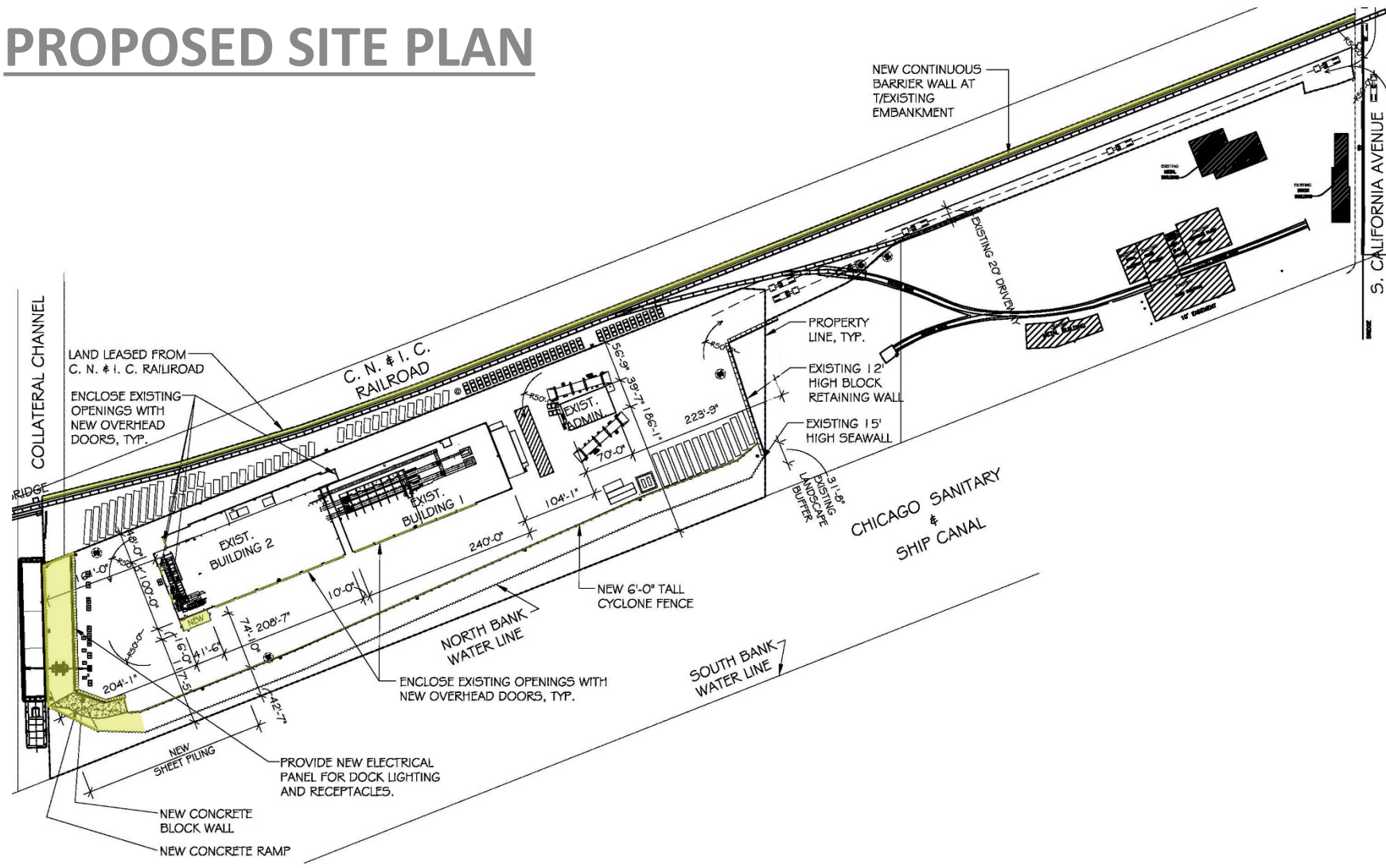







# PROPOSED LANDSCAPE PLAN

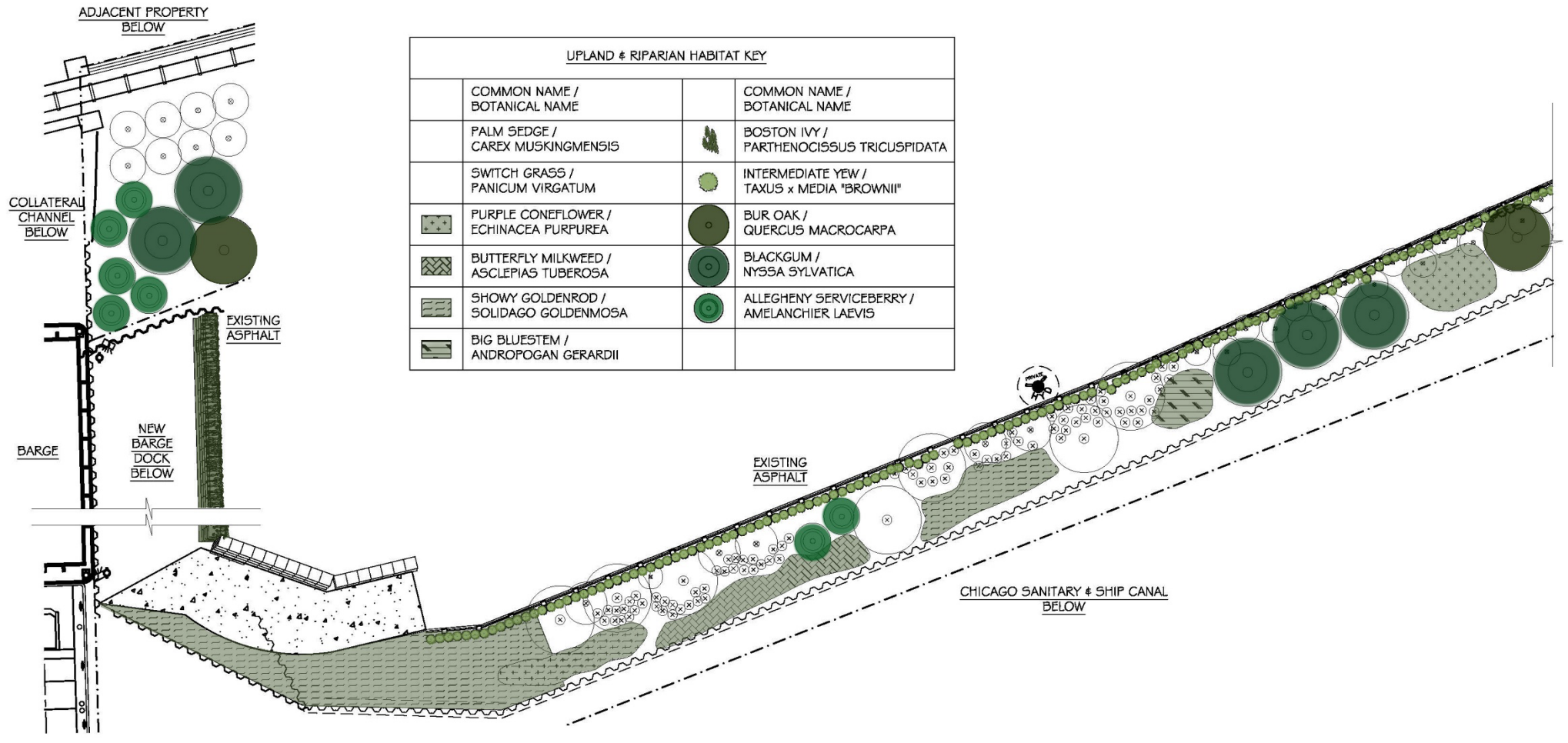

UPLAND & RIPARIAN HABITAT KEY		
COMMON NAME / BOTANICAL NAME		COMMON NAME / BOTANICAL NAME
PALM SEDGE / CAREX MUSKINGMENSIS		BOSTON IVY / PARTHENOCISSUS TRICUSPIDATA
SWITCH GRASS / PANICUM VIRGATUM		INTERMEDIATE YEW / TAXUS x MEDIA "BROWNI"
PURPLE CONEFLOWER / ECHINACEA PURPUREA		BUR OAK / QUERCUS MACROCARPA
BUTTERFLY MILKWEED / ASCLEPIAS TUBEROSA		BLACKGUM / NYSSA SYLVATICA
SHOWY GOLDENROD / SOLIDAGO GOLDENMOZA	ALLEGHENY SERVICEBERRY / AMELANCHIER LAEVIS	
BIG BLUESTEM / ANDROPOGAN GERARDII		



# PROPOSED LANDSCAPE PLAN

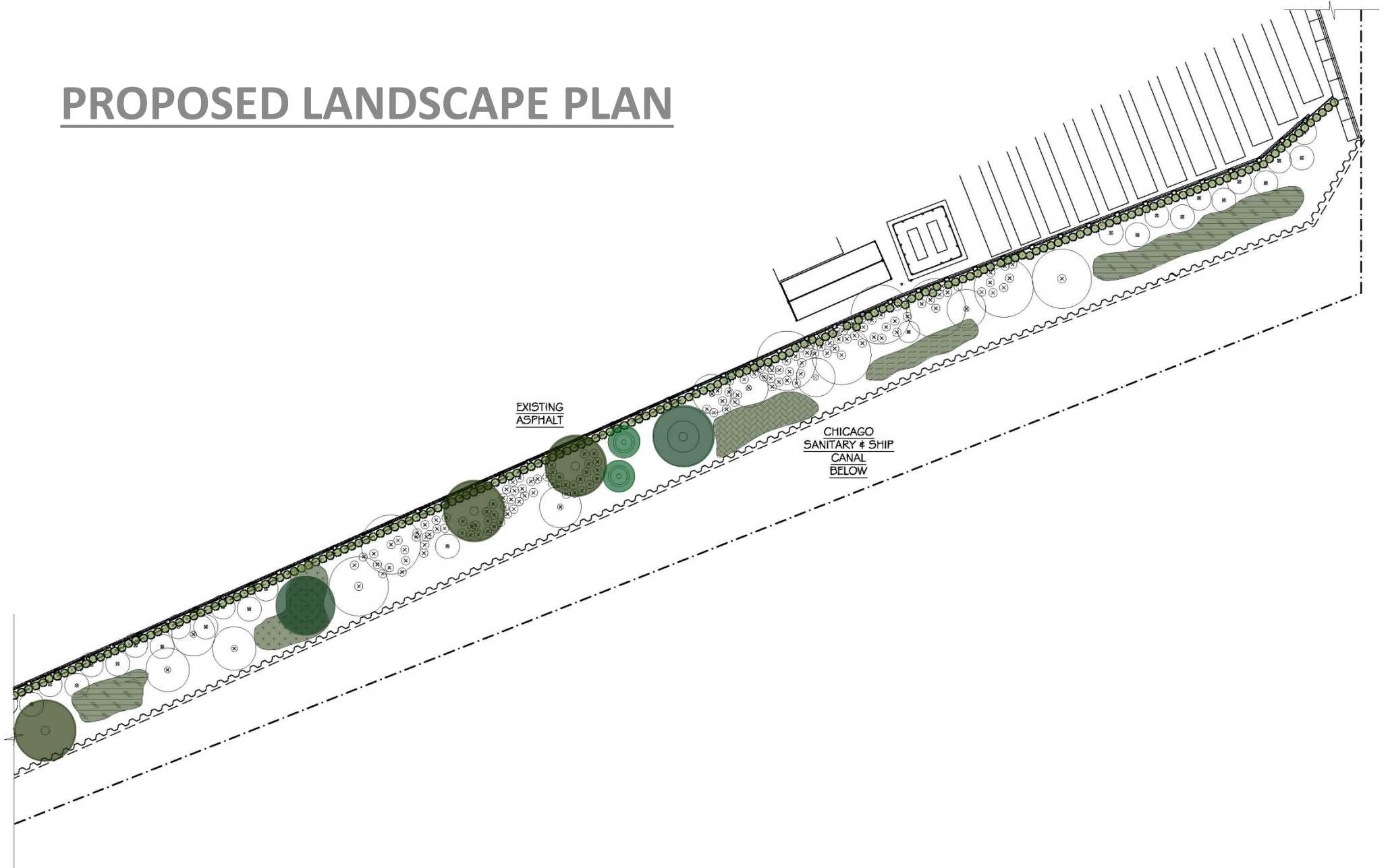
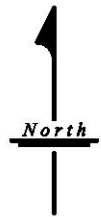



## PROPOSED NATIVE HABITAT ADDITIONS

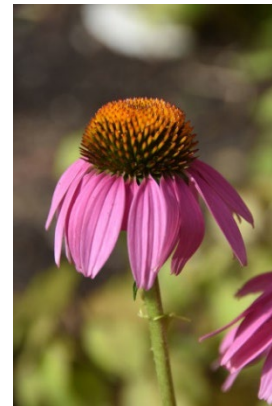



## PROPOSED VIEW FROM SOUTHWEST



# Thank you!

## Questions?

**Rich Golf**— [RGolf@LRSrecycles.com](mailto:RGolf@LRSrecycles.com)

**Natalie Grimaldi**— [NGrimaldi@LRSrecycles.com](mailto:NGrimaldi@LRSrecycles.com)

**Joy Rifkin**— [JRifkin@LRSrecycles.com](mailto:JRifkin@LRSrecycles.com)

**Pamela J. Hutter**— [pjhutter@hutterarchitects.com](mailto:pjhutter@hutterarchitects.com)

**Sara Ajster**— [sajster@hutterarchitects.com](mailto:sajster@hutterarchitects.com)

