

**CITY OF CHICAGO  
DEPARTMENT OF PROCUREMENT SERVICES  
ROOM 403, CITY HALL, 121 N. LASALLE ST.**

**JUSTIFICATION FOR NON-COMPETITIVE PROCUREMENT**

**COMPLETE THIS SECTION IF NEW CONTRACT, TERM AGREEMENT OR PURCHASE ORDER**

For contract(s) or purchase order, answer applicable questions in each of the 4 major subject areas below in accordance with the Instructions for Preparation of Non-Competitive Procurement Form on the reverse side.

Request that negotiations be conducted only with Duncan Parking Tech for the product and/or services described herein.  
Name of Person or Firm

This is a request for: \_\_\_ (One-Time Contractor P.O. per Requisition # \_\_\_\_\_, copy attached) or  Term Agreement or \_\_\_ Delegate Agency (Check one). If Delegate Agency, this request is for "blanket approval" of all contracts within the \_\_\_\_\_ (Attach List) Pre-Assigned Specification No. \_\_\_\_\_ (Program. Name) Pre-Assigned Contract No. \_\_\_\_\_

**COMPLETE THIS SECTION IF AMENDMENT OR MODIFICATION TO CONTRACT**

Describe in detail the change in terms of dollars, time period, scope of services, etc., its relationship to the original contract and the specific reasons for the change. Indicate both the original and the adjusted contract amount and/or expiration date with this change, as applicable. Attach copy of all supporting documents. Request approval for a contract amendment or modification to the following:

Contract #: \_\_\_\_\_ Company or Agency Name: \_\_\_\_\_

Specification #: \_\_\_\_\_ Contract or Program Description: \_\_\_\_\_  
Mod #: \_\_\_\_\_ (Attach List, if multiple)

<u>Merk Galvan</u>	<u>747-2254</u>	<u>Mark Galvan</u>	<u>Revenue</u>	<u>4/29/24</u>
Originator Name	Telephone	Signature	Department	Date

Indicate SEE ATTACHED in each box below if additional space needed:

<input type="checkbox"/> PROCUREMENT HISTORY
<input type="checkbox"/> ESTIMATED COST
<input type="checkbox"/> SCHEDULE REQUIREMENTS
<input type="checkbox"/> EXCLUSIVE OR UNIQUE CAPABILITY
<input type="checkbox"/> OTHER

APPROVED BY: [Signature] DATE \_\_\_\_\_ BOARD CHAIRPERSON \_\_\_\_\_ DATE \_\_\_\_\_  
DEPARTMENT HEAD OR DESIGNEE

**PARKING METER REPLACEMENT PARTS  
DUNCAN PARKING TECHNOLOGIES, INC.  
Sole Source Justification for Non-Competitive Procurement**

**Procurement History**

The Department of Revenue is requesting a sole source contract for parking meters, parts and supplies be awarded to Duncan Parking Technologies, Inc.

Duncan Parking Technologies parking meters have been used throughout Chicago for more than 30 years. Of the 29,000 parking meters, 20,000 meters have Duncan meter housings and 11,000 meters have Duncan mechanisms. Until approximately 12 years ago they were the main supplier of parking meters in North America.

In 1999, a sole source contract (T9-55038-04-02, FMPS # T25933) was awarded to Duncan for parking meter parts and supplies to support existing equipment. The final contract extension expires June 30, 2004.

In addition to the need for routine maintenance of newer Duncan equipment downtown, there are still approximately 10,000 Duncan meter housings and 7,800 Duncan mechanisms on the street in outlying areas that are between 20 and 30 years old and in need of frequent repair.

**Estimated Cost**

\$3,000,000 (\$1,000,000 for each year of the contract)

Eagle 2000 mechanism with card reader		
Estimated quantity over 3 yr. period - 10,000	\$174.95 ea.	\$1,749,500
Parts from 2004 catalog		
Estimated quantity over 3 yr. period - 125,000		\$1,250,500

The cost is based on current catalog pricing and projected departmental needs over the next three years. During the last year we attempted to purchase approximately \$700,000 worth of parts, which was the minimum amount necessary to cover general maintenance. A combination of budgetary constraints and the fact that the previous parts contract was underestimated restricted the purchase of necessary equipment. The dollar amount is expected to be significantly higher in the next few years with the increasing need to upgrade old equipment.

**Schedule Requirements**

Immediate in order to support the repair and upgrade of an aging meter system.

**Exclusive or Unique Capability**

The original design, tooling and manufacture of the equipment is proprietary to Duncan, therefore, it would not be possible to consider another source for the parts.

**Other**

The City's MBE/WBE program has been discussed with the proposed Contractor. They are requesting a "No Stated Goals" waiver (see attached request memo).



City of Chicago  
Richard M. Daley, Mayor

Department of Revenue

Bea Reyna-Hickey  
Director

City Hall, Room 107  
121 North LaSalle Street  
Chicago, Illinois 60602  
(312) 747-4747 (IRIS)  
(312) 744-0471 (FAX)  
(312) 744-2975 (TTY)

<http://www.ci.chi.il.us>

July 22, 2004

Mr. Eric Griggs  
Chief Procurement Officer  
Department of Procurement Services  
121 North LaSalle Street, Room 403  
Chicago, IL. 60602

**SUBJECT: No Stated Goals Request  
Duncan Parking Technologies**

Dear Mr. Griggs:

The Department of Revenue is requesting "No Stated Goals" waiver for Duncan Parking Technologies, provider of parking meter supplies and parts. Duncan is located in Harrison, AR, where they manufacturer the products. They ship directly to us via common carrier at a discounted price. There are no MBE/WBE vendors certified by the City who provide common carrier service from Harrison, AR.

If you have any questions concerning this request, please contact Mark Galvan, Fiscal Administrator, at 747-2254.

Very truly yours,

A handwritten signature in black ink, appearing to read "Bea Reyna-Hickey".

Bea Reyna-Hickey  
Director

Attachment

BRH:meg





## DUNCAN PARKING TECHNOLOGIES, INC.

P.O. Box 849 • 340 Industrial Park Rd. • Harrison, Arkansas 72601  
Phone: (870) 741-5481 Fax: (870) 741-2868  
WWW.DUNCANPARKING.COM

April 12, 2004

APR 16 2004  
CHICAGO DEPT. OF REVENUE

Ms. Bea Reyna-Hickey, Director  
Department of Revenue  
City of Chicago  
121 North La Salle  
Chicago, IL 60602

### Exemption Request: MBE/WBE Requirements

Dear Ms. Hickey:

Please accept this letter of request for exemption from the MBE/WBE guidelines for the renewal of our contract to supply parking meters and related parts for the City of Chicago.

Duncan Parking Technologies is located in Harrison, AR. The products we produce for the City are manufactured by Duncan and shipped directly to the City via common carrier at a discounted price.

One opportunity we would have to contract to a MBE/WBE company would be for transportation services, however, there are no MBE/WBE companies certified by the City of Chicago who provide LTL service from Harrison, AR. Additionally, subcontracting to a Chicago certified MBE/WBE would substantially increase Duncan's product price to the City. Therefore, we respectfully request this exemption.

Please contact us if you have any questions.

Sincerely,

Debbie Henry  
Director of Finance and Administration

DH/sm

## DETAILED SPECIFICATIONS

### Scope of Service

The Contractor shall furnish and deliver F.O.B., City of Chicago, Department of Revenue, parking meters, mechanisms, housings and parts, per Vendor's quote dated April 2, 2004.



**Duncan**  
**Parking Technologies, Inc.**

340 Industrial Park Road  
P.O. Box 849  
Harrison, AR 72601

Telephone: 870-741-5481  
Toll Free: 800-338-6226  
Fax: 870-741-2868  
Email: [duncan@duncanparking.com](mailto:duncan@duncanparking.com)  
Web Site: [www.duncanparking.com](http://www.duncanparking.com)

---

April 2, 2004

Mr. Tom Stevens, Parking Manager  
City of Chicago  
Department of Revenue  
2735 North Ashland  
Chicago, IL 60614

Dear Mr. Stevens:

Duncan Parking Technologies looks forward to entering into a contract with the City of Chicago to provide parking meter housings, mechanisms, and replacement parts. We have a relationship with the City that dates back several decades and have been pleased to provide equipment during that time period that has been implemented in your successful parking operation.

We have enclosed brochures for our products, pricing for Model 95S housings, the new Model 2000 Housing, Eagle 2000+ mechanism, and spare parts for each. For all parking related items not listed on Attachment A or itemized in the enclosed spare parts listings, we offer a 7.5% discount off the published price.

Duncan Parking Technologies is based in Harrison, Arkansas. We offer our products on a factory direct basis to the City of Chicago and do not have any dealers or distributors through which we offer our products in your area.

For small parts orders we use Fed X Ground or UPS and large shipments will be shipped using LTL common carrier.

If you have any questions, please do not hesitate to contact us.

Sincerely,



David A. Dull  
President/CEO

## ATTACHMENT A

### Duncan Parking Technologies

#### Housings, Mechanisms, Locks, Keys:

##### Housings:

##### Model 95S housing with KABA upper housing lock:

No door lock, no coin box \$269.22

##### Options – Add:

Sealed Coin Box Installed \$ 16.50

ABLOY Door Lock Installed \$ 15.92

##### Model 2000 housing with KABA upper housing lock:

No door lock, no coin box \$299.00

##### Options – Add:

Sealed Coin Box Installed \$ 16.50

ABLOY Door Lock Installed \$ 15.92

##### Mechanisms:

Eagle 2000+ with card reader \$174.95

##### Locks/Keys:

KABA Upper Housing Lock \$16.25

KABA UPPER HOUSING KEY \$10.28

ABLOY DOOR LOCK \$16.50

ABLOY KEY \$ 4.00



**DUNCAN INDUSTRIES**  
**PARKING METER HOUSING**  
**MODEL 95 SINGLE AND DUPLEX**

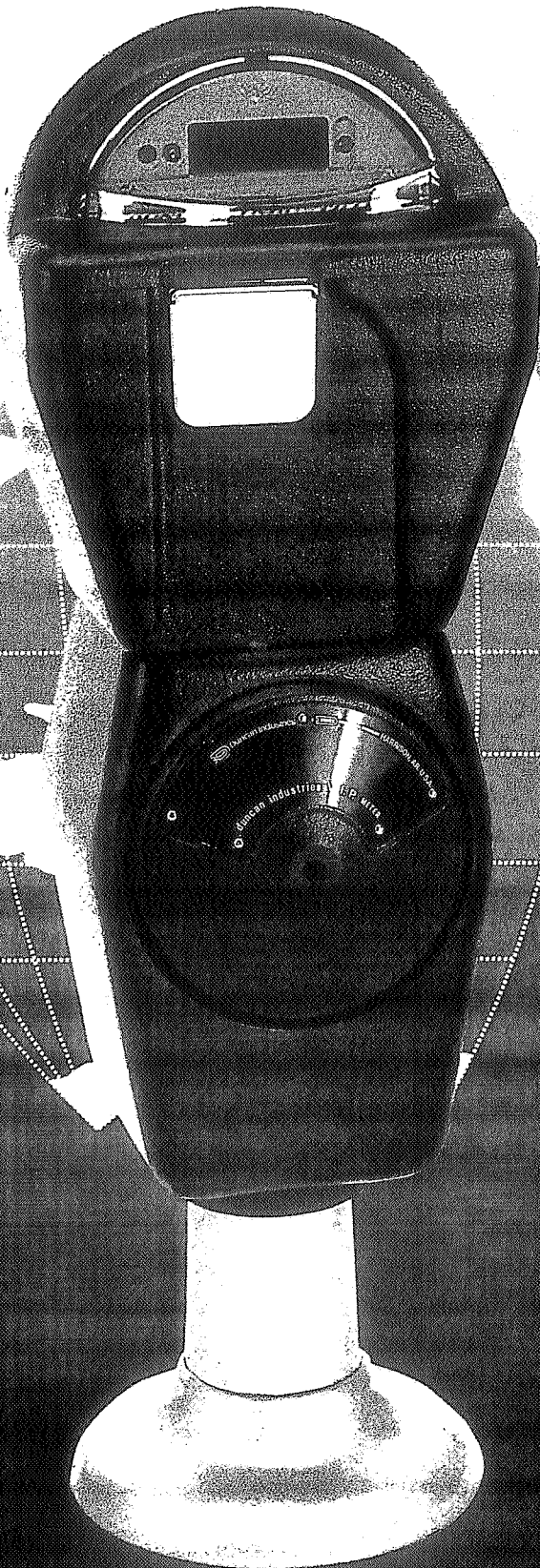

340 Industrial Park Road  
P.O. Box 849  
Harrison, Arkansas 72601

**DUNCAN PARKING TECHNOLOGIES  
MODEL 95 SINGLE PARKING METER HOUSING  
CITY OF CHICAGO EFFECTIVE JULY 1, 2004**

<u>REF NO.</u>	<u>PART NUMBER</u>	<u>DESCRIPTION</u>	<u>UNIT PRICE</u>
S1	79016	** HOUSING CAP ASSEMBLY	60.00
		replacement parts include:	
S2		9016-2 **HOUSING CAP	38.70
S3		8125 DOME	2.14
S4		9018 DOME GASKET	1.06
S5		79019 **DOME RETAINER	7.17
S6		1037-5 TORX TAPTITE F.H.SCREW (4 REQUIRED)	0.09 *
S6		1038-1 TORX HEAD SCREW, FH, SCREW (4 REQUIRED)	0.07 *
S6		1907-1 MACHINE SCREW, PFH, 1/2" (4 REQUIRED)	0.07 *
S1	79016-4	** HOUSING CAP ASSEMBLY WITH ANTI-GLARE DOME	60.00
		includes: (other parts same as 79016)	
S3		2041-4 ANTI-GLARE DOME	2.43
S7	9017-6	** UPPER HOUSING	57.00
S8	9040-5	** ML 95 SGL. LWR. HOUSING	73.00
S9	9025-9	HEX SOCKET BOLT (4 REQUIRED)	0.18
S48	1011-1	LOCK WASHER, 5/16 (4 REQUIRED)	0.05 *
S10	1705	SERIAL NUMBER PLATE (SPECIFY NUMBER)	0.72
S11	1918	DRIVE SCREW	0.06 *
		(2 REQUIRED FOR SERIAL PLATE; 5 REQUIRED FOR INSTRUCTION PLATE)	
S12	79001-1	LOCKING ROD ASSEMBLY (SPECIFY COMBINATION)	29.00
		replacement parts include:	
S13		9020 LOCKING ROD	15.00
S14		9023-1 LOCK BARREL	4.20
S15		9024 LOCK RETAINING PIN	0.07 *
S16		75030 DE PLUG ASSEMBLY	7.60
S17	3381-1	LOCK PLUG ASSEMBLY	0.17 *
S18	3327	LOCK PLUG SHIELD	0.15 *
S19	9022	PRIMARY LOCK PLUG SHIELD	3.12
S20	9027-1	SET SCREW	0.47
S49	9095	LOCKING BAR SHIELD	2.00
S21	62058-4	VIP KEY WITH HOLDER (SPECIFY COMBINATION)	14.00
S22	63035	FASTENER ASSEMBLY	8.00
		replacement parts include:	
S23		3048 BOLT	0.85
S24		9003 FASTENER WASHER	0.57
S25		3005 EXPANDER NUT	3.00
S26		H715-1 EXPANDER JAW (3 REQUIRED)	0.50
S27		H717-2 EXPANDER BAND	0.12 *
S50	1348	CONTAINER - 90/95 - OPEN	12.50
S28	69208	SEALED COIN BOX (SPECIFY COMBINATION)	18.50
S29	2302-2	SEALED COIN BOX RECEPTACLE KEY, STEEL (SPECIFY COMBINATION)	16.50
S28	69208-2	SEALED COIN BOX - L SERIES (SPECIFY COMBINATION)	21.70
S29	2302	SEALED COIN BOX RECEPTACLE KEY - L SERIES (SPECIFY COMBINATION)	5.50

**DUNCAN PARKING TECHNOLOGIES  
MODEL 95 SINGLE PARKING METER HOUSING  
CITY OF CHICAGO EFFECTIVE JULY 1, 2004**

<u>REF NO.</u>	<u>PART NUMBER</u>	<u>DESCRIPTION</u>	<u>UNIT PRICE</u>
S30	73378-226 **	DOOR ASSEMBLY replacement parts include:	39.92
S31		73345-10 **VIP DOOR SUB - ASSEMBLY WIPH	14.98
S32		3308 RUBBER BUMPER	0.57
S33		3331-2 SCREW, 10-32 X 1/2 SCHS (5 REQUIRED)	0.10
S34		3381 LOCK PLUG SHIELD	0.20
S35		3317-Z1 LOCK BARREL	3.30
S36		63325 DE LOCK ASSEMBLY S.W. (SPECIFY COMBINATION)	7.55
S37		3378 LOCK RETAINER	0.30
S38		73372 DOOR LINK & BRACKET ASSEMBLY	6.77
S39		73341 LOCK BOLT ASSEMBLY (2 REQUIRED)	1.13
S40		3326-1 LOCK BOLT RETAINER BRACKET	0.59
S41		3302 LOCK CAM	0.28
S42		3329 LOCK WASHER	0.08 *
S43		2016 NUT	0.08 *
S44	3349	INSTRUCTION PLATE	1.02
S45	73373	COIN BOX RETAINER ASSEMBLY	5.01
S46	73371-1	HSG. BRACKET ASSEMBLY (LEFT)	2.98
S47	73371-2	HSG. BRACKET ASSEMBLY (RIGHT)	3.55
S33	3331-2	SCREW, 10-32 X 1/2 SCHS(4 REQUIRED)	0.10 *
<b>FOR METERS MANUFACTURED WITH DUNCAN CHANGE LOCK:</b>			
	74444	CHANGE LOCK ASSEMBLY (SPECIFY COMBINATION) replacement parts include:	30.00
		74435-2 CHANGE LOCK PLUG ASSEMBLY (SPECIFY COMBINATION)	30.00
		3302-1 CAM	0.32
		4444 NUT	0.10 *
	74451-1	STEEL KEY W/ HOLDER	29.25
	T 74452-1	RESET TOOL KEY ASSEMBLY (X) - STEEL	30.00
	T 74453-1	RESET TOOL KEY ASSEMBLY (Y) - STEEL	30.00
	T 74452-2	RESET TOOL KEY ASSEMBLY (Z) - STEEL	30.00
	4451	STEEL CHANGE LOCK KEY	12.09
	4452-1	RESET KEY BLADE (X) - STEEL	15.64
	4453	RESET KEY BLADE (Y) - STEEL	15.64
	4452-2	RESET KEY BLADE (Z) - STEEL	15.64
	74451-C	CHANGE LOCK KEY W/ HOLDER	13.65
	T 74452-1C	RESET TOOL KEY ASSEMBLY (X) - BRASS	18.70
	T 74453-C	RESET TOOL KEY ASSEMBLY (Y) - BRASS	18.70
	T 74452-2C	RESET TOOL KEY ASSEMBLY (Z) - BRASS	18.70
<b>FOR METERS MANUFACTURED WITH LORI LOCK (SPECIFY COMBINATION):</b>			
	69110	LORI LOCK ASSEMBLY	18.50
	9111	LORI KEY	12.00
<b>RECOMMENDED TOOLS:</b>			
	ST9025	HANDLE - T- ALLEN KEY SET(FOR 9025-9 SCREW)	18.57
	ST3366-T1	ALLEN KEY W/ HANDLE	7.79
	ST3379-T1	LOCK RETAINER WRENCH	2.48
	ST4242-T	WRENCH - ALLEN 1/8"	0.22
	ST9022	EXTRACTOR TOOL FOR 9022	12.50

DUNCAN PARKING TECHNOLOGIES  
340 INDUSTRIAL PARK ROAD  
P. O. BOX 849  
HARRISON, ARKANSAS 72601

PHONE 870-741-5481  
800-338-6226  
FAX 870-741-6806  
870-741-2868

EMAIL [duncan@duncanparking.com](mailto:duncan@duncanparking.com)

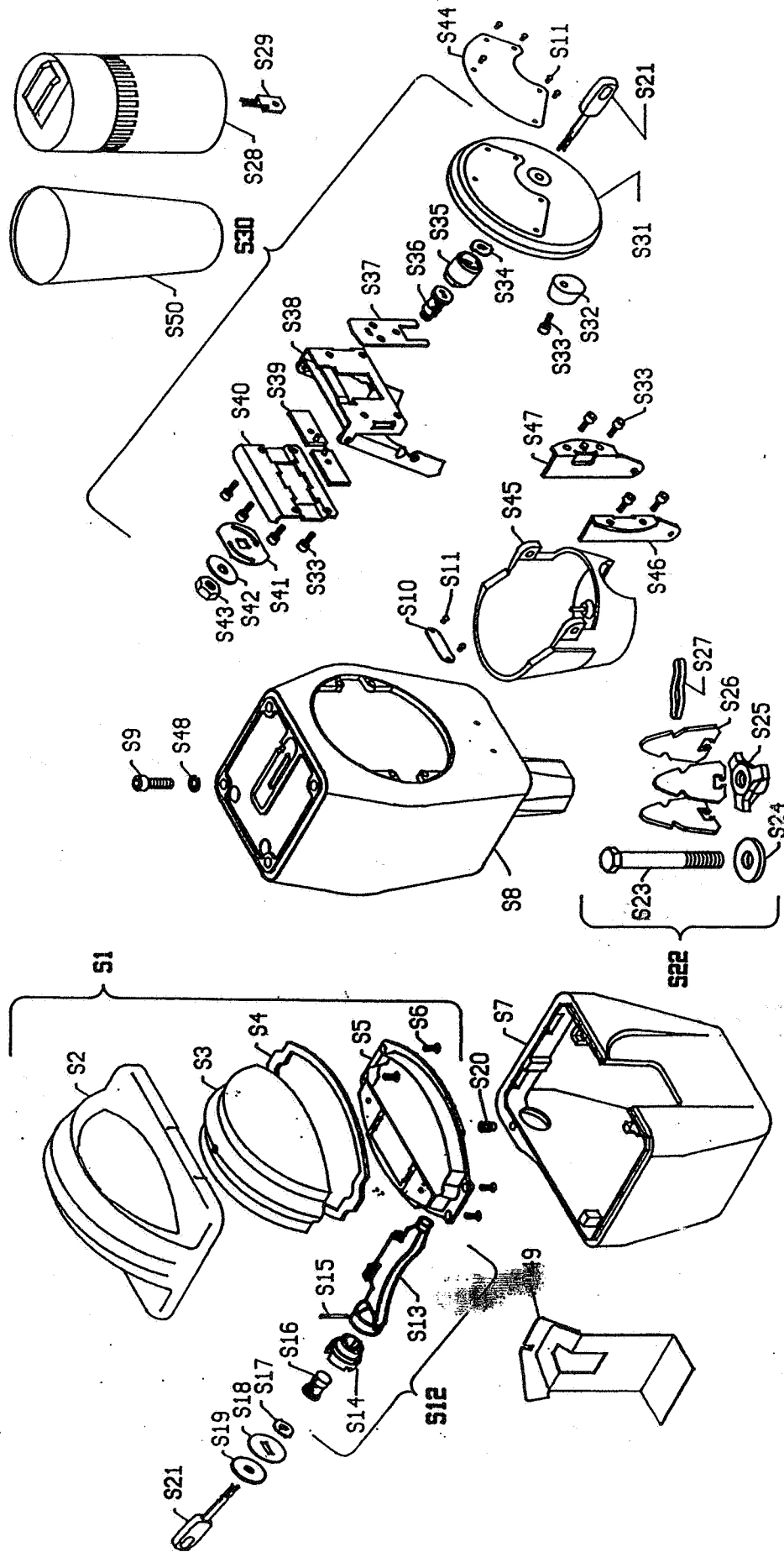

**PARTS LIST "S" MODEL "95" SINGLE PARKING METER HOUSING**



# PARKING CONTROL SYSTEMS

Our Commitment... "Quality Parking Products and Customer Satisfaction"

## The Model 2000 Housing

The Model 2000 iron housing offers a new tapered design which not only gives the unit a new 21st century look but indeed a new security anchoring method which will eliminate any concerns about the theft or vandalism of the City's new equipment and the revenue contained within.

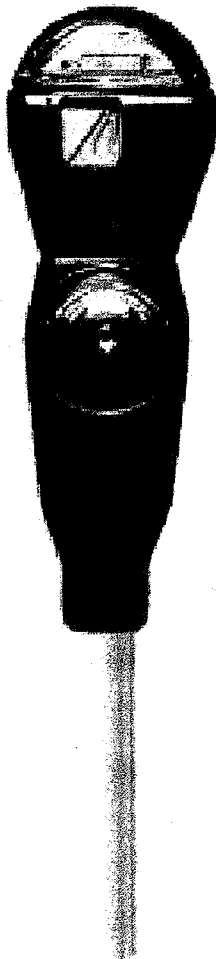

Model 2000 High Security Mount

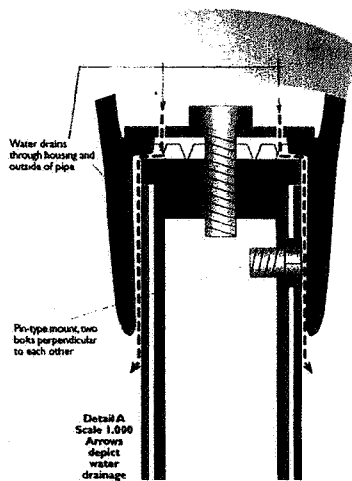

- ◆ The open bottom design ensures that water drains away from the post
- ◆ Eliminates standing water in the post and housing assembly
- ◆ Drainage system does not permit tampering with the door lock
- ◆ Compatible with all Duncan electronic and mechanical mechanisms
- ◆ Ductile iron upper housing with high impact damage resistant domes and high security internal locking mechanism

- ◆ The lower housing has an access hole cast into the upper mounting plate to allow for door removal without the need for drilling out the door.
- ◆ The upper housing may be removed and the access hole creates a path to pull out the door lock retainer, thus opening the door.

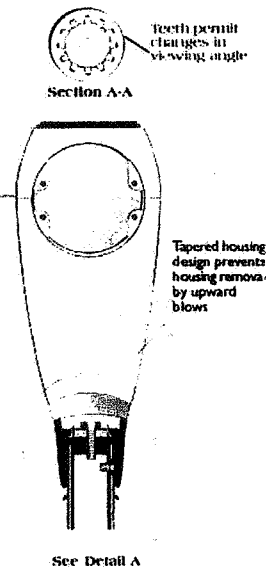

visit our website... [www.duncanindustries.com](http://www.duncanindustries.com)

Duncan Parking Control Systems  
 340 Industrial Park Road  
 P.O. Box 849  
 Harrison, Arkansas 72601

Call Toll Free: 800-338-6226  
 Phone: 870-741-5481  
 Fax: 870-741-2868  
 Email: [duncan@duncanindustries.com](mailto:duncan@duncanindustries.com)

**DUNCAN PARKING TECHNOLOGIES  
MODEL 2000 SINGLE PARKING METER HOUSING  
CITY OF CHICAGO EFFECTIVE JULY 1, 2004**

<u>REF. NO.</u>	<u>PART NUMBER</u>	<u>DESCRIPTION</u>	<u>UNIT PRICE</u>
M1	9041-1	MODEL 2000 LOWER HOUSING	80.22
M2	9042-1	MOUNTING HUB	5.09
M3	1003-12	RETAINING PIN	0.70
M4	1005-15	MOUNTING WASHER	1.22
M5	4295-3	MOUNTING BOLT	0.42
M6	73373	COIN BOX RETAINER ASSEMBLY	5.01
M7	73371-1	DOOR BRACKET ASSEMBLY LEFT	2.98
M8	73371-2	DOOR BRACKET ASSEMBLY RIGHT	3.55
M9	1053-2	#10-32 HEX CAP SCREW (9 REQ'D)	0.09
M10	73378**	VIP DOOR ASSEMBLY (MUST SPECIFY TYPE OF LOCK)	
M11	3344-**	VIP DOOR	
M12	3308	BUMPER	0.57
M13	PCB	ELECTRONIC LOCK ONLY	
M14	LOCK	SPECIFY BRAND AND COMBINATION	
M15	3378	LOCK RETAINER	0.30
M16	73372-**	DOOR LINK & BRACKET ASSEMBLY (SPECIFY ELECTRONIC OR MECHANICAL LOCK)	6.77
M17	73341	LOCK BOLT ASSEMBLY (2 REQ'D)	1.13
M18	3326-**	LOCK BOLT RETAINER BRACKET (SPECIFY LOCK ELECTRONIC OR MECHANICAL LOCK)	
M19	3302-**	LOCK CAM (SPECIFY LOCK BRAND)	0.28
M20	79016	HOUSING CAP ASSEMBLY	60.00
	79016-4	HOUSING CAP ASSEMBLY WITH ANTIGLARE DOME	60.00
M21	9016-1	HOUSING CAP	36.20
M22	8125**	DOME	2.14
	2041-4	ANTI-GLARE DOME	2.43
M23	9018	GASKET	1.06
M24	79019	DOME RETAINER	7.17
M25	1046-30	SCREW	0.11
M26	9017-**	DUCTILE IRON UPPER HOUSING	
M27	9027-1	SET SCREW	0.47
M28	9025-9	5/16-24 SOCKET HEAD CAP SCREW	0.18
M29	79001-1**	MECHANISM HOUSING LOCK ASSEMBLY (SPECIFY LOCK BRAND AND COMBINATION)	29.00
M30	9020	LOCKING ROD	15.00
M31	9024	LOCK RETAINING PIN	0.07
M32	9023	LOCK BARREL	8.00
M33	LOCK	SPECIFY BRAND AND COMBINATION	
M34	3381-1	LOCK PLUG SHIELD (NOT USED WITH ALL LOCKS - SPECIFY LOCK BRAND)	0.17
M35	3327	SECONDARY LOCK SHIELD (NOT USED WITH ALL LOCKS - SPECIFY LOCK BRAND)	0.15

**DUNCAN PARKING TECHNOLOGIES  
MODEL 2000 SINGLE PARKING METER HOUSING  
CITY OF CHICAGO EFFECTIVE JULY 1, 2004**

<b>M36</b>	<b>9022</b>	<b>PRIMARY LOCK SHIELD (NOT USED WITH ALL LOCKS - SPECIFY LOCK BRAND)</b>	<b>3.12</b>
<b>M37</b>	<b>3350</b>	<b>INSTRUCTION PLATE</b>	<b>1.25</b>
<b>M38</b>	<b>1705</b>	<b>SERIAL NUMBER PLATE</b>	<b>0.72</b>
<b>M39</b>	<b>1918</b>	<b>DRIVE PIN</b>	<b>0.06</b>

**DUNCAN PARKING TECHNOLOGIES  
340 INDUSTRIAL PARK ROAD  
P.O. BOX 849  
HARRISON. ARKANSAS 72601**

**TELEPHONE**      **870-741-5481**  
                         **800-338-6226**  
**FAX**                **870-741-6806**  
                         **870-741-2868**  
**EMAIL**            **duncan@duncanparking.com**

DUNCAN INDUSTRIES  
 MODEL 2000 SINGLE SPACE  
 PARKING METER HOUSING  
 PARTS LIST

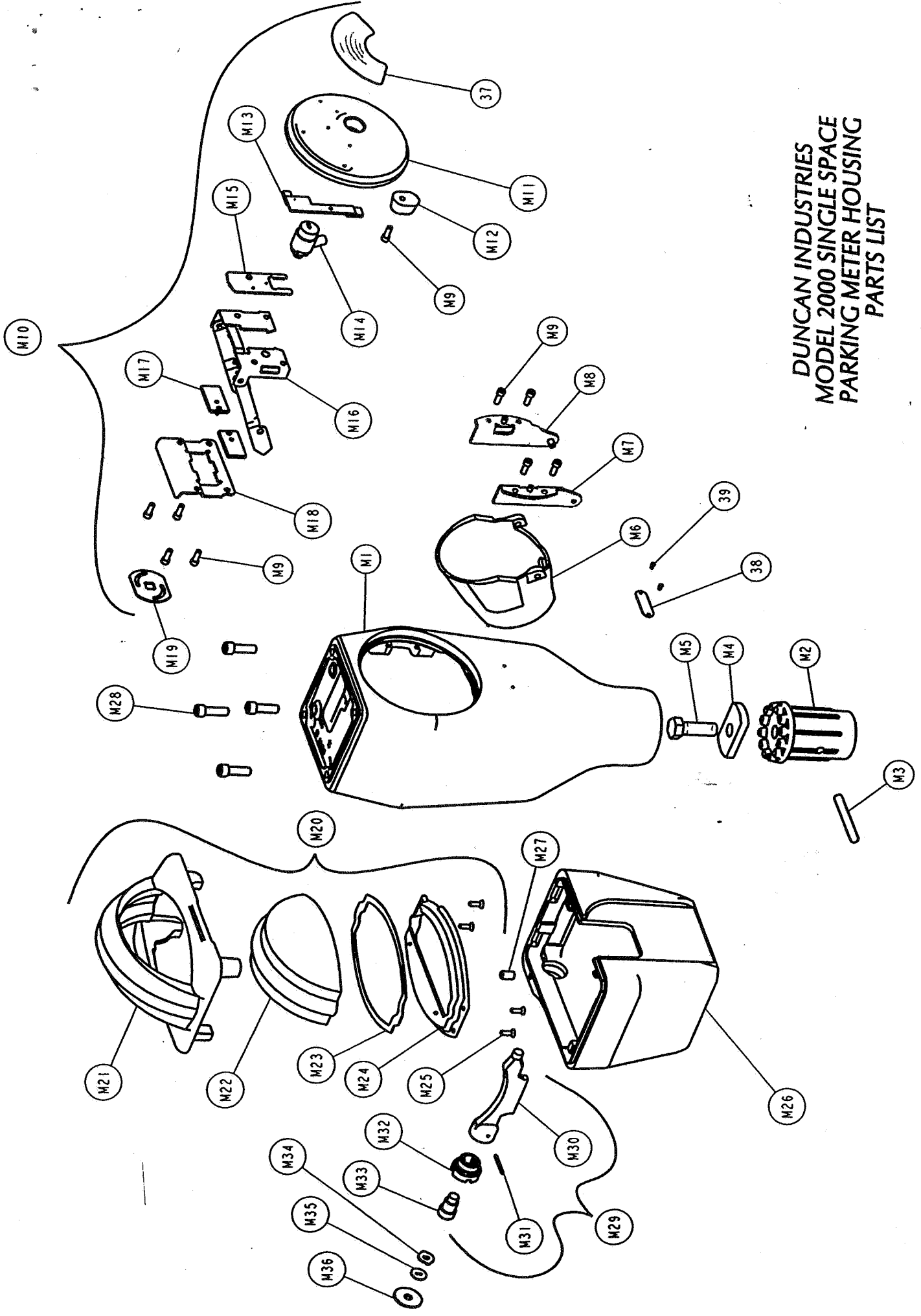



# Eagle 2000™ Meter Mechanism

Duncan's Eagle 2000 is often referred to as a PC on a post—and for good reason. It features a patented operating system and a patented peripheral port that enable the mechanism to run powerful new management applications, as well as future add-on devices. The Eagle 2000 automatically serves data with every infrared Duncan Data Terminal (DDT) interface

(e.g., Collections, Maintenance, and Enforcement). Data such as audit, maintenance status, battery condition, self-diagnostics events, and location are also readily obtainable. The Eagle 2000 also facilitates the generation of parking reports for management analysis when used as a component of Duncan Systems Integrated™. This secures and optimizes revenue, while maximizing meter operability.

Built for the future, the Eagle 2000 boasts an impressive heritage as well. It's part of the Eagle Series™ of electronic mechanisms responsible for setting a new industry standard in terms of meter reliability and performance.

The Eagle 2000 includes all of the features of the Eagle™ and Eagle CR™, as well as the following new system attributes.

- Patented peripheral port offers more upgradability than any other electronic mechanism and faster on-line communications
- Patented operating system architecture designed to accommodate upgrade flexibility with future parking applications
- Accommodates ISO-7816-compatible debit payment systems, including the Duncan MeterCash™ microprocessor debit card, GPM416, GPM896, and other programmable card options
- Patented Duncan "Dual Coil/Dual Frequency" coin discrimination ensures in excess of 99.99% accuracy in coin recognition
- Three-square-inch rear violation LCD offers the industry's largest violation display for greater visibility and ease of enforcement
- Three LEDs for nighttime enforcement, displaying good time, expired time, and out of order conditions
- Extra-bright backlit LCD display
- Compatibility with new Duncan Talon 2000™ Electronic Cabinet system

*Operating system designed to accommodate future parking applications*

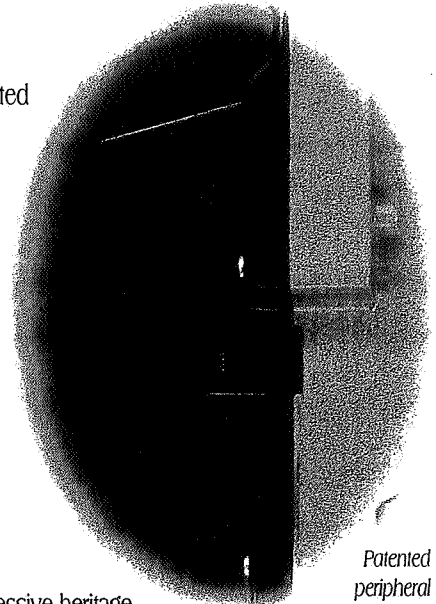

*Patented peripheral port offers upgradability*

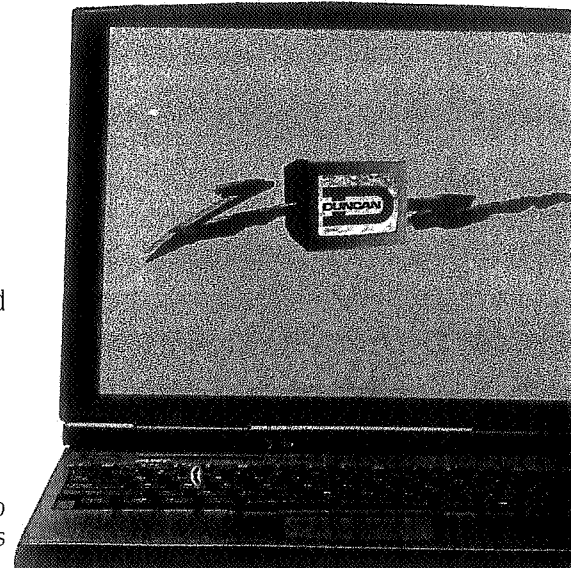
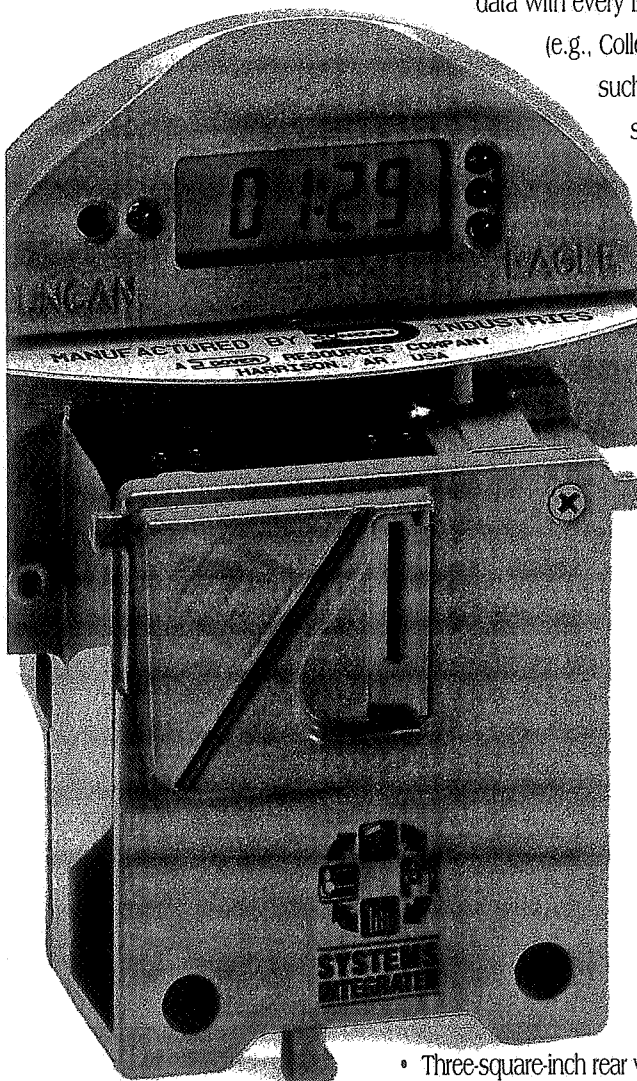

**DUNCAN PARKING TECHNOLOGIES  
DUNCAN EAGLE 2000 PLUS MECHANISM  
CITY OF CHICAGO EFFECTIVE JULY 1, 2004**

<u>REF. NO.</u>	<u>PART NO.</u>	<u>DESCRIPTION</u>	<u>LIST PRICE</u>
Y1	7705	Reset Button	\$0.43
Y2	7712	9 Volt Alkaline Battery	\$1.50
Y3	8160	Clean Out Cover	\$0.46
Y4	8161	Card Wiper	\$0.74
Y5	8164	Card Reader Plug	\$0.16
Y6	8172	Coin Track Shield	\$1.35
Y7	1030-1	#6-32 X 3/16 Truss Head Screw	\$0.06
Y8	1036-4	#4-40 Pan Head Self Tapping Screw	\$0.05
Y9	1903-5	#6-32 X 1/2 Pan Head Screw Type	\$0.06
Y10	1903-7	#6-32 X 5/8 Phillips Pan Head Screw	\$0.07
Y11	48058-1	Card Reader Assembly	\$18.50
Y12	58154-C5	Eagle 2000 Plus Standard Circuit Board	\$100.50
Y13	68153-2	Coin Track Assembly	\$28.37
Y14	7249-3	Battery Pad	\$0.14
Y15	7676-5	Insulating Spacer	\$0.04
Y16	8052-23	Peripheral Port Enabled Label	\$0.15
Y17	8150-1	Mech Frame Card/Coin	\$9.40
Y18	8151-1	Front Display Cover	\$8.50
Y19	8152-2	Rear Display Cover	\$9.50
Y20	8160-001	Battery Door	\$0.85
Y21	8163-101	Vandal Resistant Coin Slot	\$0.99
Y22	9067-1	Flat Countersunk Head Screw	\$0.08

DUNCAN PARKING  
340 INDUSTRIAL PARK ROAD  
P.O. BOX 849  
HARRISON, ARKANSAS 72601

TELEPHONE: 870-741-2868  
800-338-6226  
FAX: 870-741-6806  
870-741-2868

# EAGLE 2000+

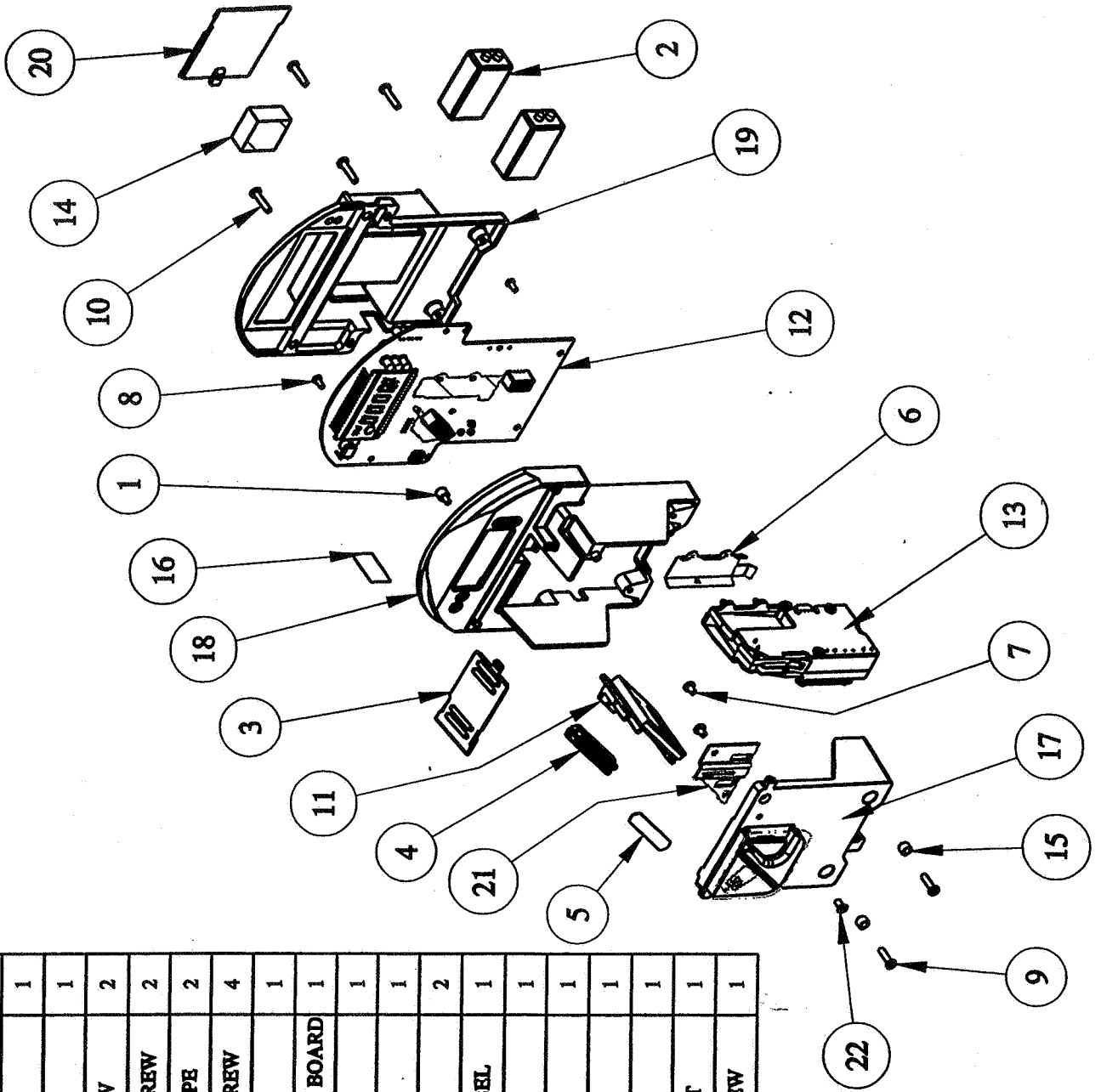

1	7705	RESET BUTTON	1
2	7712	9 VOLT ALKALINE BATTERY	2
3	8160	CLEAN OUT COVER	1
4	8161	CARD WIPER	1
* 5	8164	CARD READER PLUG	1
6	8172	COIN TRACK SHIELD	1
7	1030-1	#6-32 X 3/16 TRUSS HEAD SCREW	2
8	1036-4	#4-40 PAN HEAD SELF TAPPING SCREW	2
9	1903-5	#6-32 X 1/2 PAN HEAD SCREW TYPE	2
10	1903-7	#6-32 X 5/8 PHILLIPS PAN HEAD SCREW	4
11	48058-1	CARD READER ASSEMBLY	1
* 12	58154-C5	EAGLE 2000 PLUS STANDARD CIRCUIT BOARD	1
13	68153-2	COIN TRACK ASSEMBLY	1
14	7249-3	BATTERY PAD	1
15	7676-5	INSULATING SPACER	2
16	8052-23	PERIPHERAL PORT ENABLED LABEL	1
17	8150-1	MECH FRAME CARD/COIN	1
* 18	8151-1	FRONT DISPLAY COVER	1
* 19	8152-2	REAR DISPLAY COVER	1
20	8160-001	BATTERY DOOR	1
* 21	8163-101	VANDAL RESISTANT COIN SLOT	1
22	9067-1	FLAT COUNTERSUNK HEAD SCREW	1

NOTE: PARTS MARKED BY AN "\*" ARE EITHER INTERCHANGEABLE OR OPTIONAL. REFER TO SALES FOR SPECIFIC PART NUMBER.

# CITY OF CHICAGO ALL PURPOSE REQUISITION FORM

PAGE <u>1</u> OF <u>1</u>		DEPT USE 1			DEPT USE 2							
BUREAU/DIVISION <u>Street Ops.</u>		SHIP CODE <u>BSS</u>		SHIP TO: ATTN.: <u>Anthony Gambino</u>		DATE NEEDED <u>5/21/04</u>						
DATE <u>5/16/04</u>		SHIP CODE <u>BSS</u>		SHIP TO: ATTN.: <u>Anthony Gambino</u>		DATE NEEDED <u>5/21/04</u>						
LINE	FUND	COMMODITY CODE	SYS CODE	ITEM DESCRIPTION	CATALOG NAME/#	CATALOG DATE	CATALOG PAGE	CATALOG ITEM/PART #	UNIT PRICE	UNIT OF MEASURE	QUANTITY	TOTAL PRICE
		55098	54	Duncan Parking Meter Replacement						ea	125,000	
		5503864	497	Eagle of Mechanisms w/ Card Readers						ea	10,000	
COMMENTS: <u>New Contract Request - sole source Contract</u>												

CHECK OR COMPLETE ALL THAT APPLY	FY	LINE	FUND	DEPT	ORGN	APPR	ACTV	OBJT	PROJECT	RPTG	DOLLAR AMT.	PAGE TOTAL
	03		483	29	2005	3013		0440	43329111			
PARTICIPATING TA #												GRAND TOTAL (ALL PAGES)

SECTION MANAGER/ APRF PREPARED BY: M. Galvan

ADDRESS: 7/22/04 PHONE: 7-2254

DATE: 7/22/04 PHONE: 7-2254

DEPUTY AUTHORIZATION: [Signature] DATE: \_\_\_\_\_ PHONE: \_\_\_\_\_

BUREAU/DIVISION INFORMATION

INVOICE NUMBER(S)

VENDOR INFORMATION

COMPANY NAME: Duncan Parking Technology US

ADDRESS: P.O. Box 849

340 Industrial Park Rd

Harrison, AR. 72601

VENDOR CODE: \_\_\_\_\_ REP/PHONE: \_\_\_\_\_

**CITY OF CHICAGO  
 PURCHASE REQUISITION**

**Copy (Department)**

<b>DELIVER TO:</b>  B55 STREET OPERATIONS 2725-35 N. ASHLAND Chicago, IL	<b>REQUISITION:</b> 14016  <b>PAGE:</b> 1 <b>DEPARTMENT:</b> 29 - DEPARTMENT OF REVENUE <b>PREPARER:</b> Mark E Galvan <b>NEEDED:</b> 5/14/2004 <b>APPROVED:</b> 5/4/2004
---	---

**REQUISITION DESCRIPTION**

New contract request for Parking meter parts and supplies - Sole Source request  
 SPECIFICATION NUMBER: 24207

**COMMODITY INFORMATION**

LINE	ITEM	QUANTITY	UOM	UNIT COST	TOTAL COST							
1	55098.53	100,000.00	Each	0.00	0.00							
Mackay Parking Meter Replacement Parts - Discount from List												
<b>SUGGESTED VENDOR:</b> MACKAY METERS, INC.						<b>REQUESTED BY:</b> Mark E Galvan						
DIST	BFY	FUND	COST CTR	APPR	ACCNT	ACTV	PROJECT	RPT CAT	GENRL	FUTR	Dist. Amt.	
1	003	0433	0292005	3013	220440	0000	43329111	000000	00000	0000	0.00	
<b>LINE TOTAL:</b>											<b>0.00</b>	
<b>REQUISITION TOTAL:</b>											<b>0.00</b>	

# CPAC PROJECT CHECKLIST

For CPAC Team Use Only	
Date Received	_____
Date Returned	_____
Date Accepted	_____

**IMPORTANT:** PLEASE READ AND FOLLOW THE INSTRUCTIONS FOR COMPLETING THE PROJECT CHECKLIST AND CONTACT THE APPROPRIATE TEAM LEADER IF YOU HAVE ANY FURTHER QUESTIONS. ALL INFORMATION SHOULD BE COMPLETED INCLUDING THE SUPPLEMENTAL CHECKLIST REQUIRED BY THE SPECIFIC CPAC TEAM. ATTACH ALL REQUIRED MATERIALS AND SUBMIT FOR HANDLING TO THE DEPARTMENT OF PROCUREMENT SERVICES, ROOM 403, CITY HALL, 121 N. LASALLE STREET, CHICAGO, ILLINOIS 60602.

**PROJECT**  
**Date:** ~~March 22, 2004~~ July 22, 2004  
**ID No (Spec (RX) Project):** 14015  
**Department:** Revenue  
**Bureau:** Street Operations  
**Contract No (if known):** \_\_\_\_\_  
**Project Title/Description:** Parking meter parts and supplies - Duncan Parking Technologies

**Contact Person:** Mark Galvaz  
**Tel:** 773-2284 **Fax:** 773-7420 **E-mail:** Groupwise  
**Project Manager:** Anthony Gambino  
**Tel:** 773-6929 **Fax:** \_\_\_\_\_ **E-mail:** Groupwise  
**Estimated Value \$** \_\_\_\_\_

## SCOPE STATEMENT

attached is a detailed scope of services and/or specification

**IMPORTANT:** THIS IS A CRITICAL PORTION OF YOUR SUBMITTAL. IN ORDER FOR A TEAM TO ACCEPT YOUR SUBMITTAL YOU MUST COMPLETE ALL TEAM SPECIFIC SCOPE REQUIREMENTS AS SET FORTH IN THE SUPPLEMENTAL CHECKLIST FOR THAT TEAM.

The following is a general description of what would be included in a Scope of Services or Specification:  
 A clear description of all anticipated services and products, including: time frame for completion, special qualifications of prospective vendors, special requirements or needs of the project, locations, anticipated participating user departments, citation of any applicable City ordinance or state/federal regulation or statute.

## TYPE OF PROCUREMENT REQUESTED (check all that apply)

Competitive Bid     RFQ/RFP/RFS/RFI     Sole Source\*\*     Term Agreement     One Shot  
 Mod/Amendment     Time Extension     Additional Funding     Small Order     S/O Emergency

## FORMS

F-25\* (add line item)     F-10\* (special approvals)     SSRB\*\* (sole source approval)  
 F-26\* (new term agreement)     RX (one-shot requisition)     OBM Authorization  
 F-27\* (time extension)     APRF (all purpose request form)  
 F-29\* (change vendor limit)

\*\* Sole source requests must include vendor quotes/proposal and MBE/WBE compliance requirements

## FUNDING

**City:**  Corporate     Bond     Enterprise     Grant\*     Other Equipment Not  
**State:**  IDOT/Transit     IDOT/Highway     Grant\*     Other \_\_\_\_\_  
**Federal:**  FHWA     FTA     FAA     Grant\*     Other \_\_\_\_\_  
**Funding Strip(s):** 03-433-29-2005-3013-0440-43329111

\* Attach copy of any applicable grant agreement terms and conditions

## TIME FRAME

**Date Needed:** 6/30/04    **Requested Contract Term (y/m/d):** 3 years, w/ 3 one-year options

## PRE BID/SUBMITTAL REQUIREMENTS

Requesting Pre Bid/Submittal Conference?  Yes  No    Requesting Conference be Mandatory?  Yes  No  
 Requesting Site Visit?  Yes  No    Requesting Site Visit be Mandatory?  Yes  No

# CPAC PROJECT CHECKLIST

---

## ARCHITECTURAL/ENGINEERING SUPPLEMENTAL CHECKLIST

**Required Attachments:** Scope of Services, including location, description of project, services required, deliverables, and other information as required

### Risk Management

Will services be performed within 50 feet of CTA train or other railroad property?  Yes  No

Will services be performed on or near a waterway?  Yes  No

**Pre-Qualification Category No.** \_\_\_\_\_ **Category Description:** \_\_\_\_\_

For Pre-Qualification Program, attach list of suggested firms to be solicited

**Other Agency Concurrence Required:**  None  State  Federal  Other (fill in) \_\_\_\_\_

---

## AVIATION CONSTRUCTION SUPPLEMENTAL CHECKLIST

DOA sign-off for final design documents:  Yes  No

### Required Attachments:

Copy of Draft Contract Documents and Detailed Specifications.

### Risk Management:

Current Insurance Requirements prepared/approved by Risk Management: Yes  No

Will work be performed within 50 feet of CTA or ATS structure or property? Yes  No

Will work be performed airside? Yes  No

---

## CAPITAL EQUIPMENT (VEHICLES) SUPPLEMENTAL CHECKLIST

### Required Attachments:

Detailed Specifications including detailed description of the vehicle(s) or equipment, mounted equipment, if any, and options/accessories.

Special Provisions (Delivery, Warranty, Manuals, Training, Additional Unit Purchase Options, Bid Submittal Information, etc.)

Delivery Location(s)

Technical Literature

Drawings, if any

Part Number List (  Manufacturer; or  Dealer;  or Other Source: \_\_\_\_\_ )

Copy of current Price List(s)/Catalog(s)

Form F-10 or other authorization document

Any other exhibits and attachments

---

## COMMODITIES SUPPLEMENTAL CHECKLIST

### Required attachments:

Copies of price lists, catalogs, drawings, variations of part numbers

Any other exhibits or attachments

---

## CONSTRUCTION SUPPLEMENTAL CHECKLIST (LARGE & SMALL)

**Required attachments: Copy of Draft (80% Completion)**

Copy of Draft (80% Completion) Contract Documents and Detailed Specifications

### Risk Management

Will services be performed within 50 feet of CTA train or other railroad property?  Yes  No

Will services be performed on or near a waterway?  Yes  No

# CPAC PROJECT CHECKLIST

---

## DELEGATE AGENCY SUPPLEMENTAL CHECKLIST

### Required attachments:

Attach Scope of Services that includes the following information 1) Program background & objectives; 2) Type of services for which proposals are sought; 3) Location and time line for delivery of services; 4) Qualifications, skills, and/or experience necessary; 5) Special licenses or certifications required; 6) Evaluation process (if known).

### Other Attachments (please submit all that apply)

1. Copy of grant application and/or grant agreement
2. Evidence of award authority (DAAC agenda with agency name highlighted; City Council ordinance with agency name highlighted; or OBM letter)
3. Modification information (Copy of Form F-8A; screen print of EPS AWDS table)

Does program require Executive Order 91-1 clearance?  Yes  No  
Is boilerplate from Law available or in production?  Yes  No  
Would your department benefit from technical assistance?  Yes  No

---

## HARDWARE/SOFTWARE SUPPLEMENTAL CHECKLIST

ITSC (approved by BIS)

OBM (approved by Budget form/memo)

Attach any documentation indicating any previous purchase activity to assist in the procurement process

Grant document attached

---

## PROFESSIONAL SERVICES SUPPLEMENTAL CHECKLIST

Detailed scope of services as described on page 1.

The Schedule of Compensation

Deliverables

Request for individual contract services (if applicable)

The appropriate EPS form

**\* If this is a Telecommunications/Utilities project, please also address the following:**

Has the project been reviewed by DGS?  Yes  No

Attach copy of DGS Recommendation; Reservation(s); or participate under current contract.

Does the project include software?  Yes  No

If yes, is signed ITSC form attached?  Yes  No

Does the location involve:

A public way?  Yes  No

Any concession in the City's facilities?  Yes  No

Is it anticipated City Council approval of the project or contract will be required?  Yes  No



# CPAC PROJECT CHECKLIST

## SMALL ORDERS SUPPLEMENTAL CHECKLIST

Yes No

- \_\_\_ \_\_\_ 1. Special Approval Form/Justification Letter.  
e.g. (Emergency Contract, Telecommunication Back-up documents, Proposals , EPS Form F-10, etc.,).
- \_\_\_ \_\_\_ 2. Suggested Vendor.
- \_\_\_ \_\_\_ 3. Commodity Code, Manufacturer, Catalog Information, Model No., Quantity, Unit Cost/Measure, Color etc.,
- \_\_\_ \_\_\_ 4. Detailed Specification or Scope of Work.

## ATTACHMENT REQUIRED FOR EACH SMALL ORDERS PROCUREMENT TYPE

(Check Appropriate Group)

### 1. ONE SHOT (PN)

- YES ( ) NO ( ) Detailed Specifications  
 YES ( ) NO ( ) Suggested Vendor  
 YES ( ) NO ( ) Support Documentation

### 3. EMERGENCY CONTRACT

- YES ( ) NO ( ) Justification Letter  
 YES ( ) NO ( ) Vendor Proposal  
 YES ( ) NO ( ) Pre-assigned Requisition (RX)

### 2. SOLE SOURCE REQUIREMENTS

- YES ( ) NO ( ) Vendor Proposal  
 YES ( ) NO ( ) Disclosure Affidavit  
 YES ( ) NO ( ) Letter of Exclusive or Unique Capability  
 YES ( ) NO ( ) Support Documentation from Vendor/Manufacturer.  
 YES ( ) NO ( ) Signature(s) of Originator or Departmental Head/Designee.

### 4. TELEPHONE/FAX BIDS

- YES ( ) NO ( ) Justification Letter

## WORK SERVICES & FACILITY MAINTENANCE SUPPLEMENTAL CHECKLIST

**Required Attachments:** Detailed Specifications (Scope of Services) including detailed description of the work, locations (with supporting detail), user department contacts, work hours/days, laborer/supervisor mix, compensation and price escalation considerations, contract term and extension options, contractor qualifications, citation of any applicable City/State/Federal statutes or regulations, citation of any applicable technical standards and price lists, catalogs, technical drawings and other exhibits and attachments as appropriate.

### Risk Management

- Will services be performed within 50 feet of CTA train or other railroad property? \_\_\_Yes \_\_\_No
- Will services be performed on or near a waterway? \_\_\_Yes \_\_\_No
- Will services require the handling of hazardous/biowaste material? \_\_\_Yes \_\_\_No
- Will services require the blocking of streets or sidewalks in any way?  
Which may affect public safety? \_\_\_Yes \_\_\_No

**CITY OF CHICAGO  
 PURCHASE REQUISITION**

**Copy (Department)**

<b>DELIVER TO:</b>  B55 STREET OPERATIONS 2725-35 N. ASHLAND Chicago, IL	<b>REQUISITION:</b> 14015  <b>PAGE:</b> 1 <b>DEPARTMENT:</b> 29 - DEPARTMENT OF REVENUE <b>PREPARER:</b> Mark E Galvan <b>NEEDED:</b> 5/14/2004 <b>APPROVED:</b> 5/4/2004
---	---

**REQUISITION DESCRIPTION**

New contract request - Parking meters and parking meter supplies and parts - Sole Source request  
 SPECIFICATION NUMBER: 24202

**COMMODITY INFORMATION**

LINE	ITEM	QUANTITY	UOM	UNIT COST	TOTAL COST							
1	55098.54 Duncan Parking Meter Replacement Parts - Discounted from List	125,000.00	Each	0.00	0.00							
<b>SUGGESTED VENDOR:</b> DUNCAN PARKING TECHNOLOGIES		<b>REQUESTED BY:</b> Mark E Galvan										
DIST	BFY	FUND	COST CTR	APPR	ACCNT	ACTV	PROJECT	RPT CAT	GENRL	FUTR	Dist. Amt.	
1	003	0433	0292005	3013	220440	0000	43329111	000000	00000	0000	0.00	
<b>LINE TOTAL:</b>											<b>0.00</b>	
LINE	ITEM	QUANTITY	UOM	UNIT COST	TOTAL COST							
3	5503864497 PARTS, DUNCAN PARKING METER (DUNCAN OR EQUAL) - EAGLE CR MECHANISM (WITH CARD READER)	10,000.00	Each	0.00	0.00							
<b>SUGGESTED VENDOR:</b> DUNCAN PARKING TECHNOLOGIES		<b>REQUESTED BY:</b> Mark E Galvan										
DIST	BFY	FUND	COST CTR	APPR	ACCNT	ACTV	PROJECT	RPT CAT	GENRL	FUTR	Dist. Amt.	
1	003	0433	0292005	3013	220440	0000	43329111	000000	00000	0000	0.00	
<b>LINE TOTAL:</b>											<b>0.00</b>	
<b>REQUISITION TOTAL:</b>											<b>0.00</b>	